



Flat 5 Kings View, West End Road, High Wycombe, Buckinghamshire, HP11 2PQ

Asking Price | £1,150

Property Description

A one-bedroom first floor apartment which benefits from a private balcony, within a few minutes' walk to the town centre. The property comprises; security entrance; entrance hallway; modern kitchen with appliances; large living area with doors to the private balcony; double bedroom; bathroom. An internal viewing is recommended to appreciate the size of this property. Allocated parking to the rear. Available now on an unfurnished basis.

COUNCIL TAX B

EPC RATING C

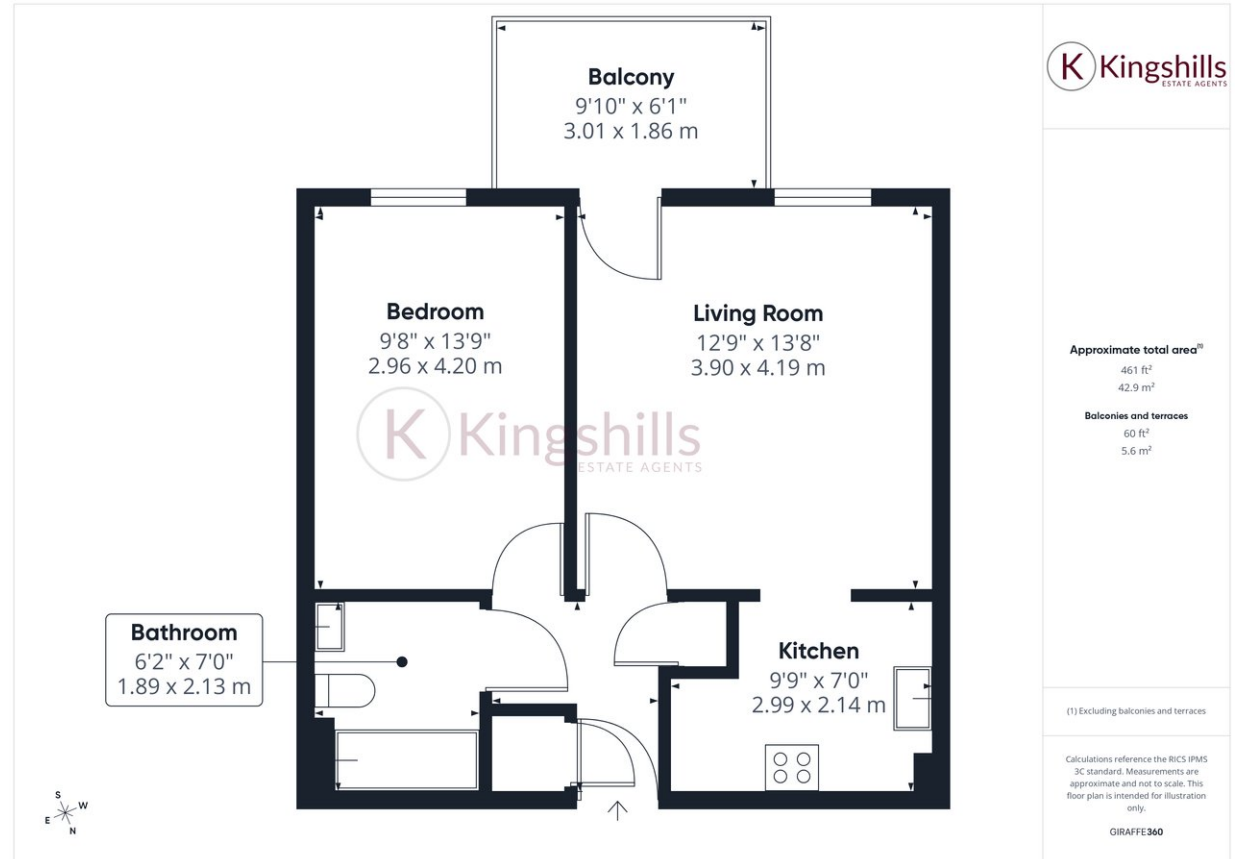

Kingshills Estate Agents
C1C Comet Studios
Amersham
Buckinghamshire
HP7 0PX

01494 939868
hello@kingshills.co.uk
kingshills.co.uk

Agents Note: Whilst every care has been taken to prepare these particulars, they are for guidance purposes only. All measurements are for general guidance purposes only and whilst every care has been taken to ensure accuracy, they should not be relied upon and potential buyers/tenants are advised to recheck the measurements