



3 Westover Court, High Wycombe, Buckinghamshire, HP13 5JE

Asking Price | £1,450

## Property Description

A modern two-bedroom maisonette, located in the highly sought-after village of Downley. This maisonette offers spacious and modern accommodation throughout and is available immediately. Internally, the accommodation comprises; private entrance; open plan kitchen/living room, with the kitchen offering a fridge freezer, washing machine and dishwasher, two double bedrooms with fitted storage and a bathroom. The property has been finished to a high specification and an internal viewing is highly recommended. Further benefits from gas heating and parking is available in the development.

COUNCIL TAX C

EPC RATING C

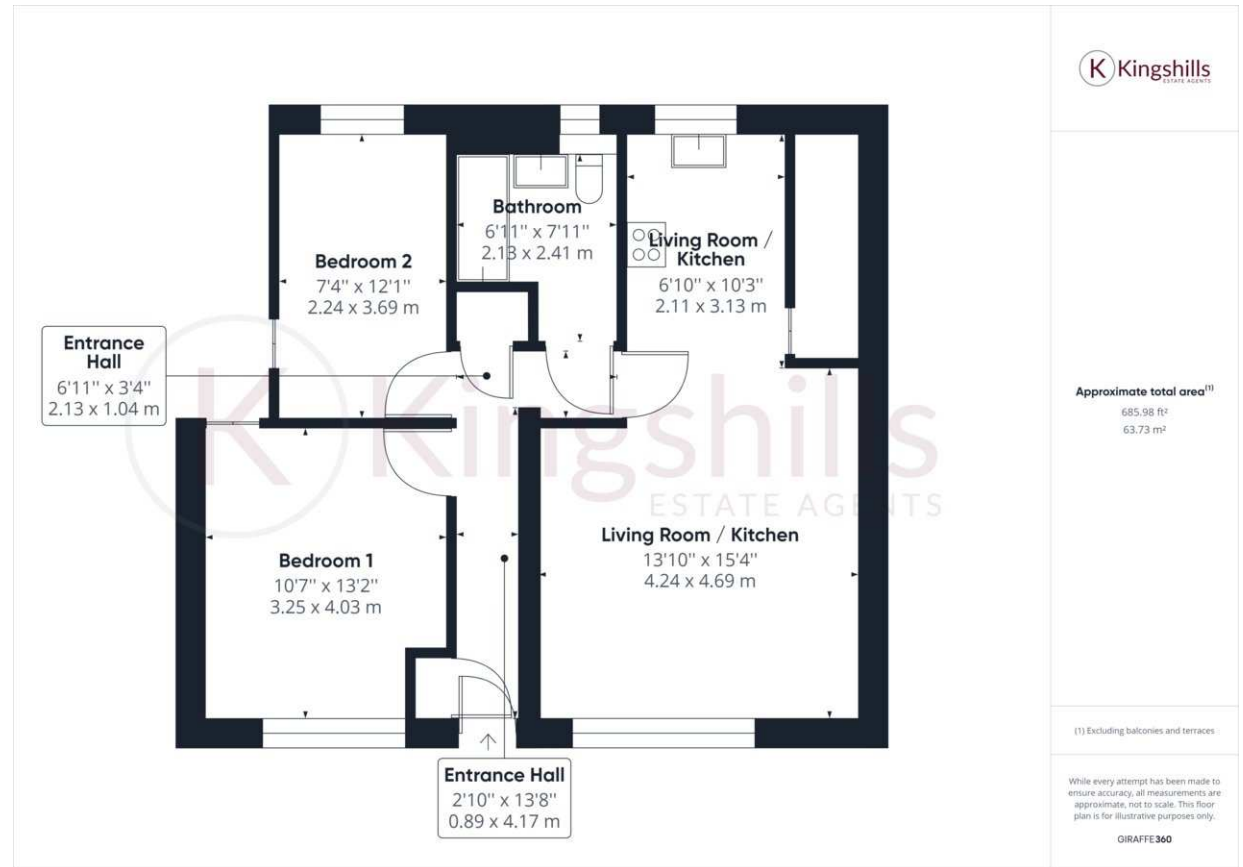

Kingshills Estate Agents  
C1C Comet Studios  
Amersham  
Buckinghamshire  
HP7 0PX

01494 939868  
hello@kingshills.co.uk  
kingshills.co.uk

Agents Note: Whilst every care has been taken to prepare these particulars, they are for guidance purposes only. All measurements are for general guidance purposes only and whilst every care has been taken to ensure accuracy, they should not be relied upon and potential buyers/tenants are advised to recheck the measurements