



Property Description

This modern, move-in-ready apartment is well presented throughout and offers comfortable, low-maintenance living in the heart of High Wycombe, making it an ideal choice for a range of buyers. The property is thoughtfully laid out and well suited to first-time buyers, professionals or those seeking a convenient town centre home.

The accommodation comprises a bright open-plan living and dining area with underfloor heating throughout and sliding doors leading out to a private balcony, which is also accessible from the bedroom. The generously sized double bedroom benefits from built-in storage, while the bathroom is well maintained with a neutral finish. A neatly presented and functional kitchen completes this appealing apartment.

Further benefits include lift access within the building, a secure gated car park and an allocated parking space.

Ideally located in High Wycombe town centre, the apartment is just a five-minute walk from High Wycombe train station, which offers regular and direct services to London

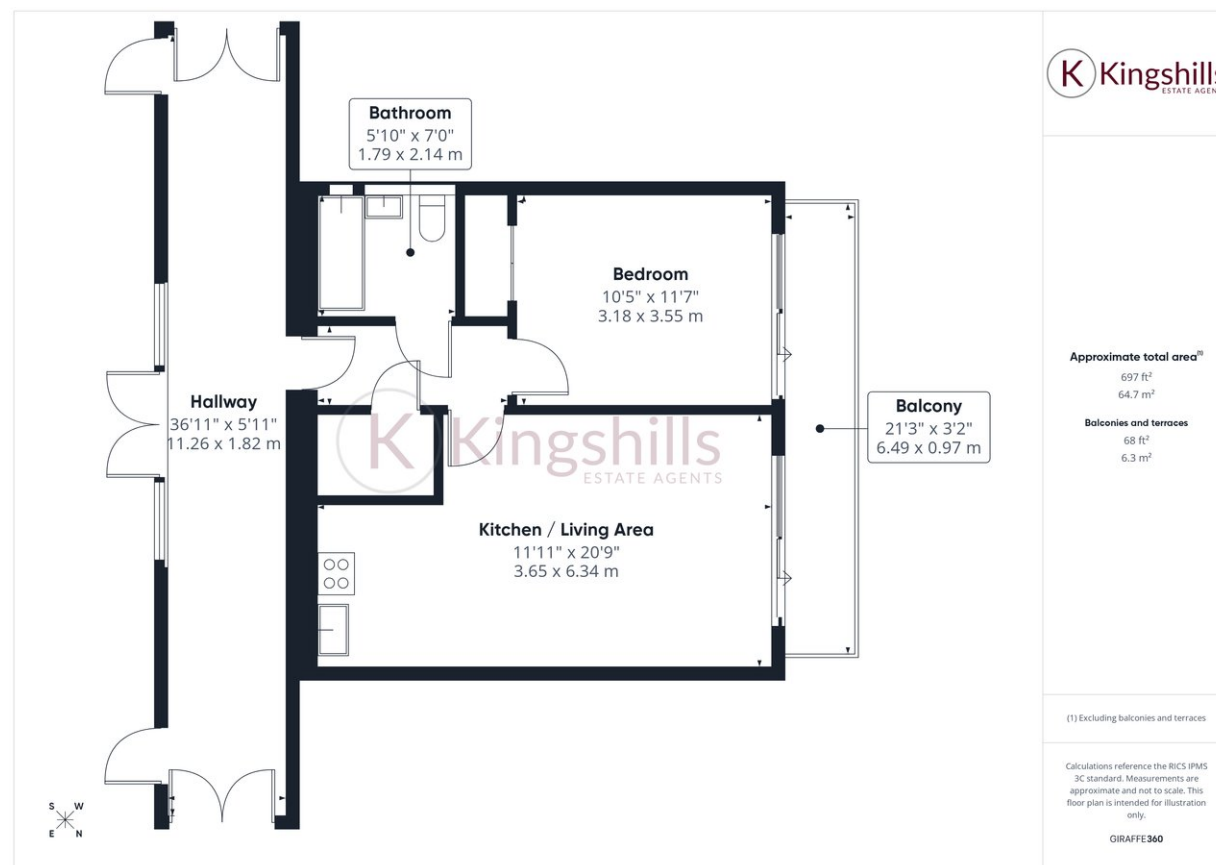

Kingshills Estate Agents
C1C Comet Studios
Amersham
Buckinghamshire
HP7 0PX

01494 939868
hello@kingshills.co.uk
kingshills.co.uk

Agents Note: Whilst every care has been taken to prepare these particulars, they are for guidance purposes only. All measurements are for general guidance purposes only and whilst every care has been taken to ensure accuracy, they should not be relied upon and potential buyers/tenants are advised to recheck the measurements