

AP MORGAN



Yarningale Road, Birmingham, West Midlands
Offers Over £350,000

Features:

- Three-bedroom semi-detached home
- Spacious Lounge/Family Room ideal for entertaining
- Open plan Kitchen/Dining Room with doors to lounge
- Ground floor Shower Room & external lean-to storage
- Two double bedrooms, all rooms have fitted wardrobes
- Modern, spacious Bathroom
- Generous garden space with potential
- Ample driveway for parking multiple vehicles
- Gas central heating & double glazing

Description:

CATCHMENT for prestigious schools! This is an EXTENDED well-presented bedroom semi-detached home. Offering a versatile, open plan layout, generously sized rooms, large-picture bay windows, a contemporary kitchen, two double bedrooms as well as a single bedroom, a shower room and bathroom, a generous loft space with potential for expansion, as well as swift access to local amenities.

To the front of the house is an ample block-paved driveway fit for parking multiple vehicles, access to a lean-to storage space and brick wall boundaries.

The ground floor accommodation comprises: a generous double glazed porch, a welcoming entrance hall with access to the ground floor shower room, the lounge/family room of the house presents a large-picture bay window, a fireplace, and access through a set of glazed bi-folding doors to the contemporary kitchen/dining room, with two sets of glazed French doors to the rear, skylight windows and is fitted with the following integral appliances; a sink on a central serving counter, five-ring gas hob with an extraction fan, double convection oven, integrated washer and integrated dryer as well as space/plumbing for freestanding appliances/furniture.

The first-floor landing establishes: Bedrooms one is an ample-sized double with a large bay window and integrated wardrobes, bedroom two is a similar double with the same features and bedroom three is a comfortable single, also benefitting from a fitted wardrobe. The modern bathroom of the house features a bath/shower, wash basin and WC. To the rear is a versatile garden with lots of potential, offering an initial stone-slab paving that steps down to a central space laid to lawn. This garden features fenced boundaries.



Yarningale Road is situated within the Kings Heath suburb of Birmingham. Roughly 5 miles south of the city centre. This area is known for the wide range of outstanding primary schools and is within the catchment area for the sought after King Edward Camphill. Grammar School. Situated close to Kings Heath High street, which is roughly 1.3 miles away, offering an assortment of amenities.

Also situated close to shopping facilities, bars and restaurants, along with the local bus and railway stations. Additionally, the M5, M40 and M42 motorways are accessible.

Details:

Double glazed Porch

Entrance Hall

Lounge/Family Room 27'5" x 10'5" (8.36m x 3.18m) Both max (into bay)

Kitchen/Dining Room 17'4" x 18'9" (5.28m x 5.72m) (depth from door to back wall)

Shower Room 6'2" x 5'2" (1.88m x 1.57m)

Landing

Bedroom one 15'5" x 10'5" (4.7m x 3.18m) Both max (into bay)

Bedroom two 14' x 10'7" (4.27m x 3.23m) Both max (into bay)

Bedroom three 8'9" x 5'9" (2.67m x 1.75m)

Bathroom 9' x 5'8" (2.74m x 1.73m)

EPC Rating: To be confirmed

Council Tax Band: B (tbc by solicitors).

Tenure: Freehold (tbc by solicitors).

For more information or to arrange a viewing, please call us on 0121 817 8585.



How can we help you?

Need a mortgage?

We recommend Wiser Mortgage Advice. They will search the market for you to ensure you get the right lender and mortgage deal. They typically achieve mortgage offers much more quickly than if you were dealing with lenders directly.

The initial appointment is free and without obligation. Call us on 0121 817 8585, or visit their website for more information: www.wisermortgageadvice.co.uk

Property to sell?

If you need to sell a property in order to buy, you ideally need to be on the market at least (and preferably Sold STC) before viewing, otherwise you may lose out to other buyers when the right property comes along. In these circumstances we can get your property 'live' quickly. Just book a free valuation and we will visit your property and discuss your needs.

Need a solicitor?

A good solicitor can save you literally weeks of time in the buying/selling process, reducing the stress levels of all involved. We will instruct a reputable firm that is competitive on cost and very reliable. Just ask for a quote.

Identity Checks

Estate Agents are required by law to conduct anti-money laundering checks on all those buying a property. We have partnered with a third party supplier to undertake these who will contact you once you have had an offer accepted on a property you wish to buy. The cost of these checks is £99 + VAT per buyer and this is a non-refundable fee. These charges cover the cost of obtaining relevant data, any manual checks and monitoring which might be required. This fee will need to be paid and the checks completed in advance of the issuing of a memorandum of sale on the property you would like to buy.

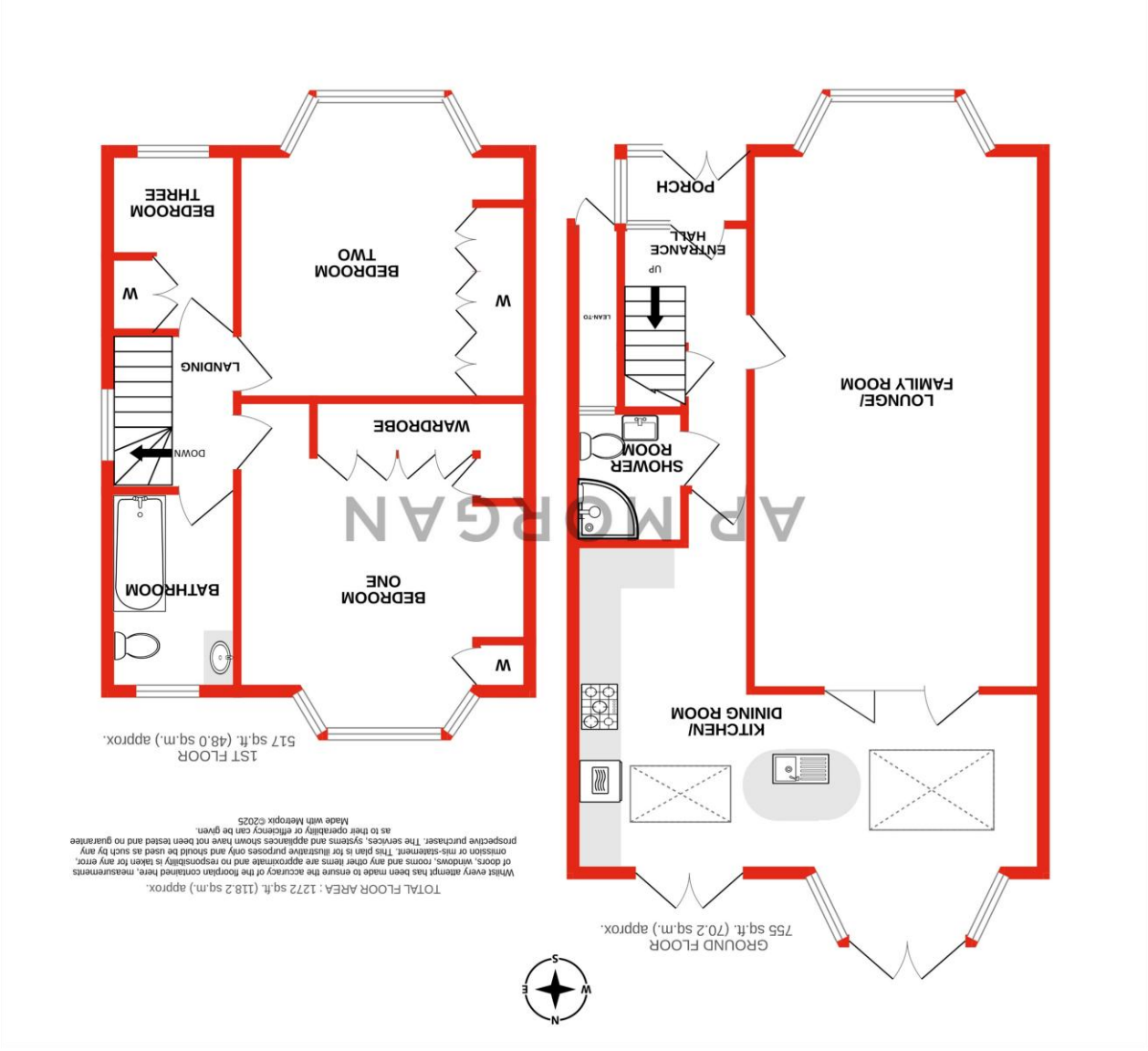

No statement in these details is to be relied upon as representation of fact, and purchasers should satisfy themselves by inspection or otherwise as to the accuracy of the statements contained within. These details do not constitute any part of any offer or contract. AP Morgan and their employees and agents do not have any warranty or representation whatsoever in respect of this property. These details and all statements herein are provided without any responsibility on the part of AP Morgan or the vendors. Equipment: AP Morgan has not tested the equipment or central heating system mentioned in these particulars and the purchasers are advised to satisfy themselves as to the working order and condition. Measurements: Great care is taken when measuring, but measurements should not be relied upon for ordering carpets, equipment, etc. The Laws of Copyright protect this material. AP Morgan is the Owner of the copyright. This property sheet forms part of our database and is protected by the database right and copyright laws. No unauthorised copying or distribution without permission.