

**AP MORGAN**



**Sands Road, Inkberrow, Worcester**  
Guide Price £320,000

**Features:**

- A well-presented semi-detached family home
- Desirable rural position in Inkberrow, Worcester
- Three well-proportioned bedrooms
- Generous lounge & formal dining room
- Fitted kitchen & spacious conservatory
- Family bathroom & gardeners w/c
- Generous rear garden backing onto open fields
- Large gravelled driveway for multiple cars

**Description:**

A well presented three bedroom semi-detached home occupying a desirable position in the sought-after village of Inkberrow, offering comfortable family accommodation throughout with the added bonus of a generous rear garden backing onto open countryside with far reaching views towards Alcester.

To the front, a generous gravelled driveway provides parking for multiple vehicles with fenced boundaries and a side gate giving access to the rear garden.

The ground floor is well laid out, with an enclosed porch leading into the entrance hall and through to a generous lounge with a feature fixed electric fireplace. The lounge opens into a dining room with an understairs storage cupboard, with the fitted kitchen sitting alongside, offering a range of wall and base units, integrated oven, electric hob and dishwasher with space for additional freestanding appliances. To the rear of the ground floor, a generous conservatory extends the living space further and incorporates a dedicated utility area with plumbing for laundry appliances.

The first floor landing serves two sizeable double bedrooms, a further generous third bedroom and a modern family bathroom fitted with a bath, overhead shower, washbasin and WC.

Outside, the rear garden is a real asset. An initial patio provides space for garden furniture before giving way to a large lawn that extends back to a timber shed and greenhouse. The rear boundary backs directly onto open fields with far reaching views towards Alcester, giving the property a genuine sense of space and seclusion. A brick built gardener's WC adds a practical touch.

Inkberrow is a picturesque and highly regarded village sitting in the heart of the Worcestershire countryside, widely recognised as one of the inspirations for the fictional village of Ambridge in BBC Radio 4's The Archers. The village offers a good range of day-to-day amenities including a well-stocked village shop, pub, church and



primary school, all centred around a charming village green. The historic market town of Redditch is within easy reach for a wider range of supermarket shopping, retail and leisure facilities, as is Worcester city centre. For commuters, the A42 provides straightforward connections to the local road network with the M5 and M42 both accessible, making this a well connected base despite its rural feel.

**Details:**

**Porch**

**Hall**

**Lounge** 3.85 x 4.33 Max

**Dining Room** 2.42 x 2.43

**Kitchen** 2.42 x 2.79

**Conservatory** 3.07 x 3.07

**First Floor Landing**

**Bedroom One** 3.83 x 2.63

**Bedroom Two** 2.45 x 3.46

**Bedroom Three** 2.88 x 2.64 Max

**Bathroom** 2.42 x 1.82

**EPC Rating:** C

**Council Tax Band:** C (tbc by solicitors).

**Tenure:** Freehold (tbc by solicitors).

For more information or to arrange a viewing, please call us on 01527 910 300.



## How can we help you?

### Need a mortgage?

We recommend Wiser Mortgage Advice. They will search the market for you to ensure you get the right lender and mortgage deal. They typically achieve mortgage offers much more quickly than if you were dealing with lenders directly. The initial appointment is free and without obligation. Call us on 01527 910 300, or visit their website for more information: [www.wisermortgageadvice.co.uk](http://www.wisermortgageadvice.co.uk)

### Property to sell?

If you need to sell a property in order to buy, you ideally need to be on the market at least (and preferably Sold STC) before viewing, otherwise you may lose out to other buyers when the right property comes along. In these circumstances we can get your property 'live' quickly. Just book a free valuation and we will visit your property and discuss your needs.

### Need a solicitor?

A good solicitor can save you literally weeks of time in the buying/selling process, reducing the stress levels of all involved. We will instruct a reputable firm that is competitive on cost and very reliable. Just ask for a quote.

### Identity Checks

Estate Agents are required by law to conduct anti-money laundering checks on all those buying a property. We have partnered with a third party supplier to undertake these who will contact you once you have had an offer accepted on a property you wish to buy. The cost of these checks is £99 + VAT per buyer and this is a non-refundable fee. These charges cover the cost of obtaining relevant data, any manual checks and monitoring which might be required. This fee will need to be paid and the checks completed in advance of the issuing of a memorandum of sale on the property you would like to buy.

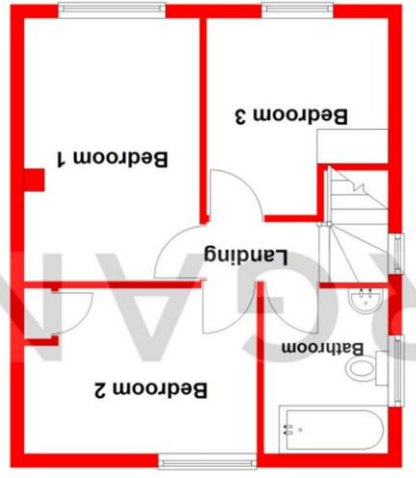
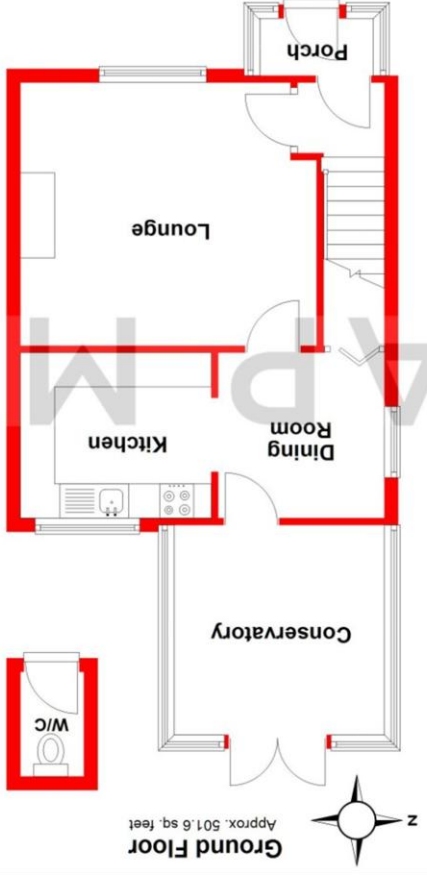

Total area: approx. 871.0 sq. feet

Whilst every attempt has been made to ensure the accuracy of the floorplan contained here, measurements of doors, windows, rooms, and any other items are approximate and no responsibility is taken for any error, omission or mis-statement. This plan is for illustrative purposes only and should be used as such by any prospective purchaser. The services, systems and appliances shown have not been tested and no guarantee as to their operability or efficiency can be given.  
Plan produced using Planlup.

No statement in these details is to be relied upon as representation of fact, and purchasers should satisfy themselves by inspection or otherwise as to the accuracy of the statements contained within. These details do not constitute any part of any offer or contract. AP Morgan and their employees and agents do not have any authority to give any warranty or representation whatsoever in respect of this property. These details and all statements herein are provided without any responsibility on the part of AP Morgan or the vendors. Equipment: AP Morgan has not tested the equipment or central heating system mentioned in these particulars and the purchasers are advised to satisfy themselves as to the working order and condition. Measurements: Great care is taken when measuring, but measurements should not be relied upon for ordering carpets, equipment, etc. The Laws of Copyright protect this material. AP Morgan is the Owner of the copyright. This property sheet forms part of our database and is protected by the database right and copyright laws. No unauthorised copying or distribution without permission.