

AP MORGAN



Holywell Lane, Rubery
Offers in excess of £450,000

Features:

- Beautifully presented three-bedroom semi-detached house.
- Perfect for large and growing families
- A substantial lounge,
- A large dining room,
- A spacious, fitted breakfast kitchen,
- A ground floor WC,
- Three double bedrooms,
- A contemporary family bathroom,
- En-suite shower room,
- A large double garage/gym,
- A bar/games room,
- Utility,
- Off-street parking,
- Versatile and vast grass laid garden
- Prime positioning for amenities and local green spaces.

Description:

This beautifully presented three bedroom semi-detached house in Rednal, Birmingham is perfect for large and growing families, presenting: a substantial lounge, a large dining room, a spacious, fitted breakfast kitchen, a ground floor WC, three double bedrooms, a contemporary family bathroom, en-suite shower room, a large double garage/gym, a bar/games room, utility, off-street parking, versatile and vast grass laid garden and is in prime positioning for amenities and local green spaces.

On entry, the property leads into a hallway comprising stairs rising to the first floor. To the right, a door opens into the lounge, a generous space ideal for comfort and family entertainment. This flows seamlessly into the dining room via French doors, offering ample space for a family dining table and access to under stairs storage. The dining room leads into the kitchen, which is well fitted with ample storage and worktop space, an integrated dishwasher, a breakfast bar, and plenty of room for freestanding appliances. French doors open from the kitchen into the rear garden. The kitchen also provides access to a WC, fitted with a toilet and wash basin, as well as a utility room featuring additional storage cupboards, worktop space, a sink, and room for utility appliances.

The first floor comprises a landing with stairs leading to the second floor, bedroom two—a generous double with a fitted sliding-door wardrobe—the third bedroom, which is also a well-sized double, and the family bathroom, fitted with a toilet, wash basin, bathtub, and a shower cubicle.

The second floor leads to the main bedroom, a spacious double offering ample room for comfort and storage units. It also benefits from access to an en-suite, fitted with a toilet, wash basin, and shower cubicle, as well as a walk-in wardrobe, ideal for storage and space-saving.

The garden opens to an expansive paved patio hosting space for garden furniture and external storage. Continuing to a sweeping, well-maintained grass-laid lawn, there is ample space for outdoor activities and entertaining. The garden is completed by a border of wooden panel fencing and a large outbuilding currently being used as a bar/games room, presenting an additional covered space



perfect for entertaining. The property is completed by an external two-storey double garage currently being used as a gym, this offers substantial room for hobbies and external storage, with the first floor acting as a loft in its entirety.

Situated in a sought-after location of Rednal, Worcestershire, not only does this property benefit from its beautiful semi-rural surroundings, but also from easy access to Birmingham city centre, excellent local schooling and amenities and fantastic travel links being within close proximity of the M5 network.

Details:

Hall

Lounge 16'6" x 14'6" (5.03m x 4.42m)

Dining Room 8'8" x 17'8" (2.64m x 5.38m)

Kitchen/Breakfast Room 17'7" x 13'3" (5.36m x 4.04m)

Utility Room 10' x 5' (3.05m x 1.52m)

WC

Landing

Bedroom Two 8'8" x 17'8" (2.64m x 5.38m)

Bedroom Three 10'1" x 11'7" (3.07m x 3.53m)

Bathroom

Landing

Bedroom One 11'6" x 14'6" (3.5m x 4.42m) Both Max

En-suite

Closet/Storage

Double Garage/Gym 17'5" x 16'2" (5.3m x 4.93m)

Storage (Above Double Garage/Gym) 12'10" x 16'2" (3.9m x 4.93m)

Cellar 12'6" x 11'1" (3.8m x 3.38m)

Bar/Games Room 24'11" x 7' (7.6m x 2.13m)

EPC Rating: To be confirmed

Council Tax Band: D (tbc by solicitors).

Tenure: Freehold (tbc by solicitors).

For more information or to arrange a viewing, please call us on 0121 827 6827.

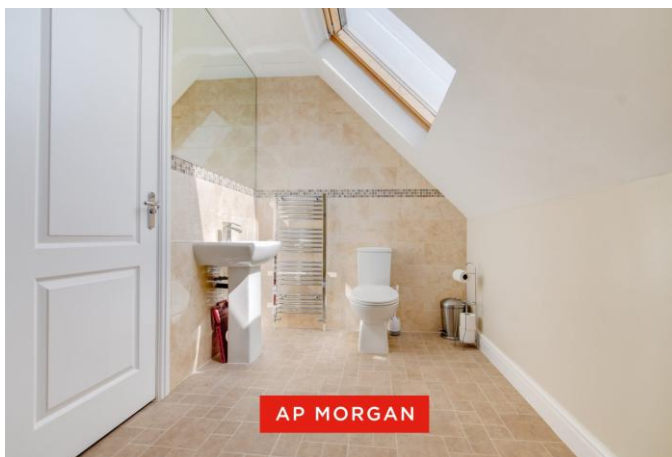

How can we help you?

Need a mortgage?

We recommend Wiser Mortgage Advice. They will search the market for you to ensure you get the right lender and mortgage deal. They typically achieve mortgage offers much more quickly than if you were dealing with lenders directly. The initial appointment is free and without obligation. Call us on 0121 827 6827, or visit their website for more information: www.wisermortgageadvice.co.uk

Property to sell?

If you need to sell a property in order to buy, you ideally need to be on the market at least (and preferably Sold STC) before viewing, otherwise you may lose out to other buyers when the right property comes along. In these circumstances we can get your property 'live' quickly. Just book a free valuation and we will visit your property and discuss your needs.

Need a solicitor?

A good solicitor can save you literally weeks of time in the buying/selling process, reducing the stress levels of all involved. We will instruct a reputable firm that is competitive on cost and very reliable. Just ask for a quote.

Identity Checks

Estate Agents are required by law to conduct anti-money laundering checks on all those buying a property. We have partnered with a third party supplier to undertake these who will contact you once you have had an offer accepted on a property you wish to buy. The cost of these checks is £99 + VAT per buyer and this is a non-refundable fee. These charges cover the cost of obtaining relevant data, any manual checks and monitoring which might be required. This fee will need to be paid and the checks completed in advance of the issuing of a memorandum of sale on the property you would like to buy.

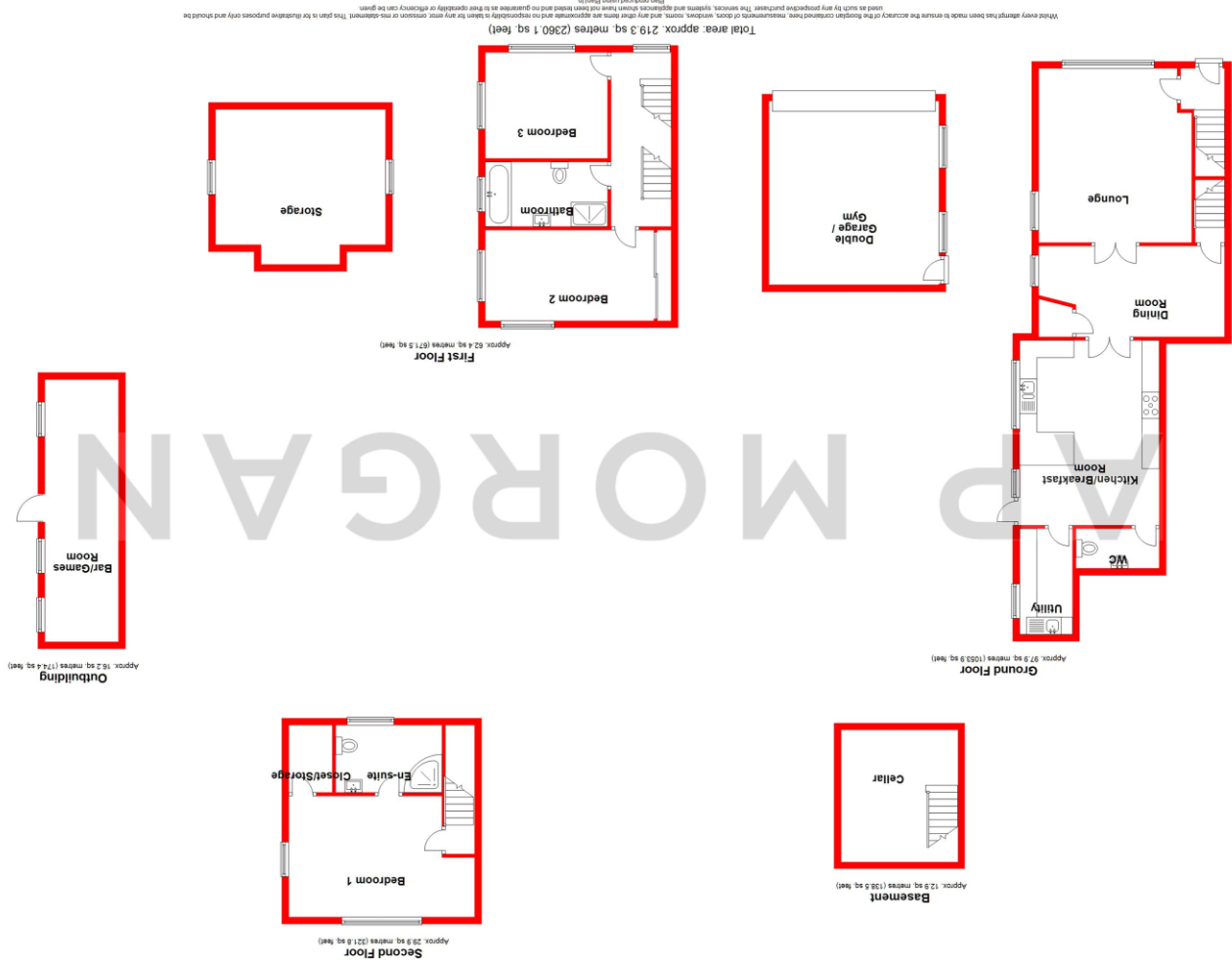

No statement in these details is to be relied upon as representation of fact, and purchasers should satisfy themselves by inspection or otherwise as to the accuracy of the statements contained within. These details do not constitute any part of any offer or contract. AP Morgan and their employees and agents do not have any authority to give any warranty or representation whatsoever in respect of this property. These details and all statements herein are provided without any responsibility on the part of AP Morgan or the vendors. Equipment: AP Morgan has not tested the equipment or central heating system mentioned in these particulars and the purchasers are advised to satisfy themselves as to the working order and condition. Measurements: Great care is taken when measuring, but measurements should not be relied upon for ordering carpets, equipment, etc. The Laws of Copyright protect this material. AP Morgan is the Owner of the copyright. This property sheet forms part of our database and is protected by the database right and copyright laws. No unauthorised copying or distribution without permission.