



Flat 1, 8 Salisbury Heights, Blandford Forum, Dorset, DT11 7QH



A beautifully presented two bedroom ground floor apartment in an attractive period-style building, offering bright open-plan living, modern kitchen and bathroom, and easy access to Blandford Forum town centre and countryside.

Kitchen / Lounge / Diner 21'10" (6.65m) x 16'9" (5.11m)- Spacious open-plan living with bay window flooding the room with light, wood-effect flooring, space for sofas and dining table, and a contemporary fitted kitchen with integrated oven, hob, extractor and ample worktop and cupboard storage.

Bedroom 1 10'4" (3.15m) x 10'1" (3.07m)- Well-proportioned double room with sash-style window, space for wardrobes and bedside furniture, and a calm décor ideal for a main bedroom.

Bedroom 2 9'6" (2.9m) x 7'4" (2.24m)- Versatile second bedroom, currently used as a nursery, with carpeted floor, sash-style window and room for single bed or home office setup.

Bathroom 7'1" (2.16m) x 5'11" (1.8m)- Modern white suite comprising panelled bath with shower over, wash hand basin and WC, tiled walls, and recessed area housing stacked washing machine and dryer for convenient laundry space.

Cupboard - Built-in storage cupboard accessed from the hallway, ideal for coats, cleaning items or household essentials.

£160,000 Leasehold

Salisbury Heights

Approximate Gross Internal Area
474 sq ft - 44 sq m

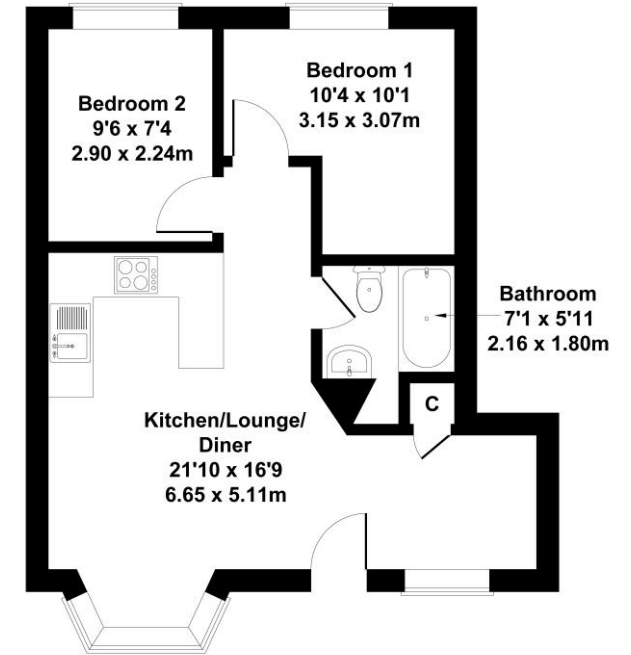

Not to Scale. Produced by The Plan Portal 2026
For Illustrative Purposes Only.

Please note Forum Sales & Lettings and their client give notice that:

1. They have no authority to make or give any representation or warranties in relations to the property. These particulars do not form part of any offer or contract and must not be relied upon as statements or representations of fact.
2. Any areas, common measurements or distances are approximate. The text, photographs and plans are for guidance only and are not necessarily comprehensive. It should not be assumed that the property has all necessary Planning, Building Regulations or other consents and Forum Sales and Lettings have not tested any services, equipment or facilities. Purchasers must satisfy themselves by inspection or otherwise.

EPC Rating - C

Viewing Arrangements - Strictly by appointment with Forum Sales & Lettings

15 Salisbury Street, Blandford Forum, Dorset, DT11 7AU

Tel: 01258 459600

