



54 CHURCH VIEW, BROMPTON
NORTHALLERTON, NORTH YORKSHIRE, DL6 2RD



54 CHURCH VIEW

Brompton, Northallerton, North Yorkshire, DL6 2RD

A charming two-bedroom cottage located on the sought-after Church View in the heart of Brompton village. Full of character, the property features a cosy living room with a dual-fuel stove, a modern kitchen and bathroom, two bedrooms, and a versatile loft room ideal for storage. A lovely cottage in a highly desirable village location close to local amenities and Northallerton.

- Popular village location
- Two-bedroom cottage
- Modern kitchen & bathroom
- Rear courtyard garden

GET IN TOUCH

youngsrps, 80-81 High Street, Northallerton, DL7 8EG

01609 773004

northallerton@youngsrps.com





DESCRIPTION

Situated on the ever-popular Church View in the heart of Brompton, this charming two-bedroom cottage offers characterful accommodation in a highly desirable village setting.

The property is full of warmth and charm, with a cosy living room centred around a dual-fuel stove, creating an inviting and homely feel. To the rear, the kitchen is fitted with a range of cream wall and base units together with a built-in oven, hob with extractor over, and space for a fridge freezer and washing machine. A rear door provides access outside.

To the first floor are two bedrooms, including a double bedroom with fitted wardrobes and a further single bedroom, together with a modern house bathroom. In addition, the property benefits from a versatile loft room accessed via a drop-down ladder, offering useful storage space or potential for those working from home.

Externally, there is an enclosed paved rear yard with flower beds and space for outdoor seating, all enclosed by a brick wall.

Church View is a particularly sought-after position within Brompton, a well-regarded village offering a range of local amenities whilst remaining conveniently placed for access to nearby Northallerton and transport links.

A lovely character cottage that would suit a variety of purchasers, from first-time buyers to those looking to downsize or invest.

LOCATION

This property is ideally situated in the heart of Brompton, a charming village located just 1.5 miles north of Northallerton and around 6 miles from the main A19 trunk road. Brompton offers a traditional village feel with its pretty village green, well-regarded primary school, welcoming pub, historic church, local shop, and regular bus service.

Tenure

The property is Freehold.







Charges

North Yorkshire Council Tax Band B.

Services

Mains electricity, water, gas and drainage are connected.

Viewings

Strictly by appointment only. Please contact the Agent on 01609 773004.

Agent's Notes

Free Market Appraisal - We will be pleased to provide unbiased and professional advice, without obligation, on the marketing and current value of your present home.



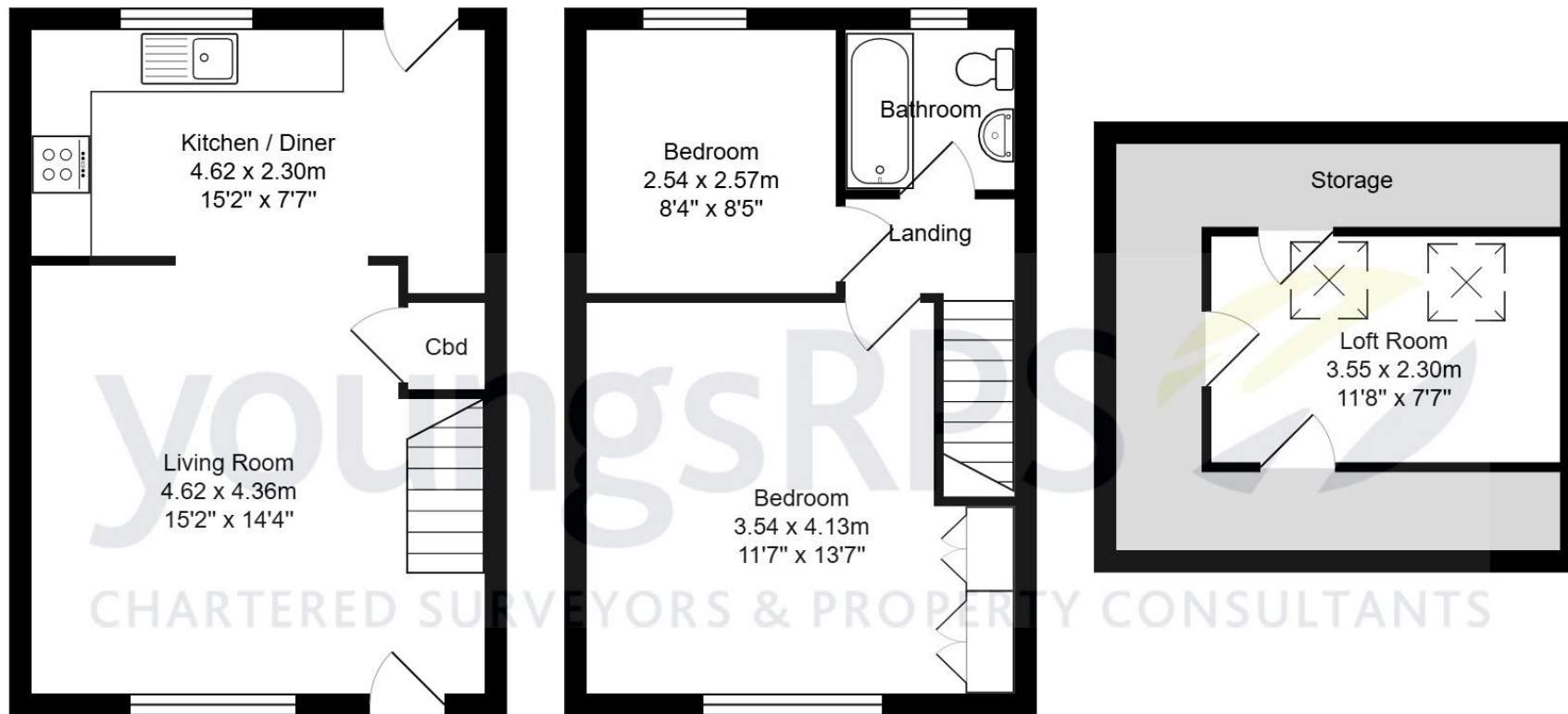

Total Area: 80.5 m² ... 867 ft²

All measurements are approximate and for display purposes only.

www.youngsrps.com
Northallerton 01609 773004



IMPORTANT NOTE: Consumer Protection from Unfair Trading Regulations 2008 and the Business Protection from Misleading Marketing Regulations 2008: We endeavour to make our sales particulars accurate and reliable. They should be considered as general guidance only and do not constitute all or any part of the contract. None of the services, fittings and equipment have been tested. Measurements, where given, are approximate and for descriptive purposes only. Boundaries cannot be guaranteed and must be checked by solicitors prior to exchange of contracts. Prospective buyers and their advisers should satisfy themselves as to the facts, and before arranging an inspection, availability. Further information on points of particular importance can be provided. No person in the employment of youngsrPS (NE) Ltd has any authority to make or give any representation or warranty whatever in relation to this property.