

COATE CLOSE, HEMLINGTON, MIDDLESBROUGH, TS8 9RA



- ▲ A Well Presented Two Bedroom Semi Detached House
- ▲ Tucked Away in a Quiet Cul-De-Sac
- ▲ Modern Fitted Kitchen
- ▲ Lounge with Access to Conservatory Enjoying Views Over the Rear Garden

- ▲ Two Bedrooms & Modern Shower Room
- ▲ Driveway to Single Garage

Offers Over £145,000

www.michaelpoole.co.uk

Michael Poole
sales | lettings | auctions



A well-presented two bedroom semi-detached house tucked away in a quiet cul-de-sac and ideal for a first time buyer. Features include a modern fitted kitchen, conservatory, modern shower room, private garden and driveway to single garage.

CONSERVATORY - 2.57m x 2.06m (8'5" x 6'9")

Enjoying lovely views over the private garden with French doors to access.

GROUND FLOOR

ENTRANCE

With storage cupboard.

KITCHEN - 2.6m x 2.41m (8'6" x 7'11")

With a modern range of fitted wall and floor units, complementary work surfaces, integrated oven with microwave above, electric hob with extractor over, and integrated fridge and dishwasher.

LOUNGE - 4.7m x 3.4m (15'5" x 11'2")

With feature fire surround, staircase to the first floor and French doors open to the conservatory.

FIRST FLOOR

BEDROOM ONE - 3.7m x 3.6m (12'2" x 11'10")

BEDROOM TWO - 3.63m x 1.75m (11'11" x 5'9")

SHOWER ROOM - 2.6m x 1.73m (8'6" x 5'8")

Modern suite comprising shower cubicle, low level WC, wash hand basin and part tiled walls.

EXTERNALLY

PARKING, GARAGE & GARDEN

Externally the property is tucked away in a quiet cul-de-sac and features a driveway leading to a detached single garage and to the rear there is an easy to maintain private garden.

TO VIEW: Tel: 01642 955625

95 Guisborough Road, Nunthorpe, TS7 0JS

www.michaelpoole.co.uk



COATE CLOSE, TS8 9RA

BUYERS IDENTIFICATION CHECK(S) - Should a purchaser(s) have an offer accepted on a property marketed by Michael Poole Estate Agents they will need to undertake an identification check. This is done to meet our obligation under Anti Money Laundering Regulations (AML) and is a legal requirement. We use a third party service to verify your identity; this is not a credit check and will have no effect on credit history. The cost of these checks is £36 inc. VAT per buyer, which is paid in advance, when an offer is agreed and prior to a sales memorandum being issued. This charge is non-refundable.

AGENTS REF: - DP/LS/NUN260411/11062026

Council Tax Band: B **Tenure:** Freehold

TO VIEW: Contact our Nunthorpe office on
Tel: **01642 955625**



COATE CLOSE, TS8 9RA



Do you have a property you
need to sell
before you can buy?

Michael Poole offers **FREE, no obligation**
market appraisals and gives you guidance
on the **BEST PRICE** you can expect in the
current market

Coate Close

Approximate Gross Internal Area
646 sq ft - 60 sq m

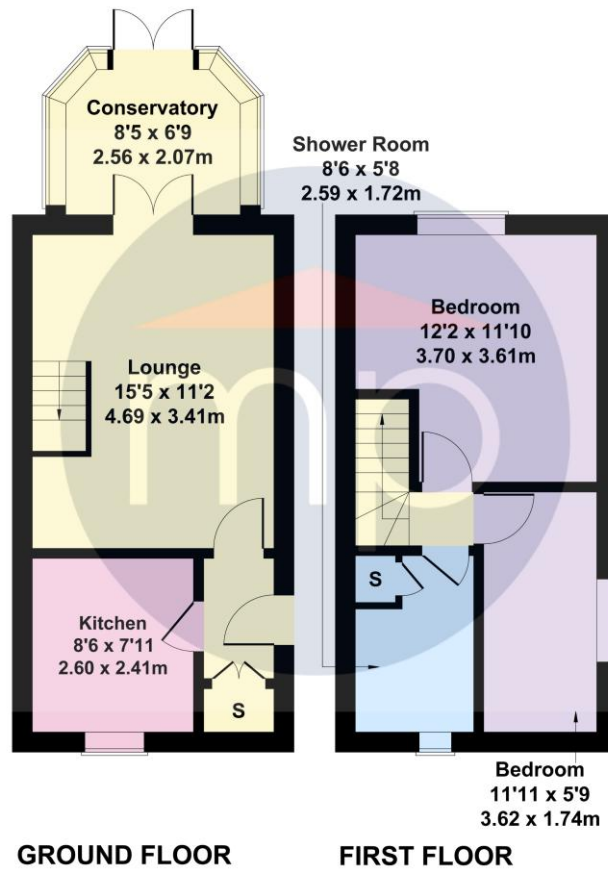

Not to Scale. Produced by The Plan Portal 2026
For Illustrative Purposes Only.

The information provided about this property does not constitute or form part of an offer or contract, nor may it be regarded as representations. All interested parties must verify accuracy and your solicitor must verify tenure and lease information, fixtures and fittings and, where the property has been recently constructed, extended or converted, that planning/building regulation consents are in place. All dimensions are approximate and quoted for guidance only, as are floor plans which are not to scale, and their accuracy cannot be confirmed. Reference to appliances and/or services does not imply that they are necessarily in working order or fit for the purpose. We offer our clients an optional conveyancing service, through panel conveyancing firms, via MWU and we receive on average a referral fee of one hundred and thirty pounds, only on completion of the sale. If you do use this service, the referral fee is included within the amount that you will be quoted by our suppliers. All quotes will also provide details of referral fees payable.

Score	Energy rating	Current	Potential
92+	A		
81-91	B		90 B
69-80	C	73 C	
55-68	D		
39-54	E		
21-38	F		
1-20	G		



TO VIEW: Contact our Nunthorpe Office on Tel: **01642 955625**
95 Guisborough Road, Nunthorpe, TS7 0JS