

ELMWOOD, COULBY NEWHAM, MIDDLESBROUGH, TS8 0SS



- ▲ A Beautifully Presented Two Bedroom Semi Detached House
- ▲ Popular Area of Coulby Newham Offering Easy Access to Local Amenities
- ▲ Spacious Living Room with Feature Panelling
- ▲ Smart Fitted Kitchen & Separate Utility Area

- ▲ Two Double Bedrooms
- ▲ Modern Bathroom
- ▲ Move In Condition
- ▲ No Forward Chain
- ▲ Driveway to Remainder of Garage
- ▲ Private Landscaped Rear Garden
- ▲ Ideal for a First Time Buyer

£150,000

www.michaelpoole.co.uk

Michael Poole
sales | lettings | auctions



A well-presented two bedroom semi-detached house located within this popular area of Coulby Newham offering easy access to local amenities. Offered for sale with no forward chain and featuring a modern fitted kitchen and separate utility, living room with feature panelled wall, modern family bathroom, two double bedrooms, driveway leading to the remainder of the garage and an enclosed landscaped private rear garden.

GROUND FLOOR

ENTRANCE PORCH

LIVING ROOM - 5.8m x 3.38m (19' x 11'1")

With part panelled feature wall and staircase to the first floor.

KITCHEN - 3.63m x 2.13m (11'11" x 7')

With a smart range of fitted wall and floor units, complementing work surfaces, electric oven, electric hob, space for fridge and freezer, tiled splashbacks, rear external door and door to utility area.

UTILITY AREA - 3.38m x 2.82m (11'1" x 9'3")

With internal door to the remainder of the garage and external door to the rear, work surface, plumbing for washing machine and dryer and spotlighting. This is a multifunctional room which could be used as a gym, study or playroom.

FIRST FLOOR

BEDROOM ONE - 3.58m x 3.43m (11'9" x 11'3")

With built-in wardrobes and dressing table.

BEDROOM TWO - 3.63m x 2.62m (11'11" x 8'7")

With built-in storage.

BATHROOM

White suite comprising bath with shower over and screen, vanity style wash hand basin and low level WC.

TO VIEW: Tel: 01642 955625

95 Guisborough Road, Nunthorpe, TS7 0JS

www.michaelpoole.co.uk



ELMWOOD, TS8 0SS

EXTERNALLY

PARKING & GARDEN

Externally to the front there is a hardstanding area with slate chippings and sleeper borders. A driveway gives access to the remainder of the garage and to the rear there is a private, well-presented landscaped garden with decking, patio area, slate chippings and sleeper borders.

REMAINDER OF GARAGE - 3.63m x 2.51m (11'11" x 8'3")

With internal door to the utility area.

AGENTS REF: - DP/LS/NUN260256/26032026

Council Tax Band: B **Tenure:** Freehold

TO VIEW: Contact our Nunthorpe office on
Tel: **01642 955625**

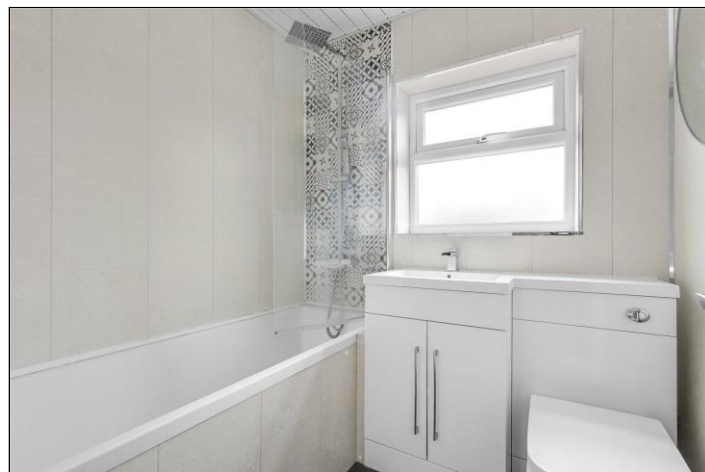

ELMWOOD, TS8 0SS



Elmwood

Approximate Gross Internal Area
861 sq ft - 80 sq m

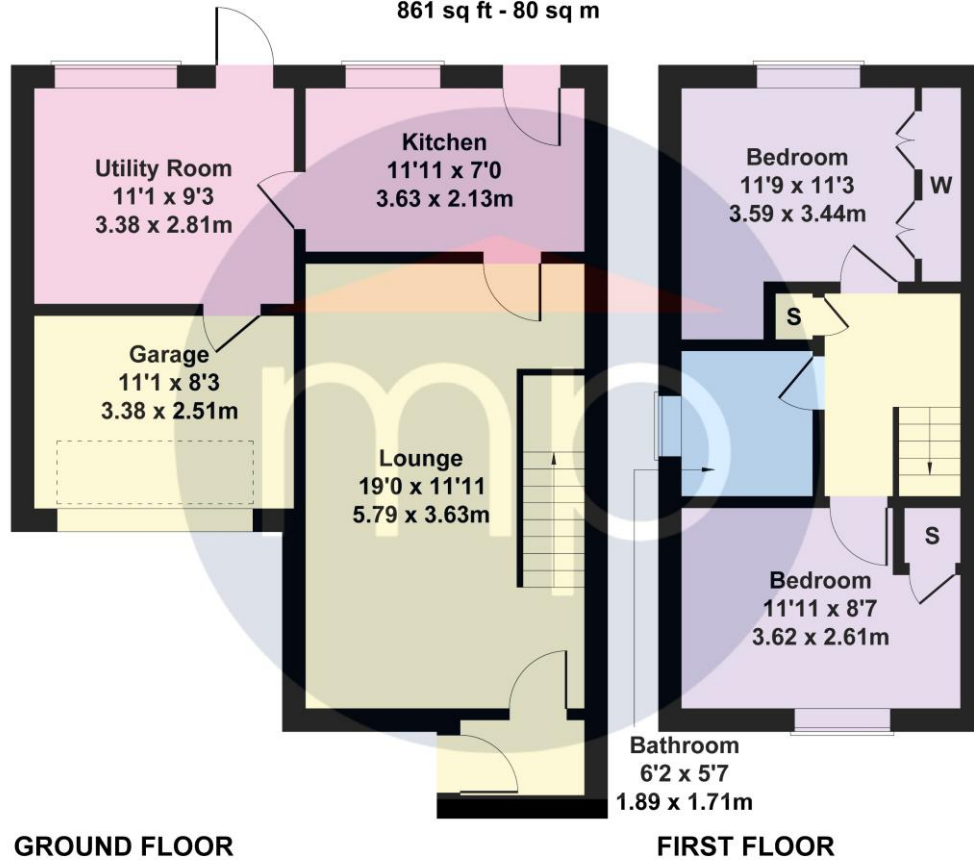

Not to Scale. Produced by The Plan Portal 2024
For Illustrative Purposes Only.

The information provided about this property does not constitute or form part of an offer or contract, nor may it be regarded as representations. All interested parties must verify accuracy and your solicitor must verify tenure and lease information, fixtures and fittings and, where the property has been recently constructed, extended or converted, that planning/building regulation consents are in place. All dimensions are approximate and quoted for guidance only, as are floor plans which are not to scale, and their accuracy cannot be confirmed. Reference to appliances and/or services does not imply that they are necessarily in working order or fit for the purpose. We offer our clients an optional conveyancing service, through panel conveyancing firms, via MWU and we receive on average a referral fee of one hundred and thirty pounds, only on completion of the sale. If you do use this service, the referral fee is included within the amount that you will be quoted by our suppliers. All quotes will also provide details of referral fees payable.



TO VIEW: Contact our Nunthorpe Office on Tel: **01642 955625**
95 Guisborough Road, Nunthorpe, TS7 0JS