

## ELMWOOD, COULBY NEWHAM, MIDDLESBROUGH, TS8 0SR



- ▲ Located Within a Quiet Cul-De-Sac
- ▲ Easy Access to Local Amenities
- ▲ No Forward Chain
- ▲ 19ft Lounge Diner
- ▲ Smart Fitted Kitchen
- ▲ Two Double Bedrooms

- ▲ Driveway Offering Parking for Three Cars
- ▲ Private Rear Garden
- ▲ The Property Benefits from Solar Panels With 6 Years Remaining on The Feed in Tarriff Payments

**£125,000**

[www.michaelpoole.co.uk](http://www.michaelpoole.co.uk)

**Michael Poole**  
sales | lettings | auctions



Offered for sale with no forward chain, a two bedroom semi-detached house located within a quiet cul-de-sac offering easy access to local amenities. Features include 19ft lounge diner, smart fitted kitchen, three double bedrooms, private rear garden and off road parking for two cars.

**GROUND FLOOR**

**ENTRANCE PORCH**

**LOUNGE DINER - 5.87m x 3.66m (19'3" x 12')**  
With staircase to the first floor.

**KITCHEN - 3.66m x 2.06m (12' x 6'9")**  
With range of fitted wall and floor units, complementing work surfaces, electric oven, electric hob with extractor over, plumbing for washing machine and rear external door.

**FIRST FLOOR**

**BEDROOM ONE - 3.62m x 2.12m (11'11" x 6'11")**  
With built-in wardrobes.

**BEDROOM TWO - 3.62m x 2.59m (11'11" x 8'6")**

**BATHROOM - 1.89m x 1.71m (6'2" x 5'7")**  
White suite comprising bath with shower over, low level WC, wash hand basin and part tiled walls.

**EXTERNALLY**

**PARKING & GARDEN** - Externally the property is located within a quiet cul-de-sac and features off road parking for three cars to the side elevation and to the rear there is an enclosed private generous size garden mainly laid to lawn with borders.

**TO VIEW:** Tel: 01642 955625  
95 Guisborough Road, Nunthorpe, TS7 0JS

[www.michaelpoole.co.uk](http://www.michaelpoole.co.uk)



ELMWOOD, TS8 0SR



**AGENTS REF:** - DP/LS/NUN260085/19022026

**Council Tax Band:** B      **Tenure:** Freehold

**TO VIEW:** Contact our Nunthorpe office on  
Tel: **01642 955625**

A photograph of the Michael Poole property consultants storefront at night. The building has a blue illuminated sign that reads 'Michael Poole property consultants'. The windows are lit up, showing the interior of the office.

**Do you have a property you need to sell before you can buy?**

Michael Poole offers **FREE, no obligation** market appraisals and gives you guidance on the **BEST PRICE** you can expect in the current market

## Elmwood

Approximate Gross Internal Area  
646 sq ft - 60 sq m

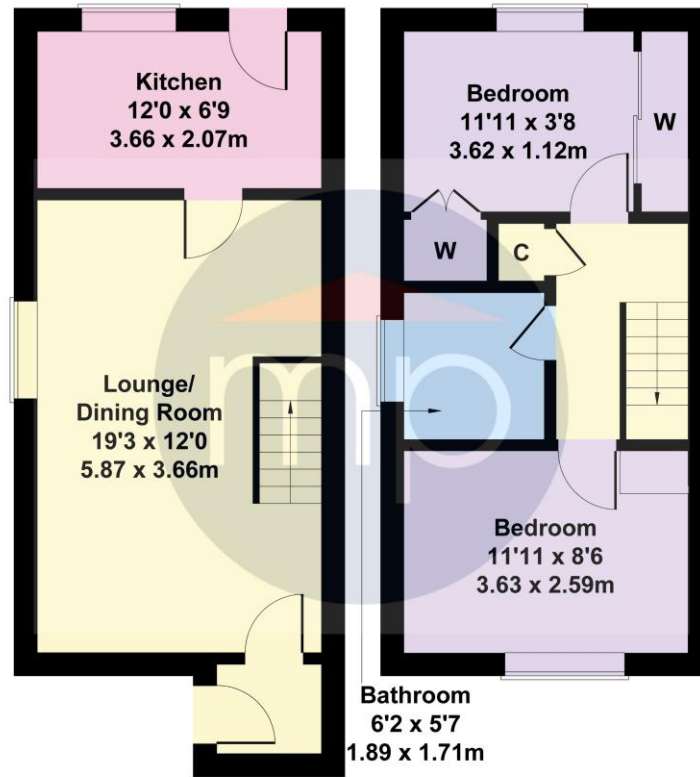

**GROUND FLOOR**

**FIRST FLOOR**

Not to Scale. Produced by The Plan Portal 2026  
For Illustrative Purposes Only.

The information provided about this property does not constitute or form part of an offer or contract, nor may it be regarded as representations. All interested parties must verify accuracy and your solicitor must verify tenure and lease information, fixtures and fittings and, where the property has been recently constructed, extended or converted, that planning/building regulation consents are in place. All dimensions are approximate and quoted for guidance only, as are floor plans which are not to scale, and their accuracy cannot be confirmed. Reference to appliances and/or services does not imply that they are necessarily in working order or fit for the purpose. We offer our clients an optional conveyancing service, through panel conveyancing firms, via MWU and we receive on average a referral fee of one hundred and thirty pounds, only on completion of the sale. If you do use this service, the referral fee is included within the amount that you will be quoted by our suppliers. All quotes will also provide details of referral fees payable.



**TO VIEW:** Contact our Nunthorpe Office on Tel: **01642 955625**  
95 Guisborough Road, Nunthorpe, TS7 0JS