

# SHERWOOD CLOSE, ORMESBY, MIDDLESBROUGH, TS7 9HQ



- ▲ Offered For Sale with No Chain
- ▲ A Beautifully Presented & Modernised Three Bedroom Dormer Bungalow
- ▲ Located Within a Quiet Cul-De-Sac in this Popular Area of Ormesby
- ▲ Occupying a Fabulous Plot with Well Maintained Gardens to the Front, Side & Rear Elevations
- ▲ Large Open Plan Modern Fitted Kitchen/Living/Family Area
- ▲ Two Ground Floor Bedrooms
- ▲ Stunning Modern Family Shower Room with Large Shower Enclosure
- ▲ 21ft Master Bedroom to the First Floor
- ▲ Converted Garage Providing a Salon/Home Office/Studio/Gym

**Offers Over £200,000**

[www.michaelpoole.co.uk](http://www.michaelpoole.co.uk)

**Michael Poole**  
sales | lettings | auctions



Offered for sale with no chain, a spacious beautifully presented three bedroom dormer bungalow located within a quiet cul-de-sac in this popular area of Ormesby. Features include a large open plan kitchen/living/family area to the rear elevation enjoying pleasant views over the well-maintained and spacious rear garden, modern shower room, two bedrooms to the ground floor and a 21ft master bedroom to the first floor. Externally there is a block paved driveway and a converted garage currently used as a salon but could alternatively be used as a home office, studio or gym.

**GROUND FLOOR**

**ENTRANCE HALL** - With LVT flooring.

**OPEN PLAN KITCHEN/LIVING/FAMILY ROOM - 5.2m (17'1") x 2.87m (9'5") in the kitchen area**

With a stunning range of modern fitted units by 'Wren', complementing work surfaces and breakfast bar. Integrated appliances include a double oven, microwave, induction hob with integral extractor, wine cooler, fridge, freezer and dishwasher. Spot lighting, LVT flooring, side external door and opening to the living/family area.

**LIVING FAMILY AREA - 4.14m x 3.58m (13'7" x 11'9")**

With LVT flooring, inset vertical design radiator, spotlighting and patio door to the rear garden.

**BEDROOM TWO - 3.66m x 3.48m (12' x 11'5")**

**BEDROOM THREE - 3.33m x 3.02m (10'11" x 9'11")**

**SHOWER ROOM** - Modern white suite comprising large walk-in shower, pedestal wash hand basin and low level WC.

**FIRST FLOOR**

**MASTER BEDROOM - 6.53m x 3.76m (21'5" x 12'4")**

With storage into the eaves.

**EXTERNALLY**

**PARKING & GARDENS** - Externally there is a block paved driveway and a lawned garden to the front elevation and to the rear there is a large well-maintained mature garden with side gazebo, pond, mature lawn and an array of borders.

**TO VIEW:** Tel: **01642 955625**

95 Guisborough Road, Nunthorpe, TS7 0JS

[www.michaelpoole.co.uk](http://www.michaelpoole.co.uk)



# SHERWOOD CLOSE, TS7 9HQ

**CONVERTED GARAGE** - Currently used as a salon but could alternatively used as a home office, bar or gym.

**AGENTS REF:** - DP/LS/NUN250019/18022026

**Council Tax Band:** C     **Tenure:** Freehold

**TO VIEW:** Contact our Nunthorpe office on  
Tel: 01642 955625



SHERWOOD CLOSE, TS7 9HQ



SHERWOOD CLOSE, TS7 9HQ



### Sherwood Close

Approximate Gross Internal Area  
1055 sq ft - 98 sq m

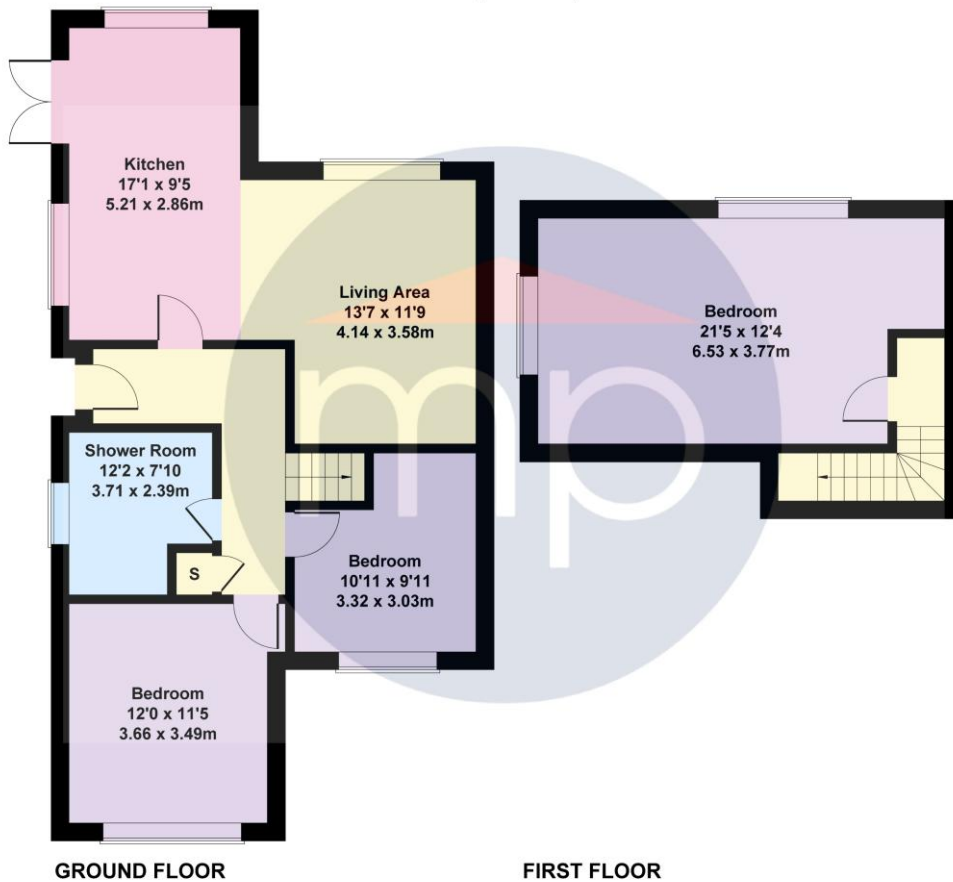

Not to Scale. Produced by The Plan Portal 2026  
For Illustrative Purposes Only.

The information provided about this property does not constitute or form part of an offer or contract, nor may it be regarded as representations. All interested parties must verify accuracy and your solicitor must verify tenure and lease information, fixtures and fittings and, where the property has been recently constructed, extended or converted, that planning/building regulation consents are in place. All dimensions are approximate and quoted for guidance only, as are floor plans which are not to scale, and their accuracy cannot be confirmed. Reference to appliances and/or services does not imply that they are necessarily in working order or fit for the purpose. We offer our clients an optional conveyancing service, through panel conveyancing firms, via MWU and we receive on average a referral fee of one hundred and thirty pounds, only on completion of the sale. If you do use this service, the referral fee is included within the amount that you will be quoted by our suppliers. All quotes will also provide details of referral fees payable.



**TO VIEW:** Contact our Nunthorpe Office on Tel: **01642 955625**  
95 Guisborough Road, Nunthorpe, TS7 0JS