

PRITCHETT ROAD, ORMESBY, MIDDLESBROUGH, TS3 0NQ



- ▲ Modern Three Bedroom Semi Detached Home
- ▲ Perfect For First Time Buyers, Young Couples & Families Alike!
- ▲ Ample Off Street Parking on A Block Paved Driveway
- ▲ Sunroom
- ▲ Shower Room with A Walk-In Shower
- ▲ Good Sized Well Looked After Rear Garden
- ▲ UPVC Double Glazed Windows & Composite Front Door
- ▲ Open Plan Lounge/Diner
- ▲ Gas Central Heating

£199,950

www.michaelpoole.co.uk

Michael Poole
sales | lettings | auctions



This three bedroom home will be perfect for first time buyers, young couples and families alike!

Notable features include gas central heating, UPVC double glazed windows and composite front door, off street parking on a block paved driveway, large garage, private rear garden with lawn and patio, sunroom to the rear, open plan lounge/diner and modern kitchen as well as a stylish walk in shower on the first floor.

The property comprises entrance, lounge/diner, kitchen and sunroom. On the first floor there are three bedrooms and a shower room. Externally there is ample off street parking to the front and to the rear there is an enclosed garden with lawn and a patio as well as access to the rear of the garage.

GROUND FLOOR

ENTRANCE HALL

With composite entrance door, radiator and staircase to the first floor.

LOUNGE/DINING ROOM - 6.7m (22') x 4m (13'1") increasing to 5m (16'5")

With electric flame effect fire, radiator and storage cupboard.

SUNROOM - 3.3m x 2.6m (10'10" x 8'6")

With radiator and UPVC patio door to the rear garden.

KITCHEN - 3.3m x 2.1m (10'10" x 6'11")

With woodgrain effect wall, drawer, and floor units, worktop, space for freestanding four ring gas cooker, integrated extractor fan, stainless steel sink, space for washing machine and radiator.

FIRST FLOOR

LANDING

With loft access.

BEDROOM ONE - 3.6m x 3.1m (11'10" x 10'2")

With radiator.

TO VIEW: Tel: 01642 254222

64-66 Borough Road, Middlesbrough, TS1 2JH

www.michaelpoole.co.uk



PRITCHETT ROAD, TS3 0NQ

BEDROOM TWO - 2.8m x 3.1m (9'2" x 10'2")

With radiator and fitted wardrobes.

BEDROOM THREE - 2.7m x 1.8m (8'10" x 5'11")

With radiator and storage cupboard.

SHOWER ROOM - 1.6m x 1.8m (5'3" x 5'11")

Comprising close coupled WC with hidden cistern, vanity wash hand basin with mixer tap, walk-in shower, radiator and cladded walls.

EXTERNALLY

PARKING, GARAGE & GARDEN

To the front there is off street parking for multiple cars on a block paved driveway leading to a large garage. To the rear there is a fence enclosed garden with lawn, patio and access to the rear of the garage.

AGENTS REF: - TM/LS/MID260088/26022026

Council Tax Band: B **Tenure:** Freehold

TO VIEW: Contact our Middlesbrough office on

Tel: **01642 254222**



PRITCHETT ROAD, TS3 0NQ



33 Pritchett Road

Approximate Gross Internal Area
915 sq ft - 85 sq m

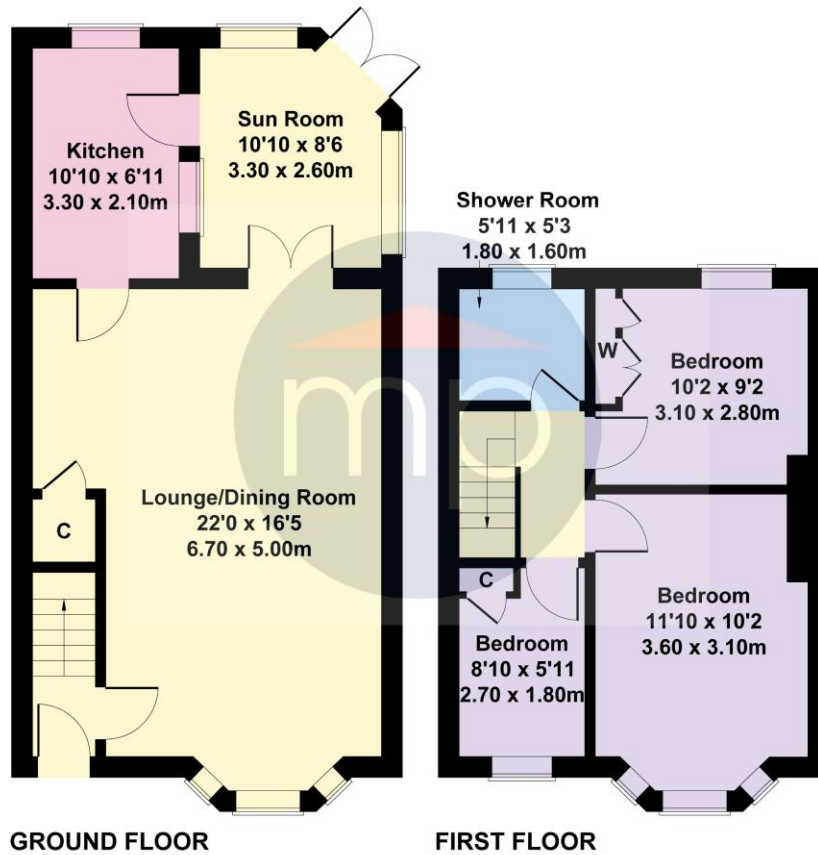

Not to Scale. Produced by The Plan Portal 2026
For Illustrative Purposes Only.

The information provided about this property does not constitute or form part of an offer or contract, nor may it be regarded as representations. All interested parties must verify accuracy and your solicitor must verify tenure and lease information, fixtures and fittings and, where the property has been recently constructed, extended or converted, that planning/building regulation consents are in place. All dimensions are approximate and quoted for guidance only, as are floor plans which are not to scale, and their accuracy cannot be confirmed. Reference to appliances and/or services does not imply that they are necessarily in working order or fit for the purpose. We offer our clients an optional conveyancing service, through panel conveyancing firms, via MWU and we receive on average a referral fee of one hundred and thirty pounds, only on completion of the sale. If you do use this service, the referral fee is included within the amount that you will be quoted by our suppliers. All quotes will also provide details of referral fees payable.



TO VIEW: Contact our Middlesbrough Office on Tel: **01642 254222**
64-66 Borough Road, Middlesbrough, TS1 2JH