

MARY JAQUES COURT, LONGLANDS, MIDDLESBROUGH, TS4 2QY



- ▲ Chain Free!
- ▲ Rare to The Market Three Bedroom Ground Floor Flat
- ▲ Superb Opportunity for First Time Buyers, Young Couples & Investors Alike!
- ▲ Modern & Stylish Shower Room Recently Fitted

- ▲ Just Off a Major Bus Route to Go Up to James University Hospital or Back into The Town
- ▲ Some Good Schooling Within Walking Distance
- ▲ UPVC Double Glazed Windows
- ▲ Ample Storage
- ▲ Good Sized Kitchen with Fitted Appliances

£99,950

www.michaelpoole.co.uk

Michael Poole
sales | lettings | auctions



Chain Free!

A superb opportunity for first time buyers, young couples and investors alike!

Location wise it's just off a major bus route to go up to James University Hospital or back into the town and there's also some good schooling within walking distance.

This three bedroom flat has had a modern and stylish shower room recently fitted and has ample storage as well as a good sized kitchen with fitted appliances modern electric radiators and UPVC double glazed windows.

The property comprises entrance hall, lounge, kitchen, three bedrooms and a shower room with a separate WC. Externally there is residents parking and communal gardens.

GROUND FLOOR

ENTRANCE HALL

With UPVC entrance door, electric radiator and storage cupboard.

LOUNGE - 4.8m x 3.5m (15'9" x 11'6")

With UPVC sliding door to the communal garden, electric radiator and large storage cupboard.

KITCHEN - 3.8m x 2.6m (12'6" x 8'6")

With woodgrain effect wall, drawer, and floor units, roll edge worktop, electric oven, four ring electric hob with stainless steel extractor fan, one and a half bowl sink unit, integrated under counter fridge, space for washing machine, space for dryer and electric radiator.

BEDROOM ONE - 4.1m x 3.5m (13'5" x 11'6")

With electric radiator and woodgrain effect laminate flooring.

BEDROOM TWO - 2m x 2.6m (6'7" x 8'6")

With electric radiator.

BEDROOM THREE - 3.5m x 2.7m (11'6" x 8'10")

With electric radiator and woodgrain effect laminate flooring.

SHOWER ROOM - 1.8m x 2.6m (5'11" x 8'6")

Comprising vanity wash hand basin with mixer tap, corner shower and chrome towel radiator.

TO VIEW: Tel: **01642 254222**
64-66 Borough Road, Middlesbrough, TS1 2JH

www.michaelpoole.co.uk



MARY JAQUES COURT, TS4 2QY



WC

With low level WC and vanity wash hand basin with mixer tap.

EXTERNALLY

Externally there is resident parking and communal gardens.

AGENTS NOTE:

Ground Rent: £10 PA

Service/Maintenance Charge: £20.51 PCM

AGENTS REF: - TM/LS/MID250639/09012026

Council Tax Band: A **Tenure:** Leasehold

TO VIEW: Contact our Middlesbrough office on

Tel: **01642 254222**



24 Mary Jaques Court

Approximate Gross Internal Area
829 sq ft - 77 sq m

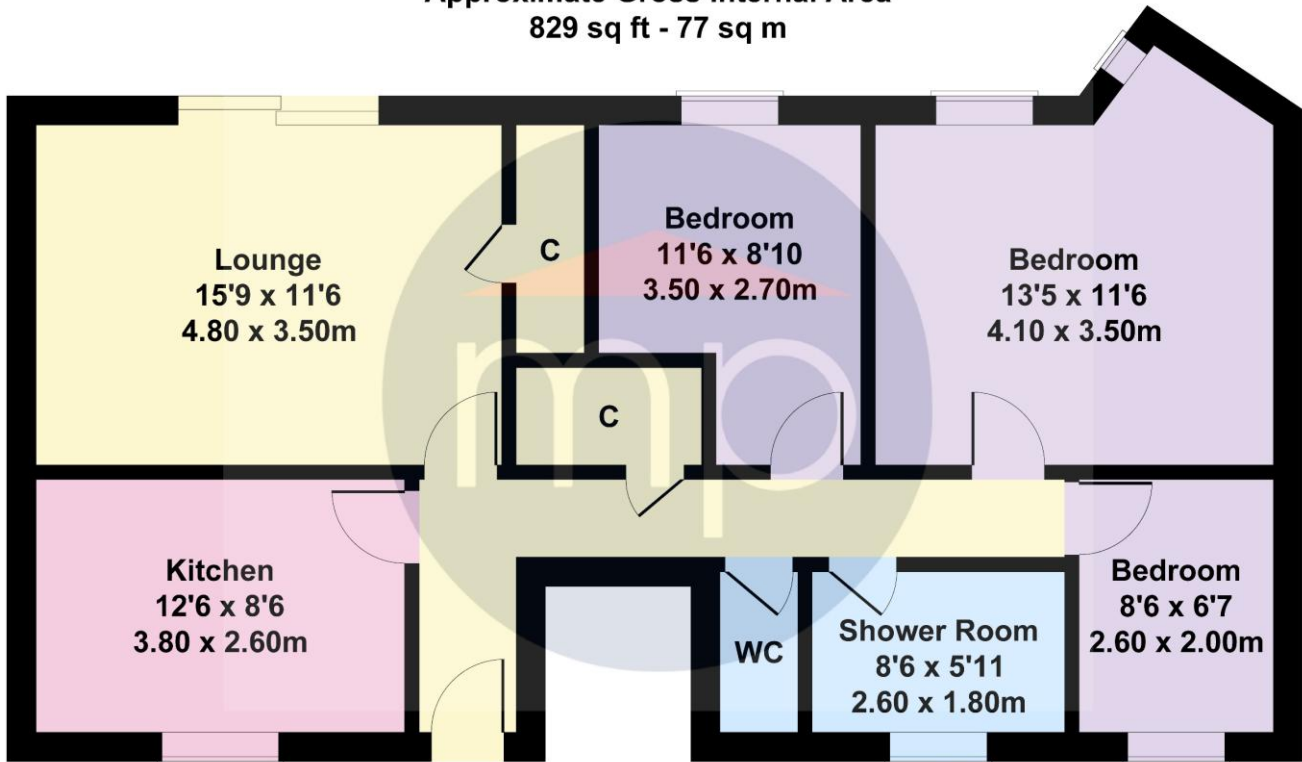

Not to Scale. Produced by The Plan Portal 2026
For Illustrative Purposes Only.

The information provided about this property does not constitute or form part of an offer or contract, nor may it be regarded as representations. All interested parties must verify accuracy and your solicitor must verify tenure and lease information, fixtures and fittings and, where the property has been recently constructed, extended or converted, that planning/building regulation consents are in place. All dimensions are approximate and quoted for guidance only, as are floor plans which are not to scale, and their accuracy cannot be confirmed. Reference to appliances and/or services does not imply that they are necessarily in working order or fit for the purpose. We offer our clients an optional conveyancing service, through panel conveyancing firms, via MWU and we receive on average a referral fee of one hundred and thirty pounds, only on completion of the sale. If you do use this service, the referral fee is included within the amount that you will be quoted by our suppliers. All quotes will also provide details of referral fees payable.



TO VIEW: Contact our Middlesbrough Office on Tel: **01642 254222**
64-66 Borough Road, Middlesbrough, TS1 2JH