

CHATTON CLOSE, PARK END, MIDDLESBROUGH, TS3 7JD



- ▲ Chain Free Sale!
- ▲ Recently Refurbished Three Bedroom Mid Terrace Home
- ▲ Ideal For First Time Buyers, Young Couples & Investors Alike!
- ▲ Modern Kitchen & Stylish Bathroom
- ▲ Handy Utility Room
- ▲ UPVC Double Glazed Windows & Exterior Doors
- ▲ Within Walking Distance of Good Schooling & Local Amenities

£100,000

www.michaelpoole.co.uk

Michael Poole
sales | lettings | auctions



Chain free sale!

Sure to be of interest to a range of buyers from first time purchasers to investors.

Notable features include gas central heating with a combi boiler, modern kitchen, stylish bathroom, UPVC double glazed windows and exterior doors and it is within walking distance of good schooling and local amenities.

The property comprises entrance hall, lounge, kitchen and utility room. On the first floor there are three bedrooms and a family bathroom.

GROUND FLOOR

ENTRANCE HALL

With UPVC entrance door and staircase to the first floor.

LOUNGE - 5.9m x 3.3m (19'4" x 10'10")

With radiator and French doors opening to the rear garden.

KITCHEN - 3.5m x 2.8m (11'6" x 9'2")

With grey high gloss wall, drawer, and floor units, woodgrain effect worktop, electric oven and grill, four ring electric hob with extractor fan, one and a half bowl sink unit with mixer tap, tiled flooring, splashback tiles, radiator and storage cupboard.

UTILITY ROOM - 2.4m x 2m (7'10" x 6'7")

With grey high gloss units, woodgrain effect roll edge worktop, UPVC door to the front, radiator and tiled flooring.

FIRST FLOOR

LANDING

With loft access and storage cupboard.

BEDROOM ONE - 2.5m x 3.6m (8'2" x 11'10")

With radiator.

BEDROOM TWO - 3.5m (11'6") reducing to 2.5m (8'2") x 3.3m (10'10")

With radiator.

TO VIEW: Tel: **01642 254222**
64-66 Borough Road, Middlesbrough, TS1 2JH

www.michaelpoole.co.uk



CHATTON CLOSE, TS3 7JD



BEDROOM THREE - 2.1m x 3m (6'11" x 9'10")

With radiator.

BATHROOM - 2.5m x 2.1m (8'2" x 6'11")

Modern white three-piece suite comprising close coupled WC, pedestal wash hand basin with mixer tap, bath with Triton Enrich shower unit, tiled walls and chrome towel radiator.

EXTERNALLY

GARDENS

To the front there is a small garden with fence boundary, lawn and pathway to the entrance door and to the rear there is an enclosed garden.

AGENTS REF: - TM/LS/MID200409/30102025

Council Tax Band: A **Tenure:** Freehold

TO VIEW: Contact our Middlesbrough office on

Tel: **01642 254222**



12 Chatton Close

Approximate Gross Internal Area
883 sq ft - 82 sq m

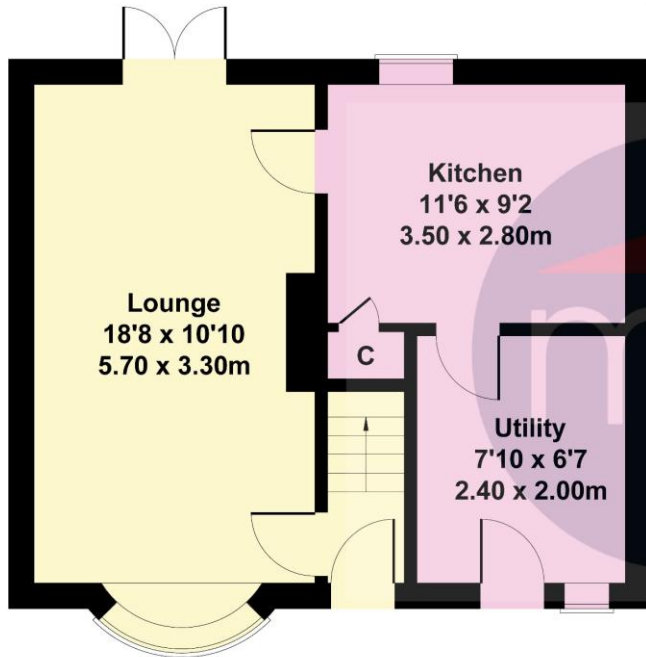

GROUND FLOOR

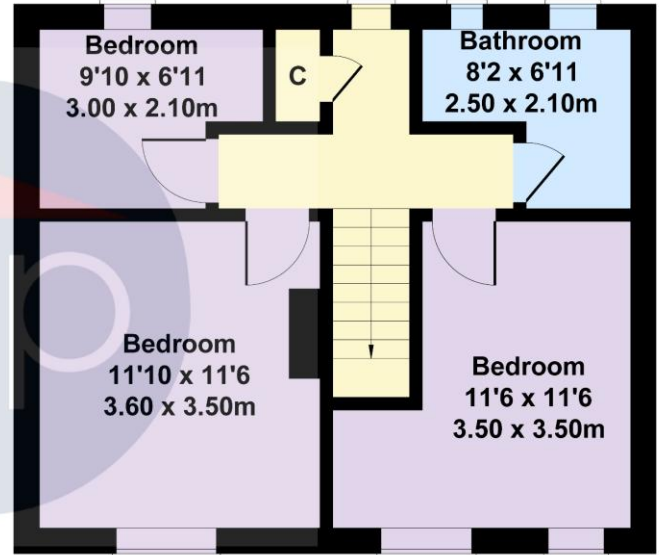

FIRST FLOOR

Not to Scale. Produced by The Plan Portal 2025
For Illustrative Purposes Only.

The information provided about this property does not constitute or form part of an offer or contract, nor may it be regarded as representations. All interested parties must verify accuracy and your solicitor must verify tenure and lease information, fixtures and fittings and, where the property has been recently constructed, extended or converted, that planning/building regulation consents are in place. All dimensions are approximate and quoted for guidance only, as are floor plans which are not to scale, and their accuracy cannot be confirmed. Reference to appliances and/or services does not imply that they are necessarily in working order or fit for the purpose. We offer our clients an optional conveyancing service, through panel conveyancing firms, via MWU and we receive on average a referral fee of one hundred and thirty pounds, only on completion of the sale. If you do use this service, the referral fee is included within the amount that you will be quoted by our suppliers. All quotes will also provide details of referral fees payable.



TO VIEW: Contact our Middlesbrough Office on Tel: **01642 254222**
64-66 Borough Road, Middlesbrough, TS1 2JH