

Need a Mortgage in principle to make offers? Call us now for quick assistance!
0121 775 0101



Do you need to sell? Start your journey now! Call us we can help.
0121 775 0101



22 Merecote Road
Solihull, B92 7EX
Offers in the Region of £350,000

SCAN FOR MORE INFO
SIZE - 1063 Sq Ft
TENURE - Freehold
COUNCIL TAX - Solihull Metropolitan Borough Council - C
BROADBAND - Upload Max 5500Mbps Download Max 5500Mbps
MOBILE SERVICES - EE - 89%, 3 - 85%, O2 - 84%, Vodafone - 84%
EPC - TBC
PARKING - For at least 2 Cars
FLOODRISK - Very Low
SERVICES - Mains
COVENANTS - N/A

A delightful semi-detached house offering a perfect blend of comfort and style, making it an ideal choice for first-time buyers, downsizers or investors. This property is not only a wonderful family home but also a fantastic opportunity to invest in a sought-after location. With its spacious layout, it is sure to appeal to a wide range of buyers.

FEATURES

- Extended Semi-Detached Property
- Fitted Kitchen
- Spacious Lounge/Dining Room with French Doors to Garden
- Two Double Bedrooms
- Third Single/Nursery/Home Office
- Bathroom with Separate W.C.
- East Facing Rear Garden
- Wide Block Paved Driveway
- Single Garage
- Convenient Location

Are you an investor interested in expanding your portfolio?

Call 0121 775 0101 to provide your investment criteria for alerts.



SCAN TO VIEW OUR WEEKLY FILMS & SUBSCRIBE

Sneak Peeks

Every week, we unveil "Sneak Peeks," a feature showcasing exclusive properties before they hit Rightmove and other platforms.

The Landlord Club

Join our Landlord Club for weekly updates on legislation, market trends, and our Letting Director's 'Investment Pick of the Week' for optimal ROI.

HTSPMD

Tune into 'How's The Solihull Property Market Dom' weekly for a quick, insightful snapshot of the market.

The Mortgage Update

Get weekly insights and the best deals with our Mortgage Update, your shortcut to navigating the complex mortgage landscape confidently.

Ground Floor

Approx. 55.9 sq. metres (602.2 sq. feet)

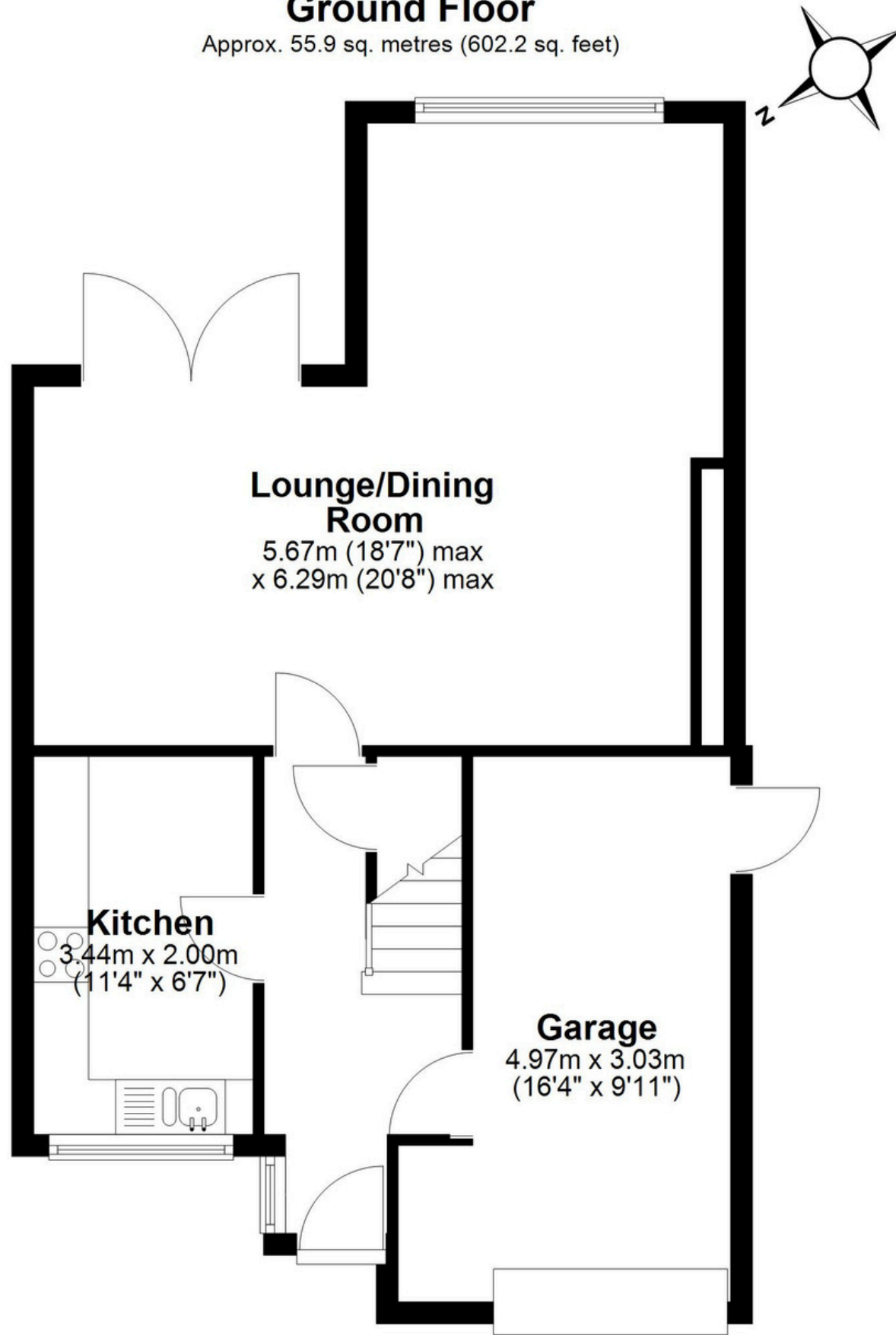

First Floor

Approx. 42.8 sq. metres (461.1 sq. feet)

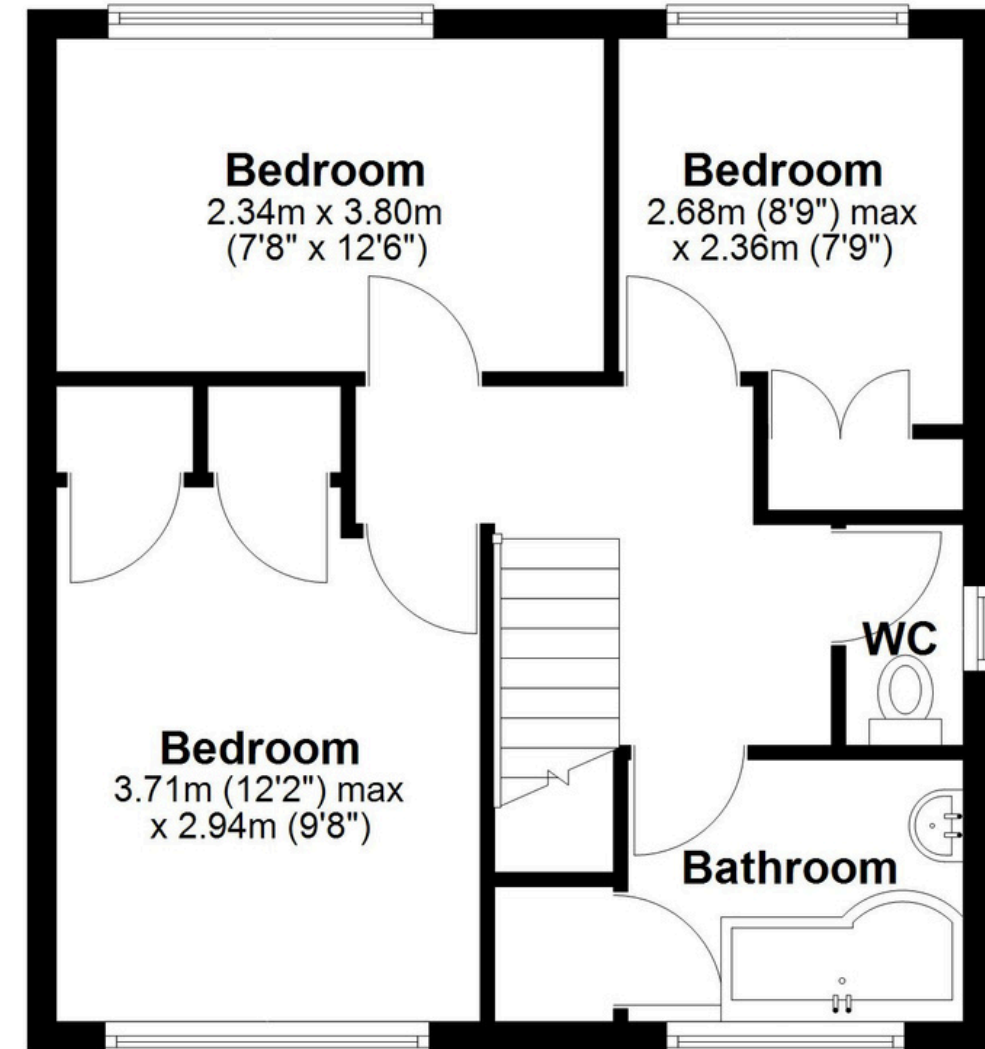

Total area: approx. 98.8 sq. metres (1063.3 sq. feet)

This floor plan is for illustration purposes only, this is not intended to be a measured/scaled survey or comply with RICS guidelines. All measurements (including total floor area) openings, orientation and floor area are approximate. No details are guaranteed, they cannot be relied upon for any purpose and do not form part of any agreement. A party must rely upon its own inspection(s). No responsibility is taken for any error, omission, or mis-statement.

Plan produced using PlanUp.