

Need a Mortgage in principle to make offers? Call us now for quick assistance!
0121 775 0101



Do you need to sell? Start your journey now! Call us we can help.
01564 777 314



Apartment 21 Ravenshaw Court

73 Four Ashes Road, Bentley Heath, B93 8NA
Offers in the region of £230,000

This exquisite ground floor apartment is designed exclusively for those aged 70 and over. Originally a show home, this property boasts an impressive 898 square feet of living space, meticulously maintained to a high standard, featuring underfloor heating throughout for added comfort. This apartment is not just a home; it is a lifestyle choice, offering comfort, security, and a vibrant community for its residents.

FEATURES

- Exclusively for the Over 70's
- Maintained to an Excellent Condition
- Lounge/Dining Room
- Modern Fitted Kitchen
- Principal Bedroom with Fitted Wardrobes
- Second Double Bedroom
- Four Piece Wet Room
- Guest Cloakroom
- Beautiful Communal Grounds
- Secure Gated Allocated Parking
- Residents Restaurant & Lounge

SCAN FOR MORE INFO

SIZE - 898 Sq Ft
TENURE - Leasehold with 115 years remaining
SERVICE CHARGE - £1,090.60 per calendar month
GROUND RENT - £255 paid half yearly
COUNCIL TAX - Solihull Metropolitan Borough Council - E
BROADBAND - Upload Max 1000Mbps Download Max 1800Mbps
MOBILE - EE - 82%, Vodafone - 78%, 3 - 76%, 02 - 74%
EPC - B - 85
PARKING - Allocated Parking
FLOODRISK - Very Low
SERVICES - Mains
COVENANTS - N/A

Are you an investor interested in expanding your portfolio?

Call 01564 777 314 to provide your investment criteria for alerts.



SCAN TO VIEW OUR WEEKLY FILMS & SUBSCRIBE

Sneak Peeks

Every week, we unveil "Sneak Peeks," a feature showcasing exclusive properties before they hit Rightmove and other platforms.

The Landlord Club

Join our Landlord Club for weekly updates on legislation, market trends, and our Letting Director's 'Investment Pick of the Week' for optimal ROI.

HTSPMD

Tune into 'How's The Solihull Property Market Dom' weekly for a quick, insightful snapshot of the market.

The Mortgage Update

Get weekly insights and the best deals with our Mortgage Update, your shortcut to navigating the complex mortgage landscape confidently.

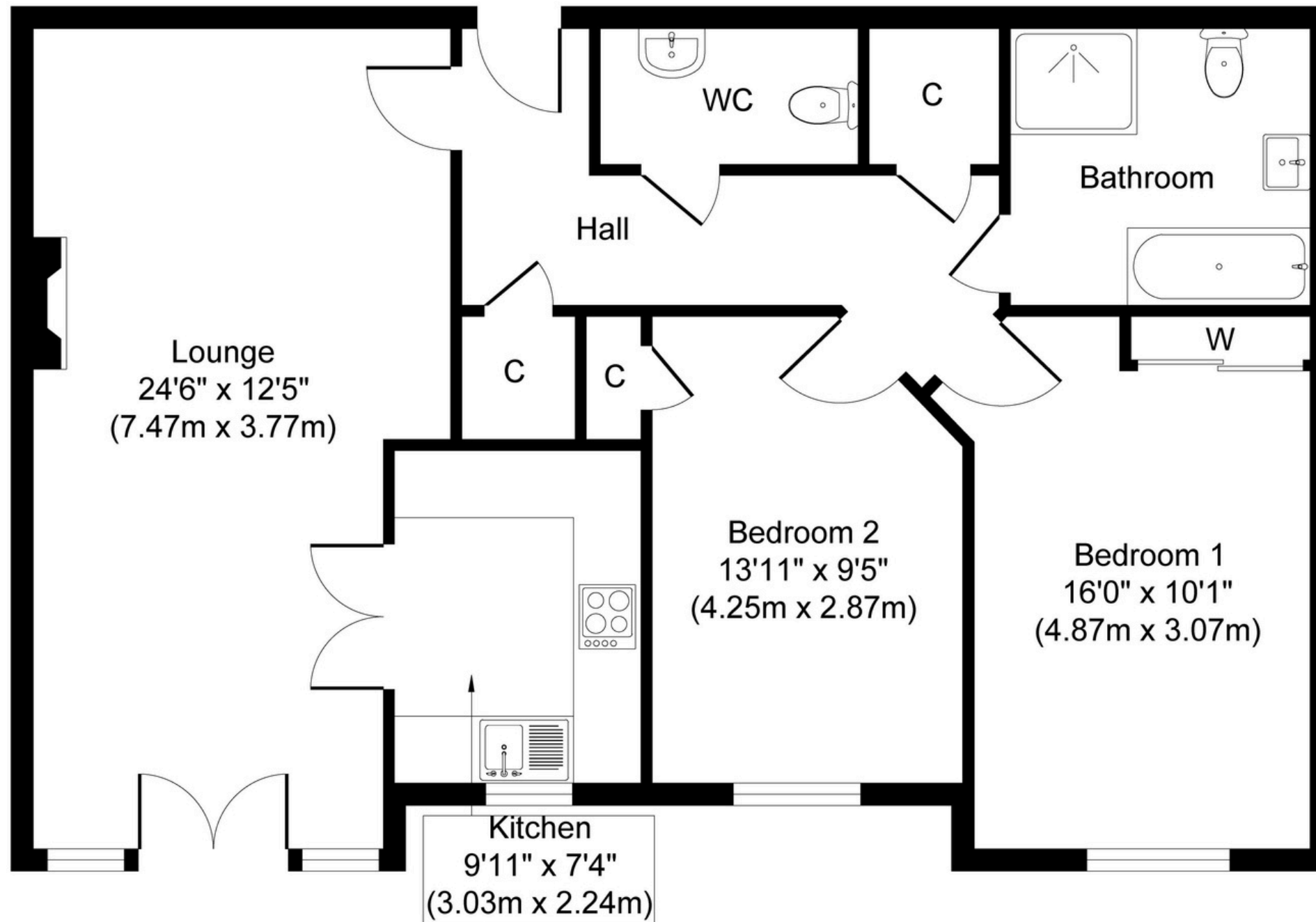

Approximate Floor Area
898 sq. ft
(83.50 sq. m)

Whilst every attempt has been made to ensure the accuracy of the floor plan contained here, measurements of doors, windows, rooms and any other items are approximate and no responsibility is taken for any error, omission, or mis-statement. The measurements should not be relied upon for valuation, transaction and/or funding purposes. This plan is for illustrative purposes only and should be used as such by any prospective purchaser or tenant.

The services, systems and appliances shown have not been tested and no guarantee as to their operability or efficiency can be given.

Copyright V360 Ltd 2026 | www.houseviz.com