

Need a Mortgage in principle
to make offers? Call us now
for quick assistance!
0121 775 0101

DM&Co.
SALES & LETTINGS



Do you need to sell?
Start your journey now!
Call us we can help.
01564 777 314

DM&Co.
SALES & LETTINGS



SCAN FOR MORE INFO
SIZE - 2107 Sq Ft
TENURE - Freehold
COUNCIL TAX - Solihull Metropolitan Borough Council - F
BROADBAND - Upload Max 1000Mbps
Download Max 1800Mbps
EPC - C - 75
PARKING - Driveway for up to 3 Cars
FLOODRISK - Very Low
SERVICES - Mains
COVENANTS - N/A

Are you an investor
interested in expanding your
portfolio?

Call **01564 777 314** to provide your
investment criteria for alerts.

3 Denton Croft

Dorridge, B93 8SE
Asking Price £830,000

A beautifully presented detached family home offering an exceptional living experience. The property has been thoughtfully extended to create spacious and inviting living spaces, perfect for modern family life. This remarkable home combines modern living with comfort and style, making it a perfect choice for families.

FEATURES

- A Beautifully Presented & Extended Detached Family Home
- Stunning Breakfast Kitchen with Bi-Fold Doors
- Open Plan Living/Dining/Family Room
- Study/Snug
- Self Contained 1 Bedroom Annexe with Kitchenette & En-Suite
- Principal Bedroom with Large En-Suite
- Three Further Double Bedrooms
- Modern Family Bathroom
- Landscaped Private Rear Garden
- Driveway Parking



SCAN TO **VIEW OUR**
WEEKLY FILMS &
SUBSCRIBE

Sneak Peeks

Every week, we unveil "Sneak Peeks," a feature showcasing exclusive properties before they hit Rightmove and other platforms.

The Landlord Club

Join our Landlord Club for weekly updates on legislation, market trends, and our Letting Director's 'Investment Pick of the Week' for optimal ROI.

HTSPMD

Tune into 'How's The Solihull Property Market Dom' weekly for a quick, insightful snapshot of the market.

The Mortgage Update

Get weekly insights and the best deals with our Mortgage Update, your shortcut to navigating the complex mortgage landscape confidently.

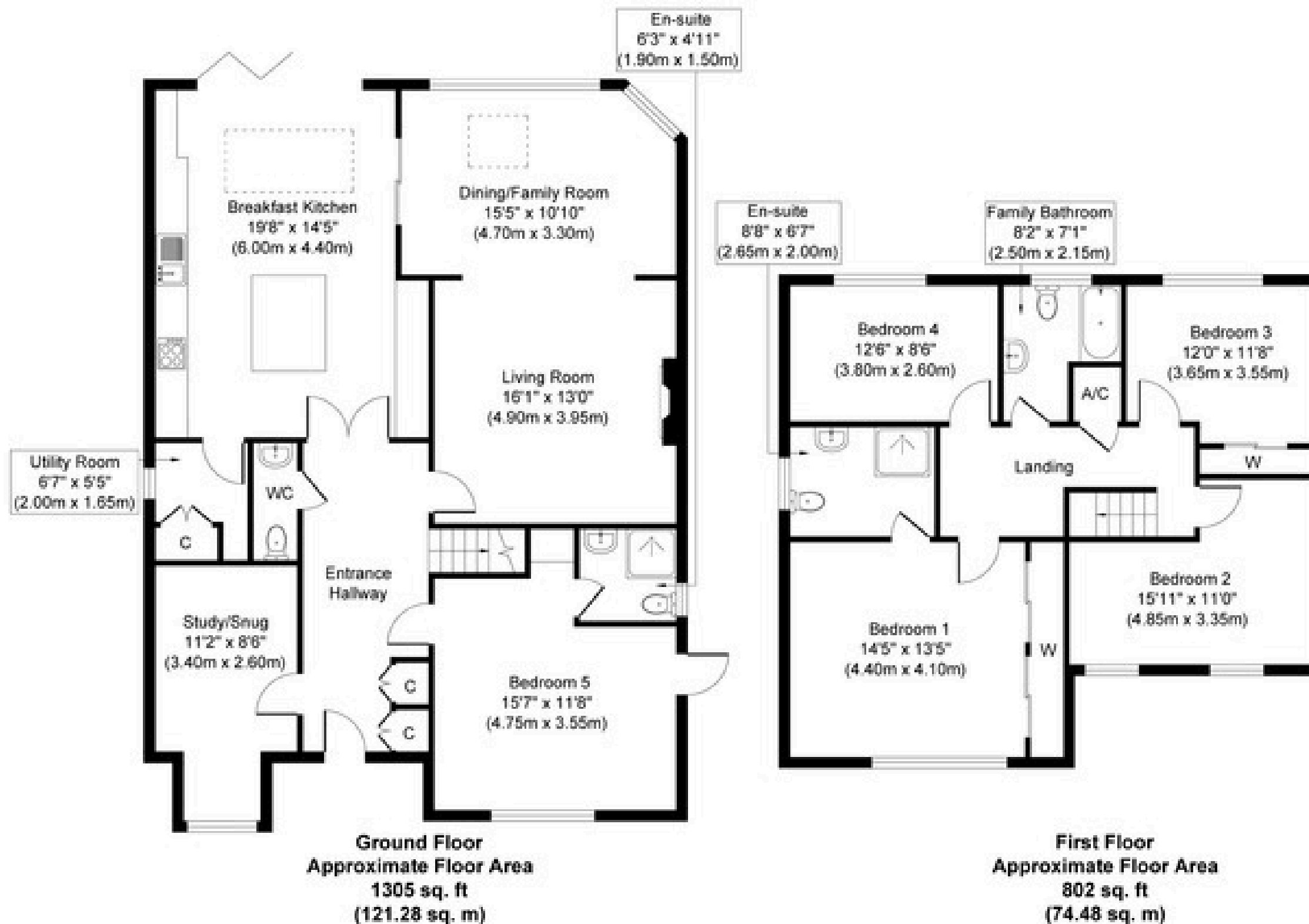

Whilst every attempt has been made to ensure the accuracy of the floor plan contained here, measurements of doors, windows, rooms and any other items are approximate and no responsibility is taken for any error, omission, or mis-statement. The measurements should not be relied upon for valuation, transaction and/or funding purposes. This plan is for illustrative purposes only and should be used as such by any prospective purchaser or tenant.

The services, systems and appliances shown have not been tested and no guarantee as to their operability or efficiency can be given.

Copyright V360 Ltd 2025 | www.houseviz.com