



Sea Lane, Rustington, BN16 2RT

Freehold

Detached family Home • Two Double Bedrooms • Secluded West-Facing Garden & Large Front Garden • Conservatory • Garage & Driveway • No Onward Chain! • Unique Seaside Property • Approx 0.3 miles to the Beach and Rustington Village Shops • Approx. 1275 sq. ft (118.3 sq. m)

Cooper Adams

Just 0.3 miles from both Rustington Village shops and the beach, this two double-bedroom detached house offers easy access to local amenities and the seafront. The rear garden provides space for an extension, subject to planning permission, and the property also benefits from a driveway with space for two cars, and a garage with light and power. Internally, the ground floor includes oak wooden flooring throughout, an open-plan kitchen/diner with integrated appliances, a living room with a bay window and gas fire place, conservatory and bathroom. The dining room was originally a ground floor bedroom, which can easily be reinstated if required. Upstairs are two double bedrooms, both with built-in and eaves storage, and a shower room. Additional features include a newly installed boiler approximately four years ago. The property itself is located just 0.7 miles from Rustington Community Primary School, making this home a perfect choice for both families or those looking to relocate close to the coast.

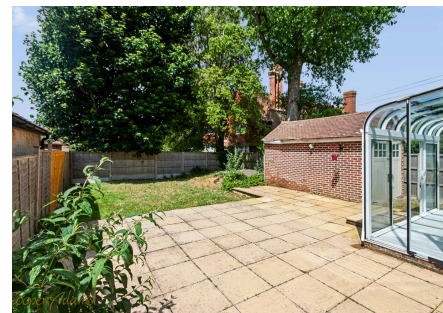

Rustington, a charming seaside village in West Sussex, offers a welcoming community, excellent shops, restaurants, and nearby leisure activities like sailing and golf. Its unspoiled pebble beach is perfect for peaceful walks, providing a serene escape just 0.3 miles away. Ideally located for all amenities also just 0.3 miles away, Rustington is a delightful place to live and unwind.



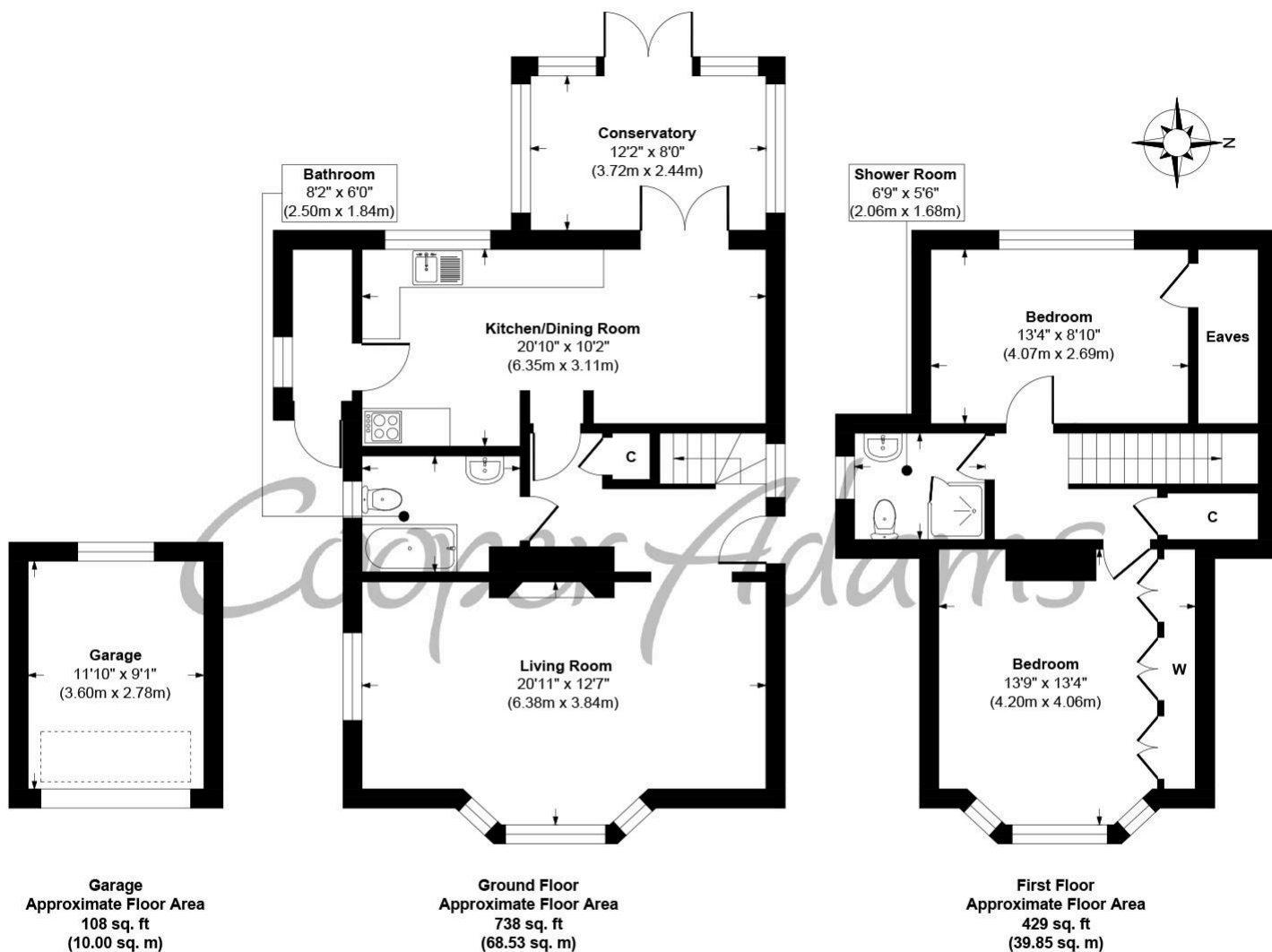

Sea Lane, Rustington
Approx. Gross Internal Floor Area 1275 sq. ft / 118.38 sq. m

Illustration for identification purposes only, measurements are approximate, not to scale

Copyright © Cooper Adams

Council Tax band: E, EPC Energy Efficiency Rating: D, EPC Environmental Impact Rating: E

Material Information includes important facts that may affect a buyer's decision to view or buy, such as tenure, restrictions, utilities, construction, and other key details. Full information for this property is available at www.cooper-adams.com. We may offer buyer services and receive referral benefits – details on request. All content is copyright Cooper Adams. Details and floor plans are for guidance only and don't form part of any contract. Measurements are maximums including bays and alcoves. Floor plan sizes are approximate. Images, maps and plans are not to scale. Appliances/services not tested. Cooper Adams Estates Ltd, Bishopstone. Reg No: 07127482. VAT No: 982847172.

Lettings | Sales | Free valuations | Land & New Homes | Mortgages

FULL DETAILS OF THE MATERIAL INFORMATION ARE ON OUR WEBSITE - VIEWING STRICTLY BY APPOINTMENT WITH COOPER ADAMS

FOR MORE PHOTOS AND TO BOOK A VIEWING VISIT OUR WEBSITE - Tel: 01903 791 792 - www.cooper-adams.com