



341 Hall Lane
Whitwick, Coalville, LE67 5PH

£260,000



3



1



2



Brief Description

Located on Hall Lane in the popular village of Whitwick, this delightful three-bedroom DETACHED BUNGALOW presents an excellent opportunity for those seeking a comfortable and versatile home. The property has been well looked after, with POTENTIAL for personal touches and improvements, and is offered with NO UPWARD CHAIN, ensuring a smooth transition for prospective buyers.

Upon entering, you are greeted by a welcoming entrance porch that leads into a SPACIOUS and accessible entrance hall. The LIVING ROOM, located at the front of the property, is a BRIGHT AND AIRY space, featuring a cosy fireplace with a gas fire, perfect for those chilly evenings.

The heart of the home is the OPEN-PLAN KITCHEN and dining area, designed for both functionality and socialising. The kitchen boasts a range of wall and base units, an integrated double oven and grill, and a convenient access door to the CONSERVATORY. The tiled splashback adds a touch of elegance, while the concealed Worcester Bosch combination boiler ensures modern efficiency. The DINING AREA, accessible via an archway, provides a seamless flow for entertaining. The conservatory offers a lovely vantage point over the well-maintained garden, with a door leading directly outside.

The bungalow comprises three WELL-PROPORTIONED BEDROOMS, allowing for flexible use according to your needs. The modern shower room features a MODERN three-piece suite, including a double walk-in shower, WC, and hand basin, complemented by tiled walls and vinyl flooring.

Externally, the property boasts a gravel driveway providing AMPLE OFF-ROAD PARKING, along with a gravel front garden for additional space. The SUBSTANTIAL REAR GARDEN is a true highlight, featuring a combination of paved patios, pathways, and a lush lawn, surrounded by planted borders, shrubs, and mature trees. A single DETACHED GARDEN with side access and twin timber doors completes this appealing package.

This bungalow is a wonderful opportunity and is not to be missed.





ON THE INSIDE

Entrance Porch

Entrance Hall
12'4" x 4'3" (3.76m x 1.30m)

Living Room
10'10" x 14'10" (3.30m x 4.52m)

Dining Area
10'9" x 8'8" (3.28m x 2.64m)

Kitchen
10'9" x 8'1" (3.28m x 2.46m)

Conservatory
12'3" x 7'6" (3.73m x 2.29m)

Shower Room
5'7" x 6'11" (1.70m x 2.11m)

Bedroom 1
8'10" x 11'9" (2.69m x 3.58m)

Bedroom 2
9'1" x 9'9" (2.77m x 2.97m)

Bedroom 3
9'4" x 8'8" (2.84m x 2.64m)

ON THE OUTSIDE

Rear Garden

Front Garden

Driveway

Single Garage



Floor Plan

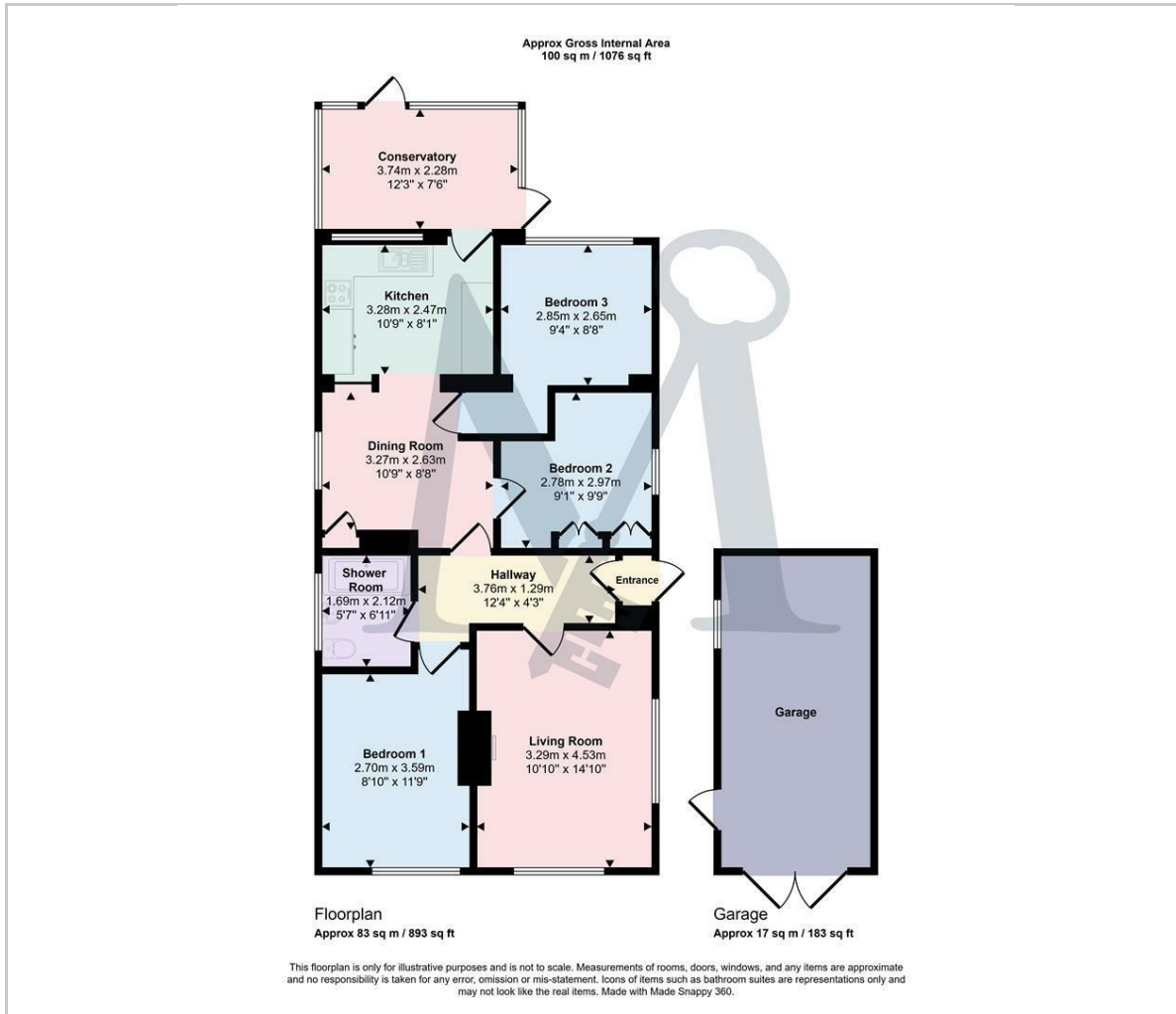

Viewing

Please contact our Maynard Estates Office on 01530 682886 if you wish to arrange a viewing appointment for this property or require further information.

These particulars, whilst believed to be accurate are set out as a general outline only for guidance and do not constitute any part of an offer or contract. Intending purchasers should not rely on them as statements of representation of fact, but must satisfy themselves by inspection or otherwise as to their accuracy. No person in this firm's employment has the authority to make or give any representation or warranty in respect of the property.

2-4 North Street, Whitwick, Coalville, Leicestershire, LE67 5HA
Tel: 01530 682886 Email: sales@maynardestates.co.uk maynardestates.co.uk

Area Map

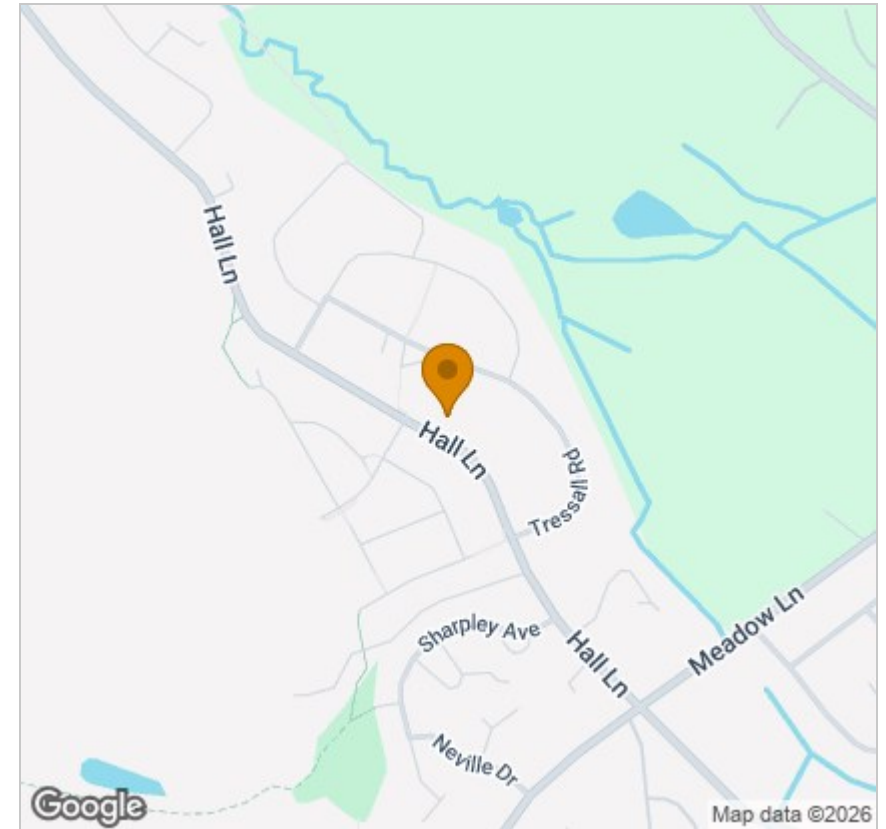

Energy Efficiency Graph

