



3 Town Orchard, St. Neots, PE19 5YJ

£400,000

Located in Southoe St Neots, is this detached four bedroom family home, with off road parking and a garage.

Step inside a welcoming entrance hall leading through to a bright lounge and dining area. Sliding patio doors allow plenty of natural light to flood the space while offering lovely views over the landscaped garden. The room is thoughtfully zoned, with ample space for a dining table positioned to enjoy the garden outlook.

The kitchen is fitted with wooden cabinets and metro tiles, with space for a washing machine, dishwasher and fridge freezer. Adjacent is an additional reception room, currently utilised as a spacious home office. This area offers excellent potential to be opened up and transformed into a larger kitchen and dining space. Also accessed from the hallway is a convenient WC and an understairs storage cupboard.

Floor Plan

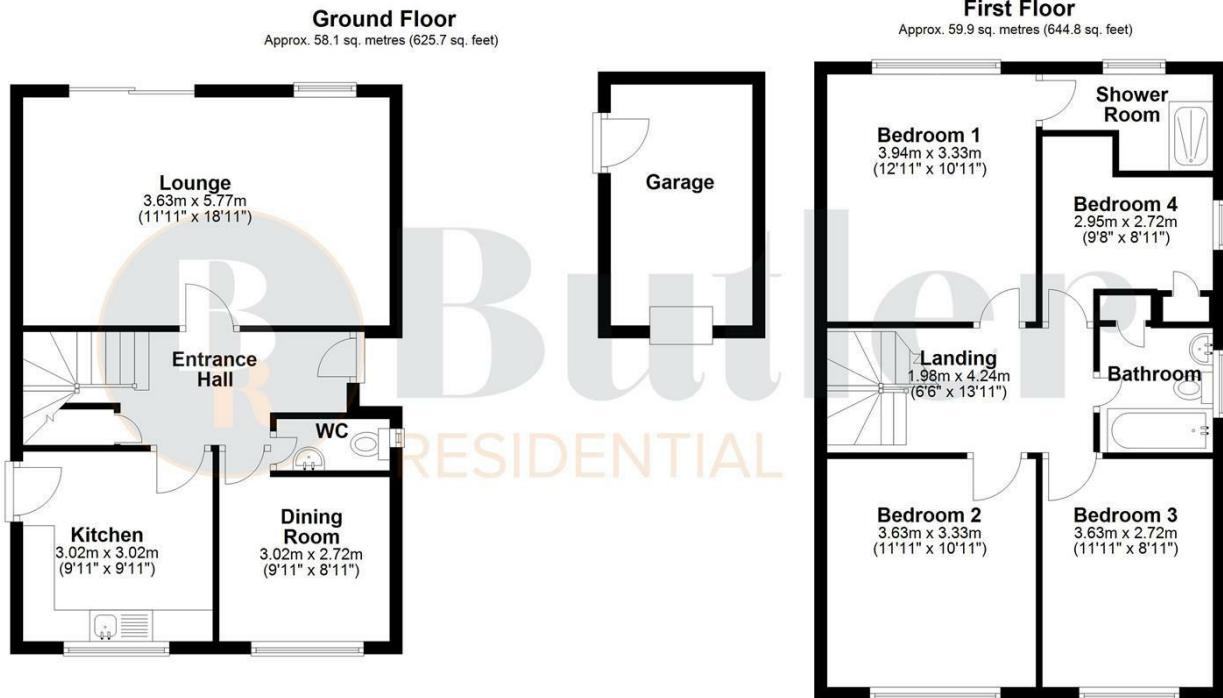

Total area: approx. 118.0 sq. metres (1270.6 sq. feet)

Area Map

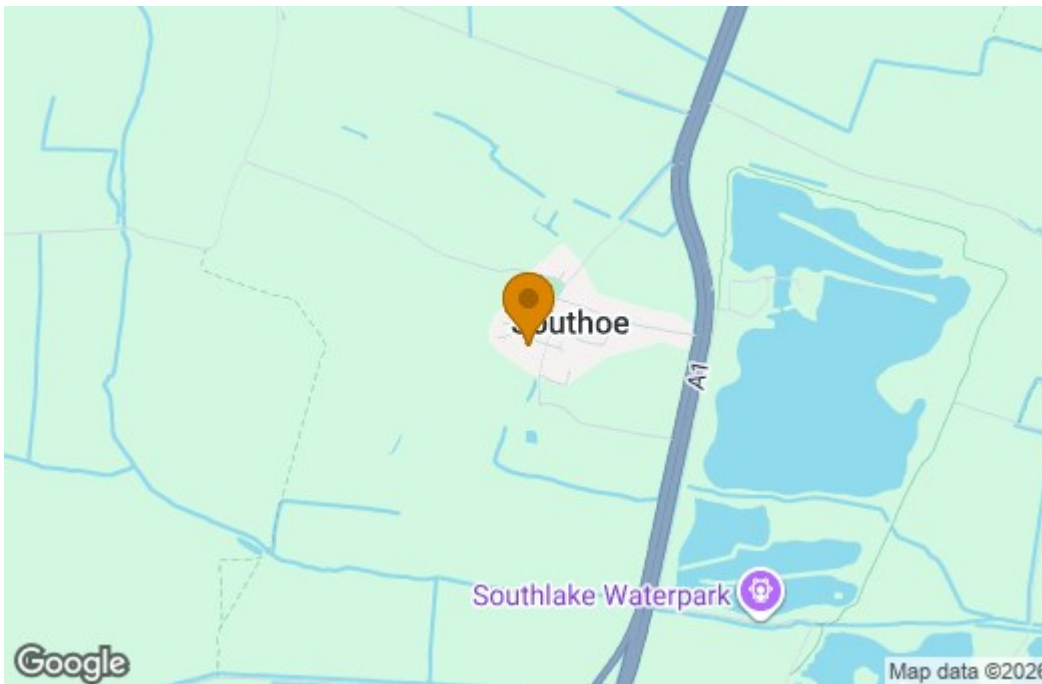

Energy Efficiency Graph

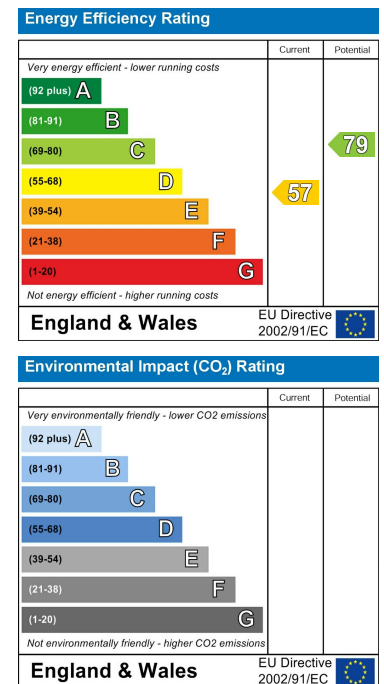

These particulars, whilst believed to be accurate are set out as a general outline only for guidance and do not constitute any part of an offer or contract. Intending purchasers should not rely on them as statements of representation of fact, but must satisfy themselves by inspection or otherwise as to their accuracy. No person in this firm's employment has the authority to make or give any representation or warranty in respect of the property.