



BARRETT
—ESTATES—



2 Manor Road, Westcliff-on-Sea, Essex, SS0 7SS

Asking Price: £1,250,000

Freehold

2 Manor Road, Westcliff-on-Sea, Essex, SS0 7SS

Rarely does a property of this calibre come to market, offering panoramic estuary views, spacious living (over 3100 square feet approx), and a prime location. Discover coastal living at its finest with this exceptional fully detached residence, enviably located just a stone's throw from the Westcliff seafront. Boasting breathtaking panoramic estuary views, this substantial home combines elegance, space, and convenience—perfect for family life or entertaining in style.

Set behind secure gates, this property offers a large private driveway with parking for multiple vehicles and access to a double garage with electric door.

Inside, the generous layout includes four versatile reception rooms, ideal for formal entertaining, relaxed family living, or even home working. With four well-proportioned bedrooms, including two with en-suite bathrooms, there's no shortage of comfort and privacy. In total, the property offers three bathrooms and four toilets, ensuring practicality for busy households.

Further benefiting from being situated within Just 0.2 miles (5-minute walk) to Westcliff Station – ideal for commuters.

This is a unique opportunity to own a stunning home in one of Westcliff-on-Sea's most sought-after locations, providing a rare combination of space, security, and sea views.

Early viewing is strongly advised.

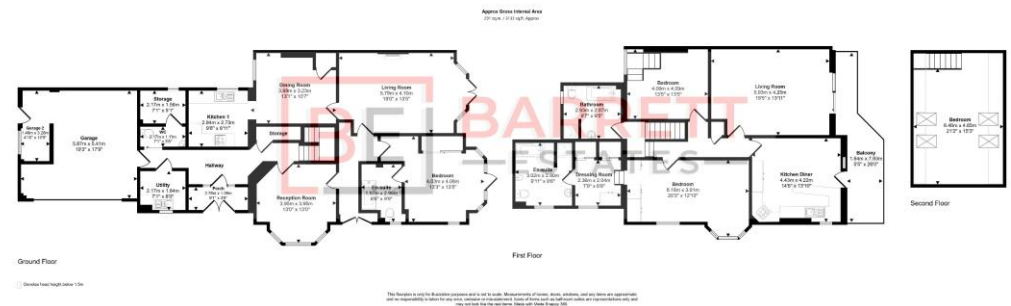

EPC: D (60)
Council Tax Band:



