



BARRETT
—ESTATES—



Flat 3, Webster Court, Rayleigh, Essex, SS6 8JQ

Asking Price: £165,000
Leasehold

Flat 3, Webster Court, Rayleigh, Essex, SS6 8JQ

Take a look inside this one bedroom first floor apartment situated in the heart of Rayleigh High Street. Sold with No Onward Chain.

The home benefits from a fully fitted kitchen with appliances, modern bathroom suite and a good size lounge / diner.

Lease Length - 100 Years / Service Charge - approx £850.00 p.a / Ground Rent - £100 p.a

Council Tax Band - A

Floor Area - 333 ft² / 31 m²

Electricity Supply - Mains standard

Gas Supply - None

Water Supply - Mains standard

Sewerage - Mains standard

Heating - Electric heating

Broadband

- Basic 13 Mbps
- Superfast 80 Mbps

Mobile Signal Coverage

- EE Average
- Vodafone Good
- Three Fair
- O2 Good

Satellite / Fibre Availability

- BT Yes
- Sky Yes
- Virgin No

Flood Risk - Very Low

Conservation Area - Rayleigh CA

Approx Gross Internal Area
31 sq m / 332 sq ft

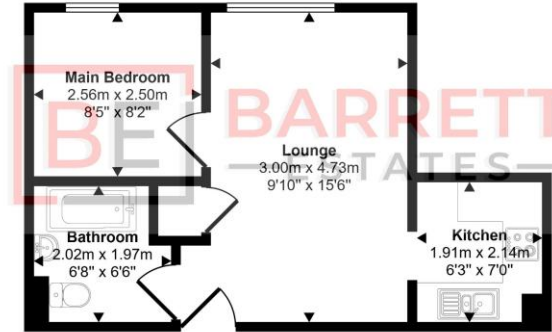

Floorplan

This floorplan is only for illustrative purposes and is not to scale. Measurements of rooms, doors, windows, and any items are approximate and no responsibility is taken for any error, omission or mis-statement. Icons of items such as bathroom suites are representations only and may not look like the real items. Made with Made Snappy 360.

EPC: B (84)
Council Tax Band: A

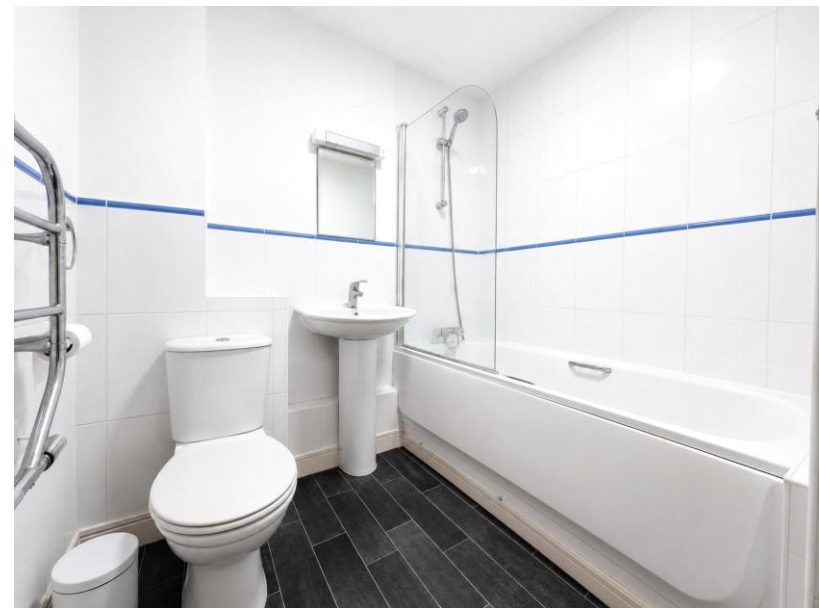

Score	Energy rating	Current	Potential
92+	A		
81-91	B	84 B	84 B
69-80	C		
55-68	D		
39-54	E		
21-38	F		
1-20	G		