



## 6 Bramble Close

Barns Green, Horsham, West Sussex, RH13 0AW

[www.alexharveyestateagents.co.uk](http://www.alexharveyestateagents.co.uk)



**Alex Harvey**  
A passion for property

## 6 Bramble Close

A modern three-bedroom semi-detached family home built by Berkeley Homes and situated on a mature plot with an integral garage and driveway parking. Located in the popular village of Barns Green, close to local amenities and just a short drive to Horsham town with shopping centre and mainline railway station.

- THREE BEDROOMS
- TWO BATH/SHOWER ROOMS
- OPEN PLAN SITTING/DINING ROOM
- LUXURIOUS ORANGERY
- INTEGRAL GARAGE AND DRIVEWAY
- CONVENIENT VILLAGE LOCATION



This beautifully presented contemporary home offers plentiful accommodation with ample natural light throughout and set on a good-sized plot with driveway and garage parking.

The welcoming hallway provides access to the kitchen/breakfast room, sitting/dining room, stairwell to the first floor, and the downstairs cloakroom. The kitchen/breakfast room is a lovely bright space with practical yet stylish wood-effect flooring and a bay window with space for a small table & chairs.

The kitchen has been fitted with modern units with touch open/close, wood-effect worktops and finished with under-unit lighting. The open plan sitting/dining room offers a versatile space with a useful understairs cupboard and double doors leading into the garden. From the dining area there is a window wall with double doors leading into the luxurious orangery with tiled flooring and glorious lantern roof. The orangery also has doors leading into the garden and an internal door providing access to the integral garage.

The stairwell leads to the first-floor landing with access to two double bedrooms, family bathroom and a single bedroom. Bedroom one has the benefit of built-in wardrobes and an ensuite shower room. The single third bedroom is currently used as a study, ideal for those working from home.



## OUTSIDE

The property is approached via a footpath with lawn either side leading to the front door. To the left is the driveway, with parking for two cars, leading to the garage with power & lighting. A gated, covered pathway leads to the rear garden which is mainly laid to lawn with flower beds and a generous patio, perfect for alfresco dining and summertime entertaining.

Barns Green is a village in the Horsham district of West Sussex. The village offers a variety of activities and has an active community. There is a village store with post office, primary school, public house, social club and sports facilities including cricket, tennis, football, rugby and stoolball. For the commuter, Christs Hospital railway station is less than 3 miles away and for more extensive facilities and a mainline railway station, Horsham is around 5 miles away. An alternative is Billingshurst mainline railway station, which is around 4.5 miles away.



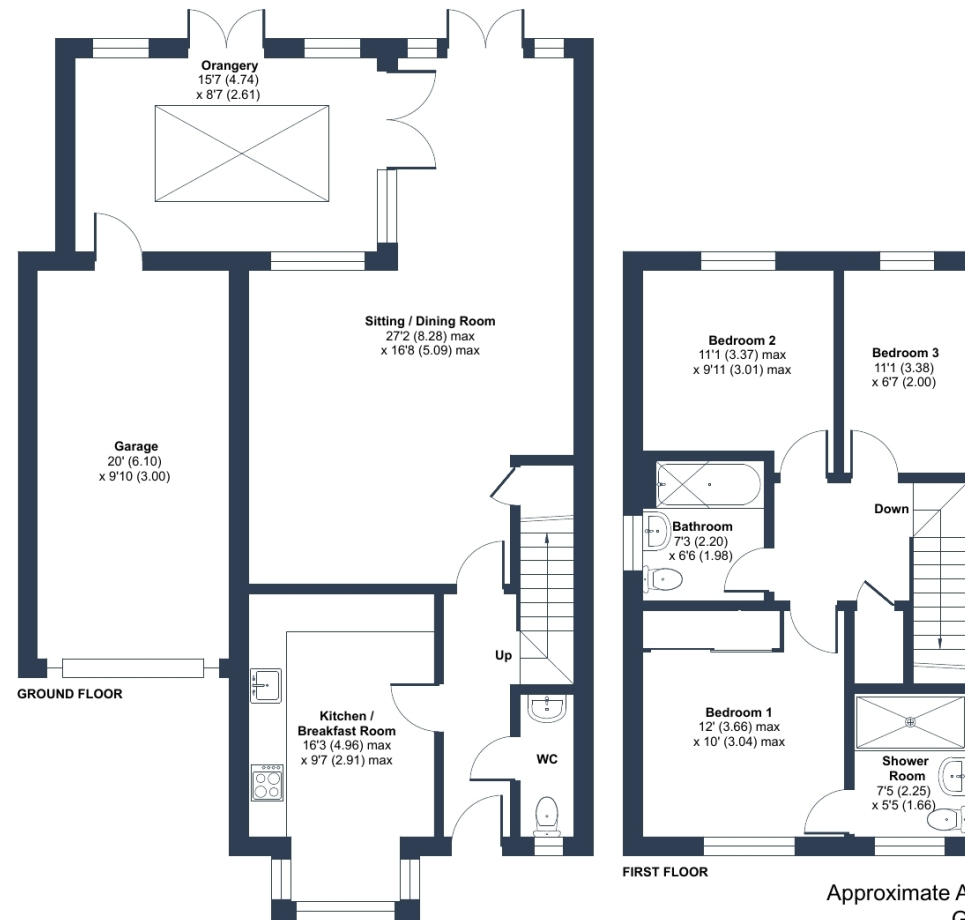

Approximate Area = 1269 sq ft / 117.8 sq m

Garage = 197 sq ft / 18.3 sq m

Total = 1466 sq ft / 136.1 sq m

For identification only - Not to scale

 Floor plan produced in accordance with RICS Property Measurement 2nd Edition, Incorporating International Property Measurement Standards (IPMS2 Residential). © nlcocom 2026. Produced for Alex Harvey Estate Agents. REF: 1435384

**Agents Notes:** Measurements, areas and distance are only approximate. These are to only be used for guidance and are intended to give a fair overall summary of the property. They do not form part of any contract or offer and should not be relied upon as a statement or representation of fact. Photographs may include views of the local area and lifestyle shots. No undertaking is given as to the structural condition of the property, or any necessary consents or the operating ability or efficiency of any service linked to the property, system or appliance.

#### Services

Electricity, mains gas, water and mains drainage are currently connected to the property.  
Council Tax Band D. EPC-C. Agents Note: An annual service charge is payable for this property.

**Viewings by appointment only** - Please contact Alex Harvey Estate Agents on **01403 784110** or email [alex@alexharveyestateagents.co.uk](mailto:alex@alexharveyestateagents.co.uk) | [www.alexharveyestateagents.co.uk](http://www.alexharveyestateagents.co.uk)

