

BRUNTON

RESIDENTIAL



STONEMAN COURT, HAZLERIGG, NEWCASTLE UPON TYNE, NE13

£2,350 Per Month

BRUNTON

RESIDENTIAL





BRUNTON

RESIDENTIAL



BRUNTON

RESIDENTIAL



Available 24/07/2026 - Rent £2,350pcm.

Impressive four-bedroom detached family home occupying a generous plot within the popular residential area of Hazlerigg, offering spacious and modern accommodation ideally suited to contemporary family living.

Hazlerigg remains a highly regarded residential location, conveniently positioned for access to Newcastle city centre, Gosforth, and major road links including the A1 and A69. The area offers a strong sense of community alongside nearby schooling, local amenities, and excellent access to surrounding countryside, Newcastle International Airport, and the wider North East region.

BRUNTON

RESIDENTIAL



BRUNTON

RESIDENTIAL

The internal accommodation comprises: an entrance hallway with staircase rising to the first-floor landing, access to a convenient ground floor WC, and a useful store room. To the front elevation is a substantial lounge featuring a large bay window allowing for excellent natural light and creating a bright and spacious main reception area. To the rear of the property is an impressive open-plan kitchen/dining room extending across the width of the home and forming the heart of the property. The space is fitted with a comprehensive range of wall and base units, complemented by a central island, generous dining space, and French doors opening directly onto the rear garden, creating an excellent environment for modern family living and entertaining.

Leading from the kitchen is a useful utility room providing additional storage, appliance space, external access, and internal access into the integral garage, whilst a separate family room offers versatile additional living accommodation ideal as a snug, playroom, or home office. The ground floor layout is particularly well suited to growing families, benefitting from spacious and well-balanced accommodation throughout.

To the first floor, the landing provides access to four well-proportioned bedrooms, including a generous principal suite featuring a dressing area and en-suite shower room. A further bedroom also benefits from en-suite facilities, whilst the remaining bedrooms are served by a modern family bathroom fitted with a bath, separate shower, WC, and wash hand basin.

Externally, the property occupies a generous plot with driveway parking, integral garage, and an enclosed rear garden featuring lawned and patio seating areas.



BRUNTON

RESIDENTIAL

TENURE :

LOCAL AUTHORITY : Newcastle CC

COUNCIL TAX BAND : F

EPC RATING : B

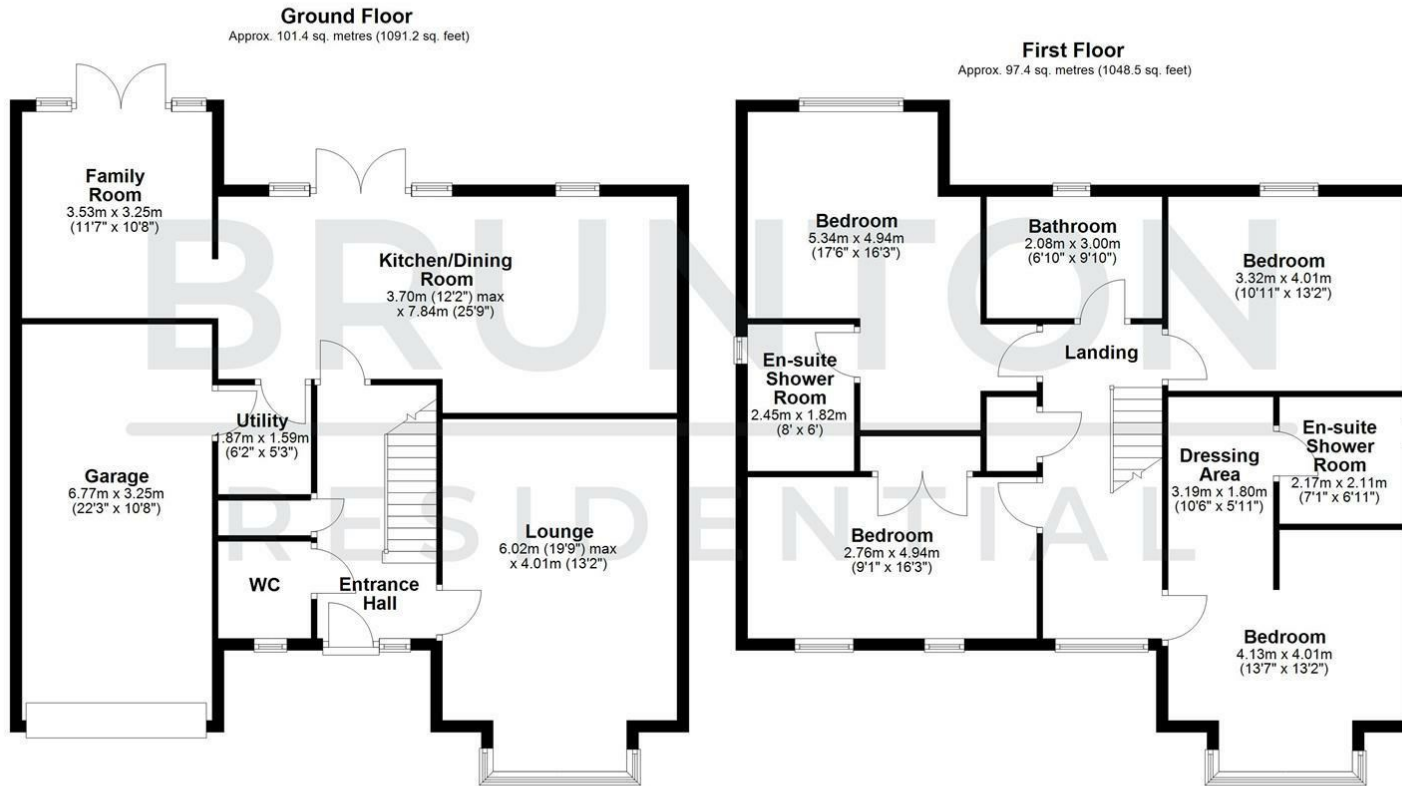

Total area: approx. 198.8 sq. metres (2139.7 sq. feet)

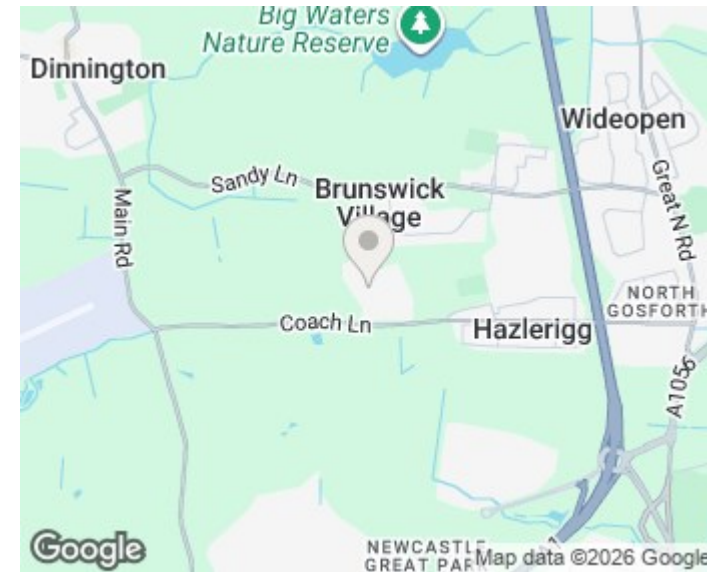

Energy Efficiency Rating		Current	Potential
Very energy efficient - lower running costs			
(92 plus) A			93
(81-91) B		85	
(69-80) C			
(55-68) D			
(39-54) E			
(21-38) F			
(1-20) G			
Not energy efficient - higher running costs			
England & Wales		EU Directive 2002/91/EC	

Environmental Impact (CO ₂) Rating		Current	Potential
Very environmentally friendly - lower CO ₂ emissions			
(92 plus) A			
(81-91) B			
(69-80) C			
(55-68) D			
(39-54) E			
(21-38) F			
(1-20) G			
Not environmentally friendly - higher CO ₂ emissions			
England & Wales		EU Directive 2002/91/EC	