

BRUNTON

RESIDENTIAL



CITY QUADRANT, CITY CENTRE, NE1

£1,750 Per Month

BRUNTON

RESIDENTIAL





BRUNTON

RESIDENTIAL



BRUNTON

RESIDENTIAL



Available 11/08/2026 - Rent £1,750pcm - Panoramic Views - Within City Quadrant Development -
Opposite Centre of Life - Intergrated Appliances - Very Popular Location - Available Unfurnished

BRUNTON

RESIDENTIAL



BRUNTON

RESIDENTIAL

6th FLOOR PENTHOUSE - PANORAMIC CITY VIEWS - ROOF TOP TERRACE

Brunton Residential are delighted to offer to the market for rent, this luxurious 2-bed penthouse apartment situated in the City Quadrant development.

This stunning landmark development is a blend of luxurious apartments, retail space and office space. located at the western entrance to Newcastle City Centre within 150 metres of Newcastle's Central Train Station. The apartment is also within walking distance to St. James' Park, the region's Premiership Football stadium and home of Newcastle United Football Club, as well as various bus links, Metro Stations, the International Centre for Life and retail stores.

Situated on the 6th floor accessible via lifts in the main reception, the apartment briefly comprises of, entrance hall leading to a vast open plan Living Room/Dining Room/Kitchen area, Leading to the outdoor rooftop terrace with panoramic city views. There is the main bedroom with an en-Suite Shower Room and balcony, a second spacious bedroom and a family bathroom.

Call the team today to arrange a viewing on 0191 236 8347



BRUNTON

RESIDENTIAL

TENURE :

LOCAL AUTHORITY : Newcastle upon Tyne

COUNCIL TAX BAND : D

EPC RATING : C

Sixth Floor
Approx. 102.5 sq. metres (1103.0 sq. feet)

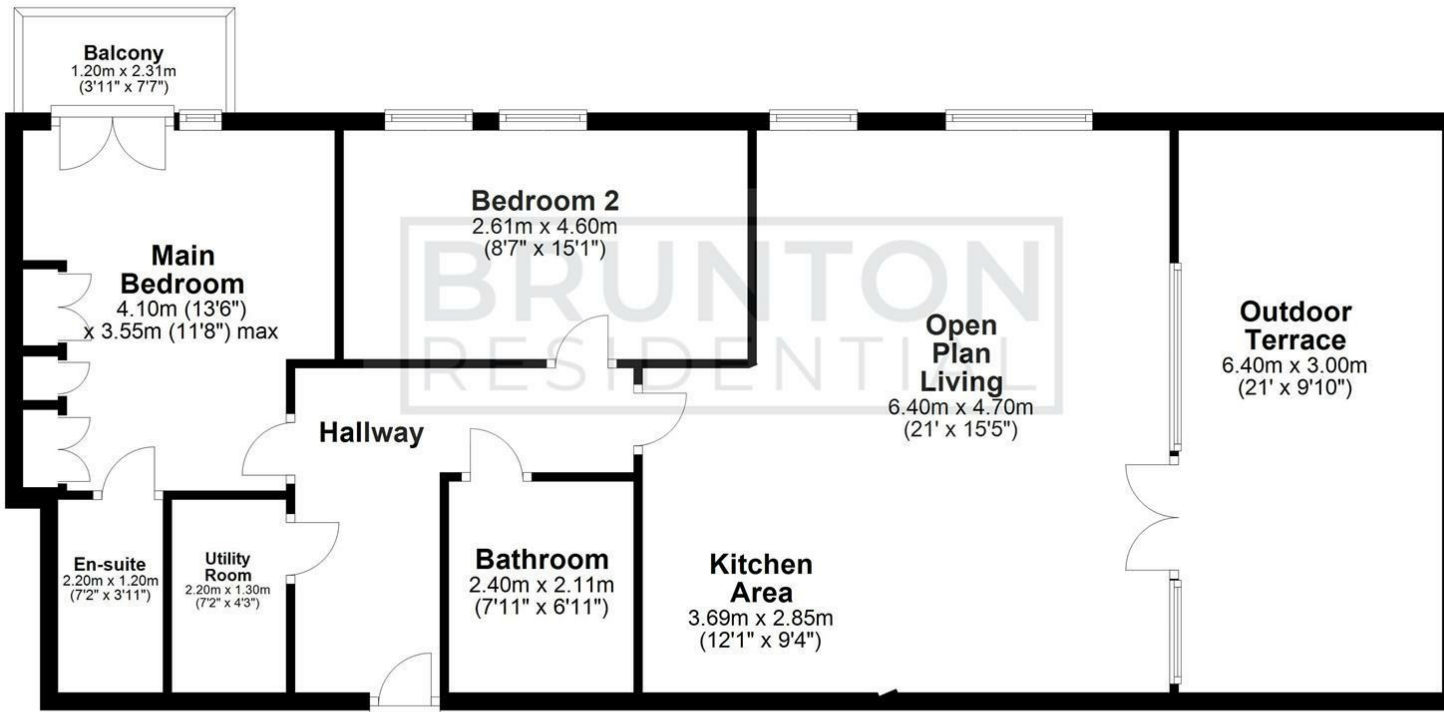

Total area: approx. 102.5 sq. metres (1103.0 sq. feet)

All measurements are approximate and are for illustration only.
Plan produced using PlanUp.

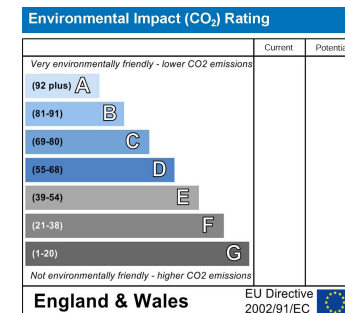
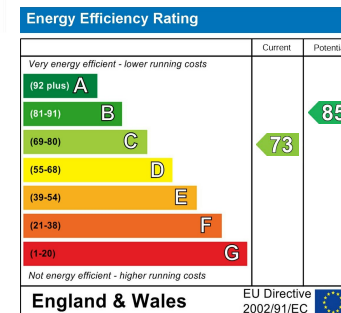

England & Wales

EU Directive 2002/91/EC

England & Wales

EU Directive 2002/91/EC