

BRUNTON

RESIDENTIAL



OSBORNE TERRACE, NEWCASTLE UPON TYNE

£1,885 Per Month

BRUNTON

RESIDENTIAL





BRUNTON

RESIDENTIAL



BRUNTON

RESIDENTIAL

Available 31st August 2026- Rent £145pppw / £1,885pcm - 3 Bedroom Apartment - Popular
Location - Open Plan Kitchen / Living room - Opposite Jesmond Metro Station - Call Today

BRUNTON

RESIDENTIAL

BRUNTON

RESIDENTIAL

BRUNTON

RESIDENTIAL

TENURE :

LOCAL AUTHORITY : Newcastle City Council

COUNCIL TAX BAND : B

EPC RATING : C

Second Floor

Approx. 85.1 sq. metres (915.6 sq. feet)

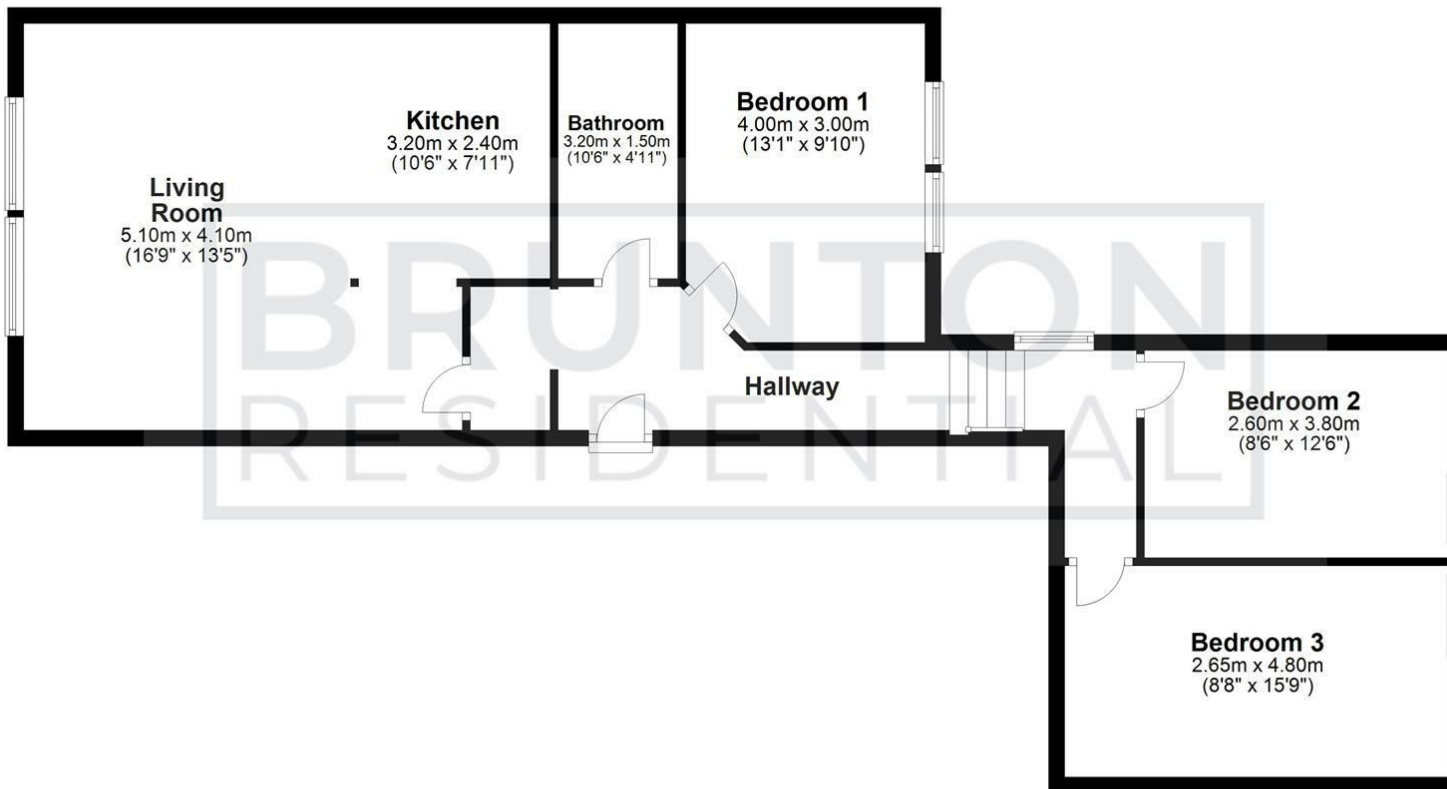

Total area: approx. 85.1 sq. metres (915.6 sq. feet)

All measurements are approximate and are for illustration only.
Plan produced using PlanUp.

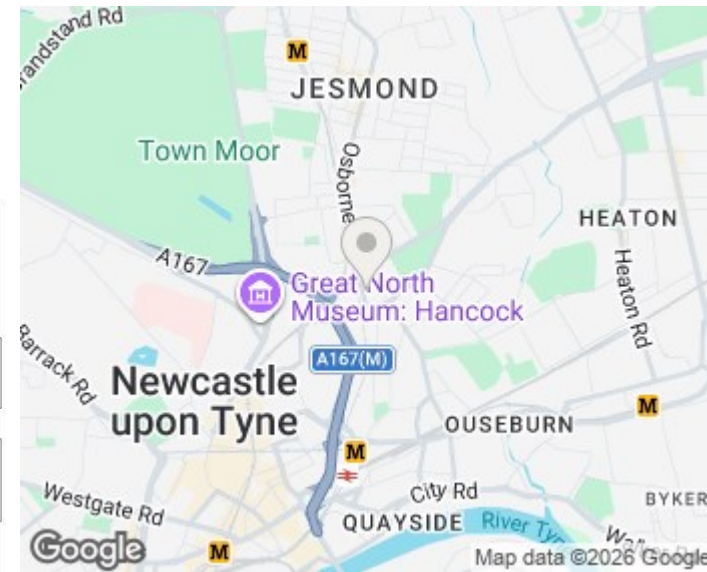

Energy Efficiency Rating		Current	Potential
Very energy efficient - lower running costs			
(92 plus)	A		
(81-91)	B		
(69-80)	C		
(55-68)	D		
(39-54)	E		
(21-38)	F		
(1-20)	G		
Not energy efficient - higher running costs			
		80	83
England & Wales		EU Directive 2002/91/EC	

Environmental Impact (CO ₂) Rating		Current	Potential
Very environmentally friendly - lower CO ₂ emissions			
(92 plus)	A		
(81-91)	B		
(69-80)	C		
(55-68)	D		
(39-54)	E		
(21-38)	F		
(1-20)	G		
Not environmentally friendly - higher CO ₂ emissions			
England & Wales		EU Directive 2002/91/EC	