

BRUNTON

RESIDENTIAL



OSBORNE TERRACE, NEWCASTLE UPON TYNE

£1,885 Per Month

BRUNTON

RESIDENTIAL





BRUNTON

RESIDENTIAL



BRUNTON

RESIDENTIAL

Available 31st August 2026- Rent £145pppw / £1,885pcm - 3 Bedroom Apartment - Popular
Location - Open Plan Kitchen / Living room - Opposite Jesmond Metro Station - Call Today

BRUNTON

RESIDENTIAL

BRUNTON

RESIDENTIAL

BRUNTON

RESIDENTIAL

TENURE :

LOCAL AUTHORITY : Newcastle City Council

COUNCIL TAX BAND : B

EPC RATING : C

Second Floor

Approx. 85.1 sq. metres (915.6 sq. feet)

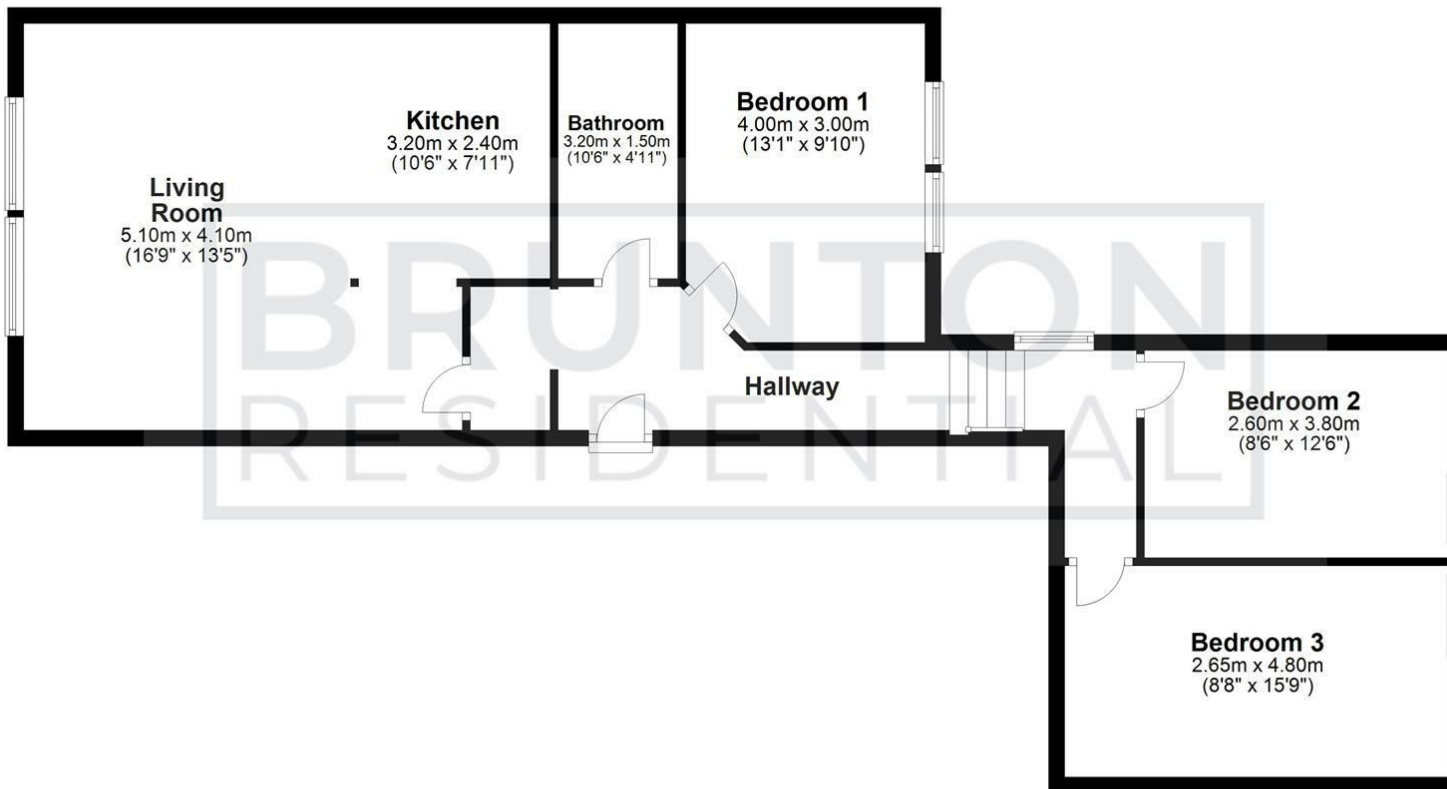

Total area: approx. 85.1 sq. metres (915.6 sq. feet)

All measurements are approximate and are for illustration only.
Plan produced using PlanUp.

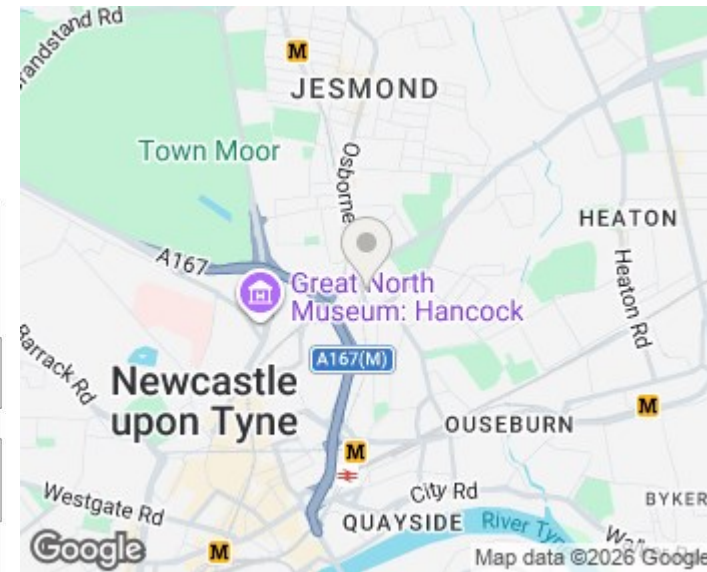

Energy Efficiency Rating	
Current	Potential
Very energy efficient - lower running costs	
(92 plus) A	
(81-91) B	
(69-80) C	
(55-68) D	
(39-54) E	
(21-38) F	
(1-20) G	
Not energy efficient - higher running costs	
	80
	83
EU Directive 2002/91/EC	

Environmental Impact (CO ₂) Rating	
Current	Potential
Very environmentally friendly - lower CO ₂ emissions	
(92 plus) A	
(81-91) B	
(69-80) C	
(55-68) D	
(39-54) E	
(21-38) F	
(1-20) G	
Not environmentally friendly - higher CO ₂ emissions	
EU Directive 2002/91/EC	

England & Wales

EU Directive 2002/91/EC

England & Wales

EU Directive 2002/91/EC