

BRUNTON

RESIDENTIAL

T. 0191 236 8347
E. info@bruntonresidential.com
A. 125 St George's Terrace, NE2
W. 2DN
bruntonresidential.com



Melbourne Street

City centre Newcastle Upon Tyne, NE1 2JR

****VIDEO TOUR**** Available 26TH August 2026 - Rent £115ppw/£1,495pcm - Three-Bedroom Apartment - All Double Rooms - Modern Bathroom & Kitchen - Secure Entry - Open-Plan kitchen/Living Room - Call Today to Arrange Viewings

£1,495 Per Month

2 Rialto Melbourne Street

City centre Newcastle Upon Tyne, NE1 2JR



****VIDEO TOUR**** Available 26TH August 2026- Rent £115pppw/£1,495pcm - Three-bedroom apartment - All double rooms - Modern bathroom & Kitchen - Secure entry - Open plan kitchen/Livingroom - Call today to arrange viewings

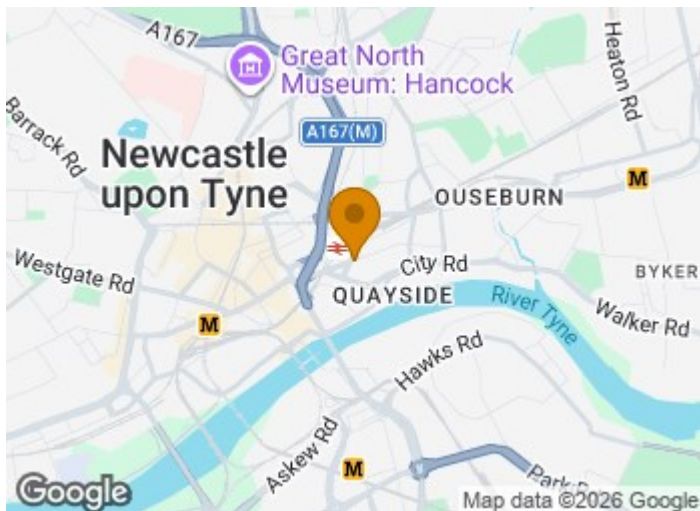

- VIDEO TOUR
- Available 26th August 2026
- Rent £115pppw/£1,495pcm
- 3 Bedroom City Centre Apartment
- Secure Entry System
- Open-Plan Living/Kitchen
- All 3 Double Bedrooms
- Modern Bathroom
- Juliette Balcony
- EPC Rating C



Floor Plan

Ground Floor

Approx. 69.7 sq. metres (750.4 sq. feet)

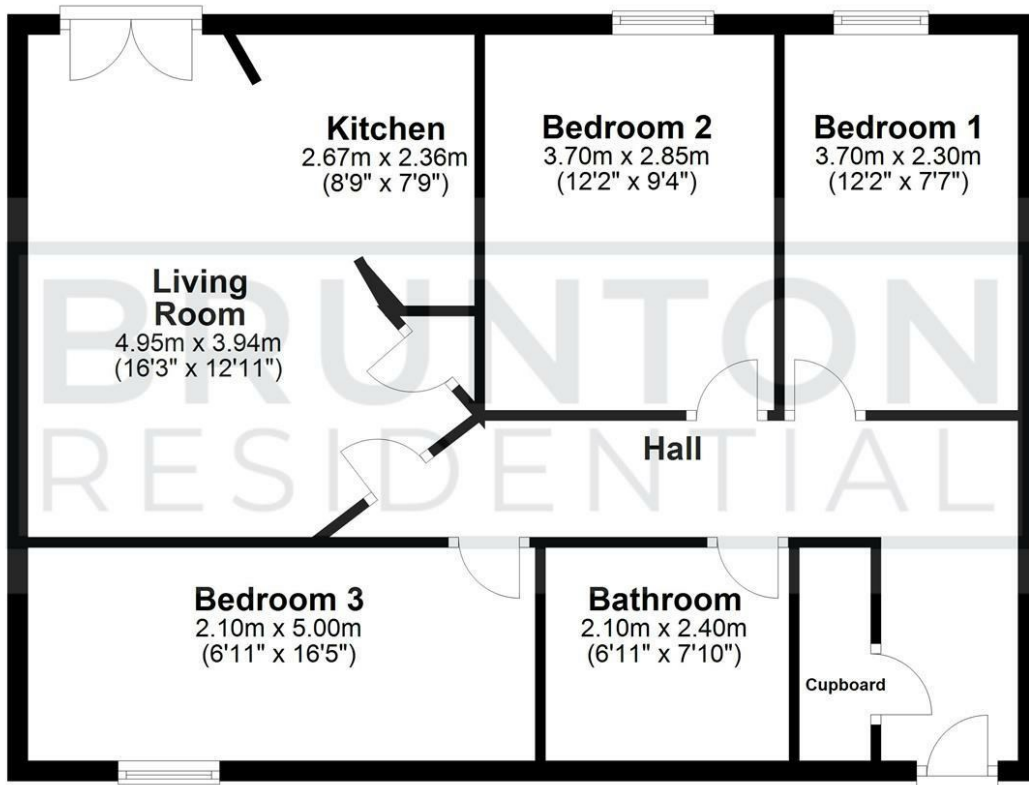

Total area: approx. 69.7 sq. metres (750.4 sq. feet)

All measurements are approximate and are for illustration only.
Plan produced using PlanUp.

These particulars, whilst believed to be accurate are set out as a general outline only for guidance and do not constitute any part of an offer or contract. Intending purchasers should not rely on them as statements of representation of fact, but must satisfy themselves by inspection or otherwise as to their accuracy. No person in this firm's employment has the authority to make or give any representation or warranty in respect of the property.

