

# BRUNTON

---

RESIDENTIAL



**ENNISMORE COURT, BENTON NE12**

**£1,150 Per Month**

# BRUNTON

---

RESIDENTIAL





# BRUNTON

---

RESIDENTIAL



# BRUNTON

---

## RESIDENTIAL



Available 01/08/2026 - £1,150pcm - End Terraced House - Two double bedrooms and third small bedroom/Study - Spacious Kitchen/Diner - Very Well Presented - Located Next To Benton Metro - Popular Location - Furnished - Easy Access to Newcastle City Centre including Freeman/RVI Hospitals.

# BRUNTON

---

## RESIDENTIAL

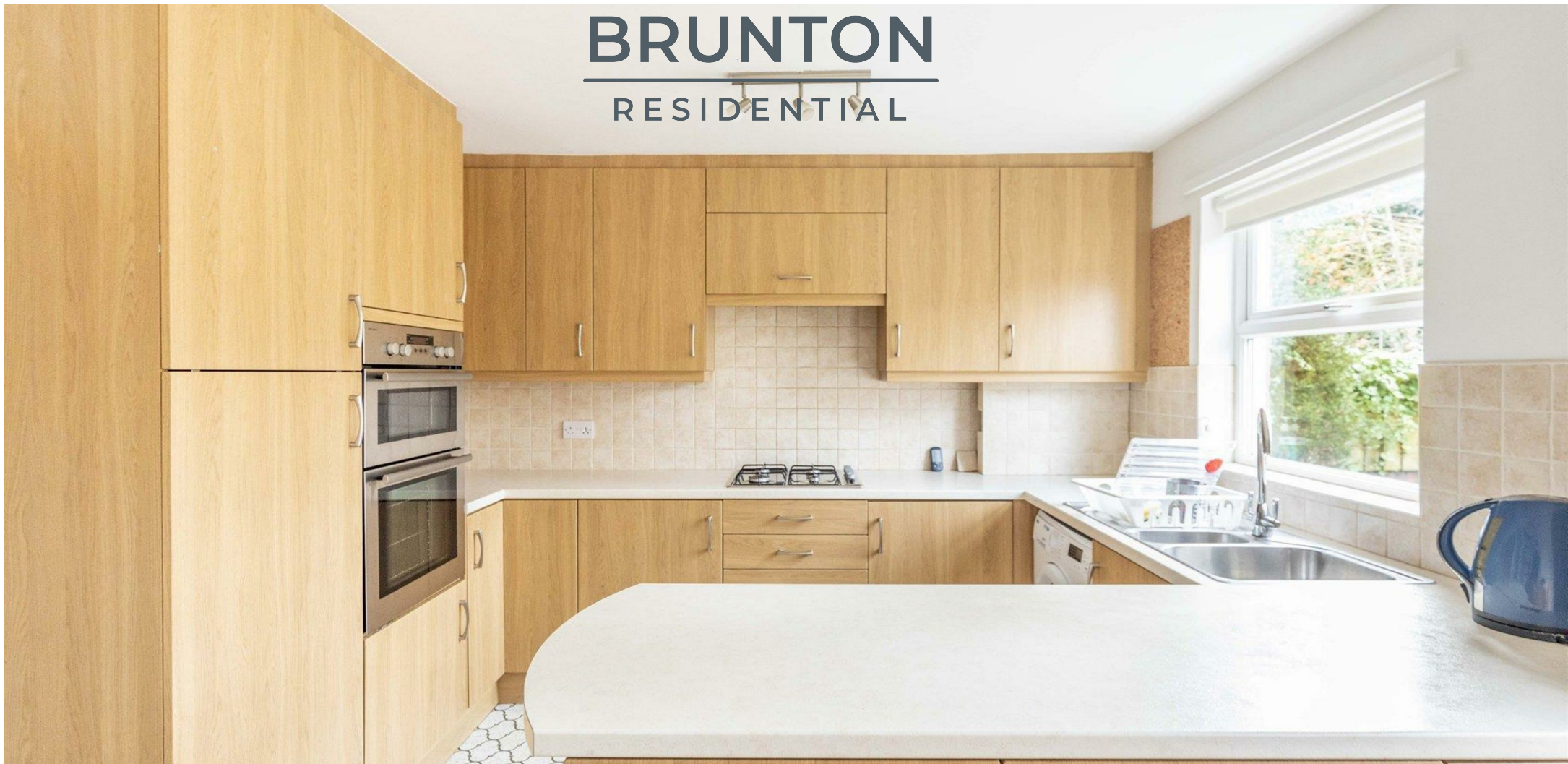

# BRUNTON

---

## RESIDENTIAL



# BRUNTON

## RESIDENTIAL

TENURE :

LOCAL AUTHORITY : North Tyneside

COUNCIL TAX BAND : C

EPC RATING : C

### Ground Floor

Approx. 41.5 sq. metres (446.2 sq. feet)



### First Floor

Approx. 41.5 sq. metres (446.3 sq. feet)

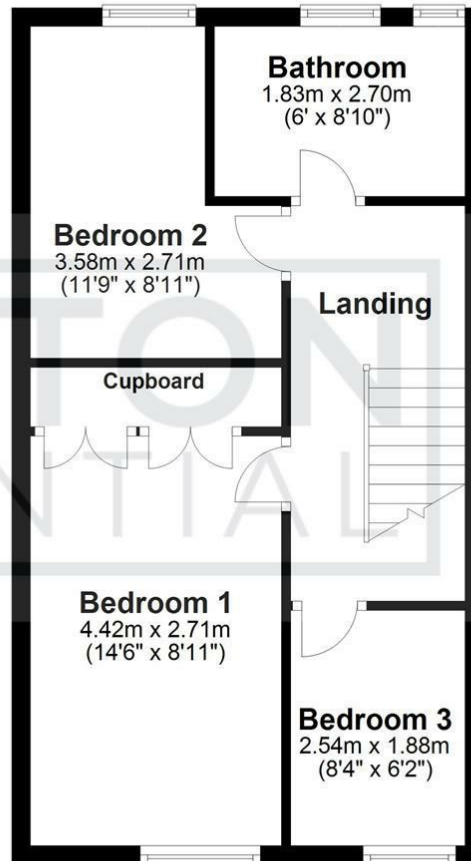

All measurements are approximate and are for illustration only.  
Plan produced using PlanUp.



Energy Efficiency Rating		
	Current	Potential
Very energy efficient - lower running costs		
(92 plus) <b>A</b>		85
(81-91) <b>B</b>		
(69-80) <b>C</b>	71	
(55-68) <b>D</b>		
(39-54) <b>E</b>		
(21-38) <b>F</b>		
(1-20) <b>G</b>		
Not energy efficient - higher running costs		
England & Wales	EU Directive 2002/91/EC	

Environmental Impact (CO <sub>2</sub> ) Rating		
	Current	Potential
Very environmentally friendly - lower CO <sub>2</sub> emissions		
(92 plus) <b>A</b>		85
(81-91) <b>B</b>		
(69-80) <b>C</b>	71	
(55-68) <b>D</b>		
(39-54) <b>E</b>		
(21-38) <b>F</b>		
(1-20) <b>G</b>		
Not environmentally friendly - higher CO <sub>2</sub> emissions		
England & Wales	EU Directive 2002/91/EC	