



**Edenside Road, Bookham**

**Great Bookham**

Offers Over  
**£350,000**

**Bedrooms: 3**

**Bathrooms: 1**

**Receptions: 1**

Pacey Wingent Dickson are delighted to present this beautifully presented ground-floor maisonette in Edenside, Bookham, featuring three good-sized bedrooms, a modern bathroom and separate W/C.

The property features a stylish contemporary kitchen alongside a spacious living and dining area, finished to a high standard throughout. Large windows allow an abundance of natural light to flow through the property, creating a bright and welcoming atmosphere.

Externally, the property benefits from useful storage, suitable for bin and/or bike storage, and enjoys an enviable position within easy reach of highly regarded local schools, Bookham High Street and Bookham train station, making it ideal for commuters and families alike.





**Bedrooms: 3**

**Bathrooms: 1**

**Receptions: 1**

## Edenside Road, Bookham, KT23

Approximate Gross Internal Area = 97.1 sq m / 1045 sq ft  
Storage = 1.9 sq m / 20 sq ft  
Total = 99.0 sq m / 1065 sq ft



- Ground floor maisonette
- Three good-sized bedrooms
- Modern family bathroom
- Separate W/C
- Beautifully presented throughout
- Separate modern kitchen
- Lockup for bin and/or bike storage
- Close to Bookham high street & station

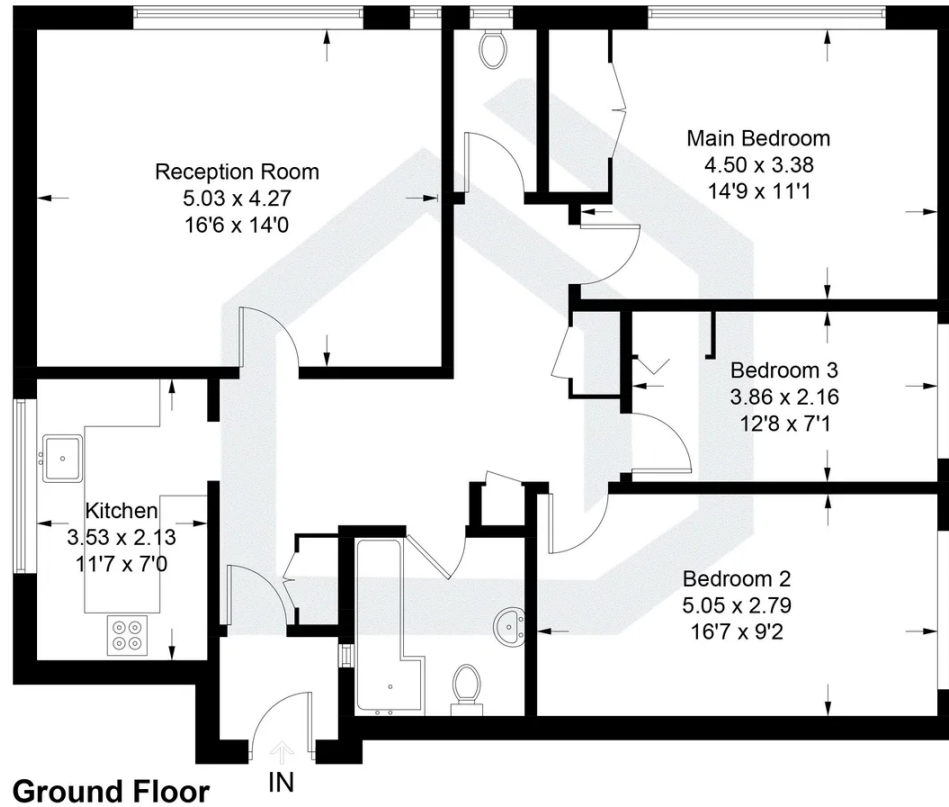

(Not Shown In Actual Location / Orientation)

Illustration for identification purposes only, measurements are approximate, not to scale. Fourlabs.co © (ID1302771)

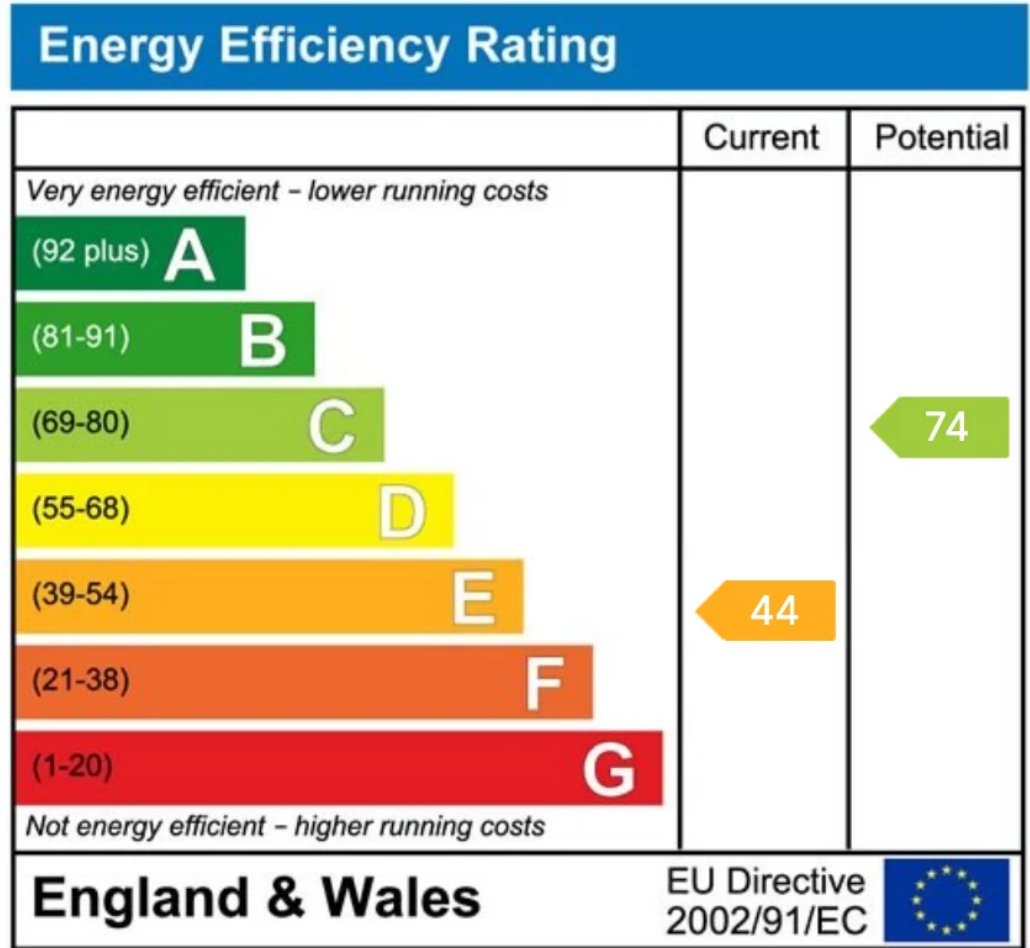

**Pacey Wingent Dickson Property Partnership Limited**

197 Lower Road Great Bookham Leatherhead KT23 4DG

01372 456 804

info@pwdproperty.co.uk

<https://pwdproperty.co.uk/>