



Portsmouth Road, Guildford, GU2 4DG

Guildford

£1,900 pcm

Deposit: £2,307

Date First Available: 28/04/2026

Furnishing: Furnished

VIRTUAL TOUR available. Fully decorated throughout - Stylish Top-Floor Apartment with Stunning Views in Central Guildford

Boasting a superb elevated position with far-reaching views across Guildford, this beautifully finished two-bedroom top-floor apartment in a period building offers contemporary living in a prime location. Furnished and presented to a high standard, it features stylish interiors and thoughtful design throughout.

The bright open-plan living area includes a modern kitchen with integrated appliances, a breakfast bar with big bright windows. A separate utility room adds practicality, while the smart bathroom benefits from underfloor heating for added comfort. Both bedrooms are well-proportioned, and the property enjoys off-street parking.

Ideally located just a short walk from Guildford's picturesque cobbled High Street, the River Wey, and the mainline train station (with direct services to London Waterloo), the apartment offers exceptional convenience. Major road links including the A3, A31, M3, and M25 are easily accessible, making it perfect for commuters.

This fantastic home combines location, style, and comfort, ideal for professionals or anyone looking to enjoy the best of Guildford living.



Deposit: £2,307

Date First Available: 28/04/2026

Furnishing: Furnished

VIRTUAL TOUR available. Fully decorated throughout - Stylish Top-Floor Apartment with Stunning Views in Central Guildford

Boasting a superb elevated position with far-reaching views across Guildford, this beautifully finished two-bedroom top-floor apartment in a period building offers contemporary living in a prime location. Furnished and presented to a high standard, it features stylish interiors and thoughtful design throughout.

The bright open-plan living area includes a modern kitchen with integrated appliances, a breakfast bar with big bright windows. A separate utility room adds practicality, while the smart bathroom benefits from underfloor heating for added comfort. Both bedrooms are well-proportioned, and the property enjoys off-street parking.

Ideally located just a short walk from Guildford's picturesque cobbled High Street, the River Wey, and the mainline train station (with direct services to London Waterloo), the apartment offers exceptional convenience. Major road links including the A3, A31, M3, and M25 are easily accessible, making it perfect for commuters.

This fantastic home combines location, style, and comfort, ideal for professionals or anyone looking to enjoy the best of Guildford living.

Portsmouth Road, Guildford, GU2 4DG

Approximate Gross Internal Area = 58.9 sq m / 634 sq ft



 = Reduced head height below 1.5m

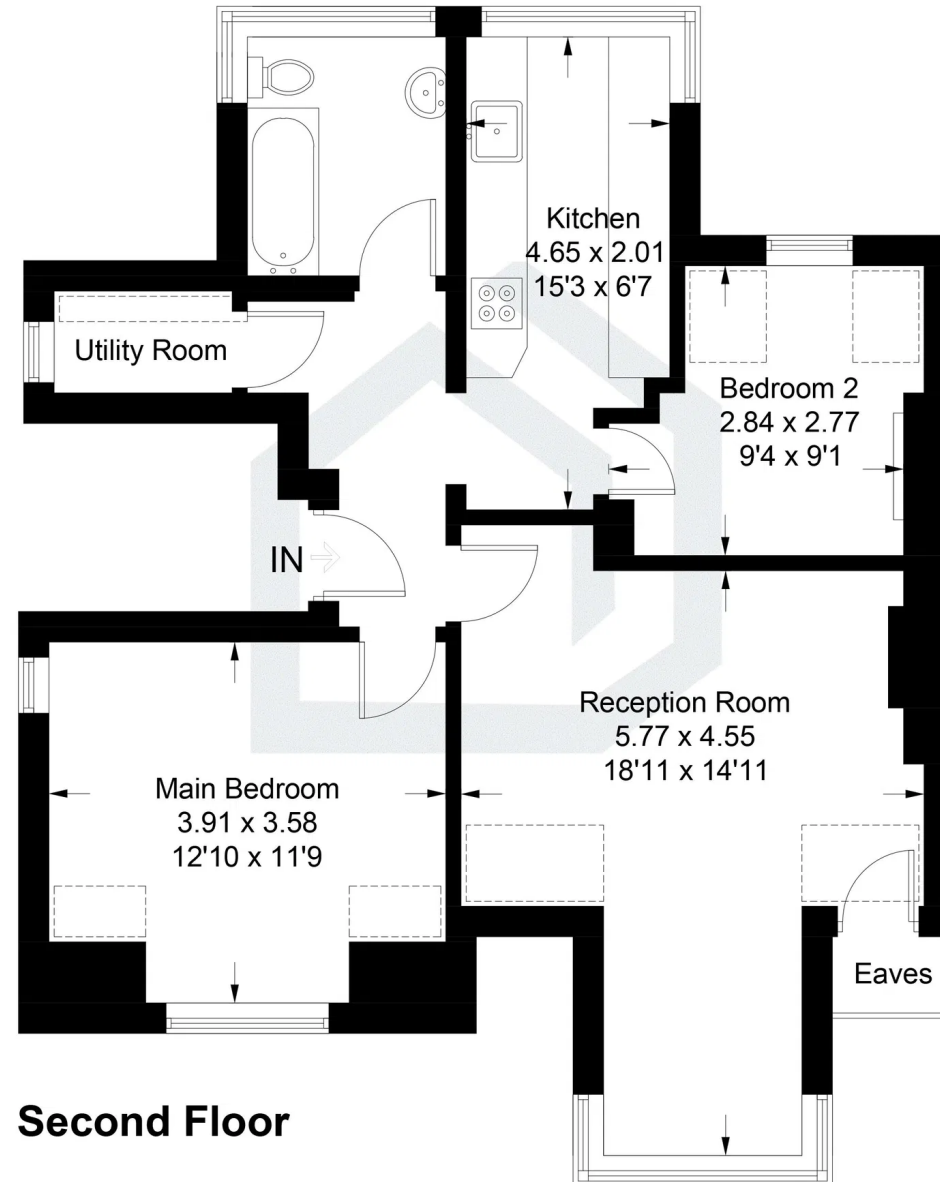

Second Floor

Illustration for identification purposes only, measurements are approximate, not to scale. floorplansUsketch.com © (ID1219401)



Energy Efficiency Rating

