

H.M. LAND REGISTRY		TITLE NUMBER	
		CH 147520	
ORDNANCE SURVEY PLAN REFERENCE	SJ 7668	SECTION A	Scale 1/1250 Enlarged from 1/2500
COUNTY CHESHIRE	DISTRICT CONGLETON	© Crown copyright 1979	

CRANAGE PARISH

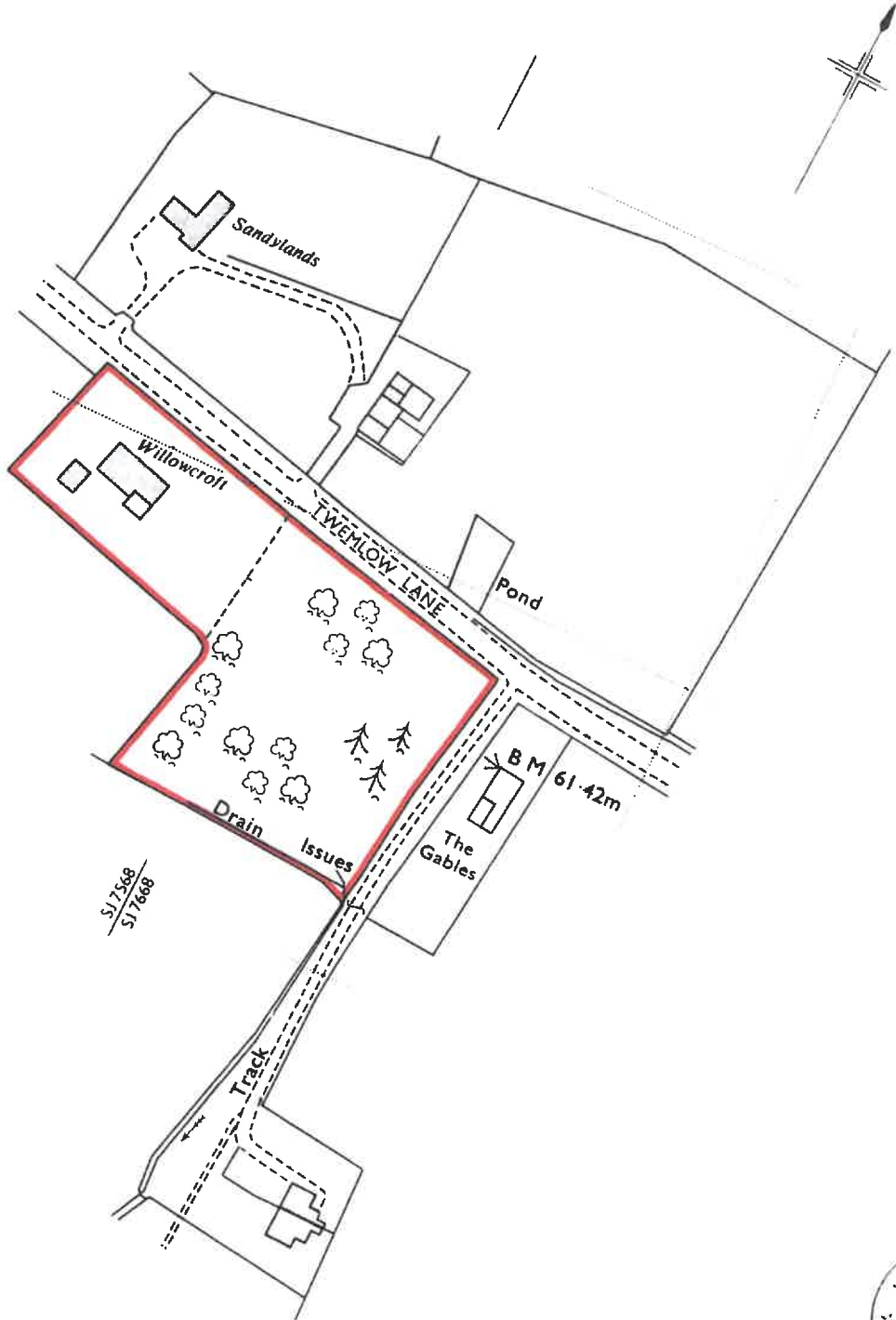

This is a print of the view of the title plan obtained from HM Land Registry showing the state of the title plan on 08 May 2026 at 17:01:39. This title plan shows the general position, not the exact line, of the boundaries. It may be subject to distortions in scale. Measurements scaled from this plan may not match measurements between the same points on the ground.

This title is dealt with by HM Land Registry, Birkenhead Office.

HM Land Registry Current title plan

Title number **CH666502**
Ordnance Survey map reference **SJ7568NE**
Scale **1:1250 enlarged from 1:2500**
Administrative area **Cheshire East**

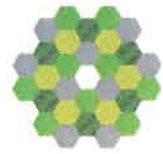

© Crown copyright and database rights 2018 Ordnance Survey AC0000851063.
You are not permitted to copy, sub-license, distribute or sell any of this data to third parties in any form.

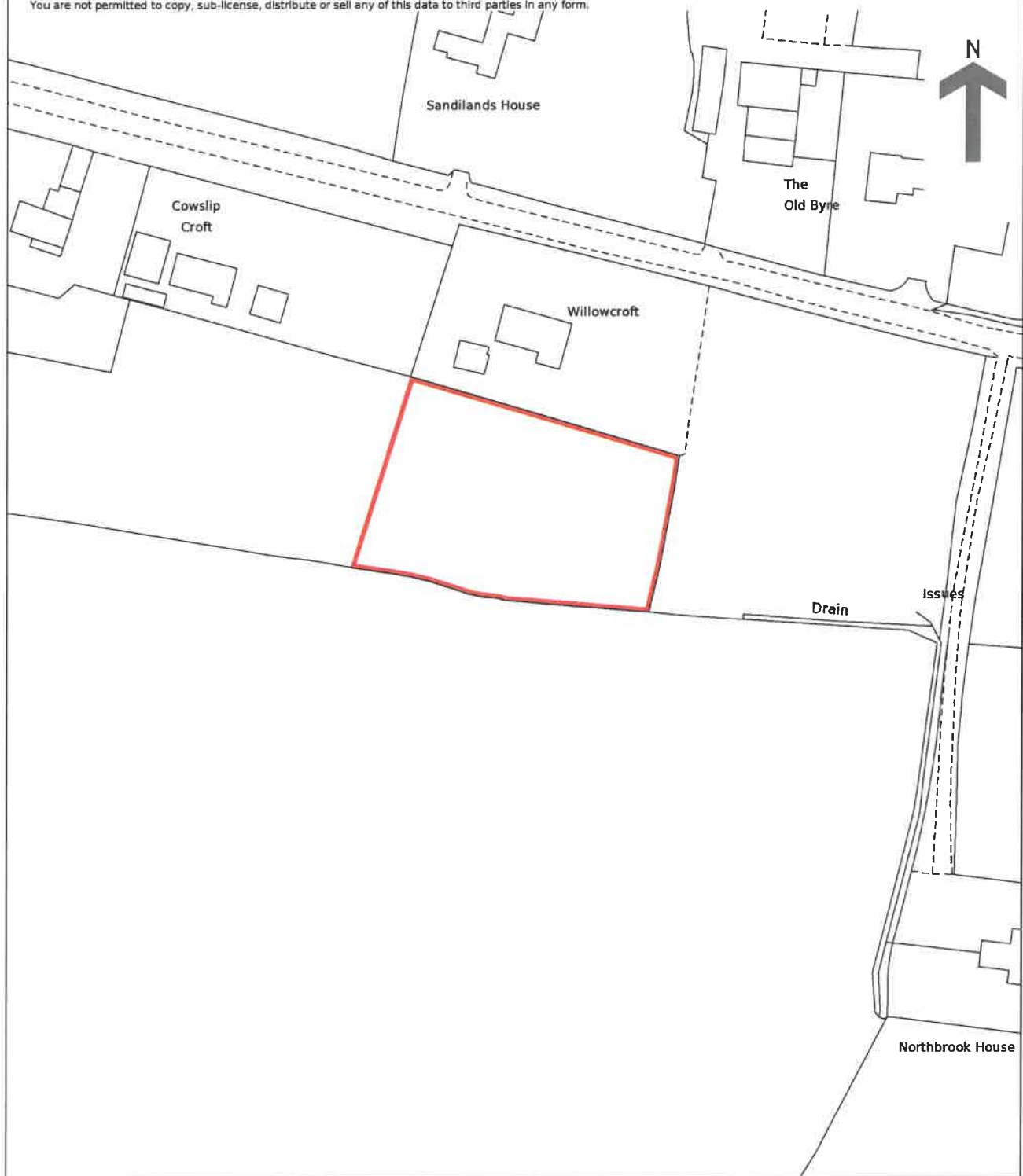

This is a print of the view of the title plan obtained from HM Land Registry showing the state of the title plan on 22 May 2026 at 11:20:43. This title plan shows the general position, not the exact line, of the boundaries. It may be subject to distortions in scale. Measurements scaled from this plan may not match measurements between the same points on the ground.

This title is dealt with by HM Land Registry, Birkenhead Office.