

Flat 11

Heathlands House, Gaskell Avenue,
Knutsford

An immaculate refurbished two bedroom apartment with lovely views, forming part of a very popular small development in the heart of town, right opposite the Little Heath.

Council Tax band: D

Tenure: Leasehold

EPC Energy Efficiency Rating: C

- An immaculate first floor two bedroom, two bathroom apartment
- Very sought after block opposite the Little Heath, just a stones throw from town
- Private allocated parking and lovely views to the front over The Heath





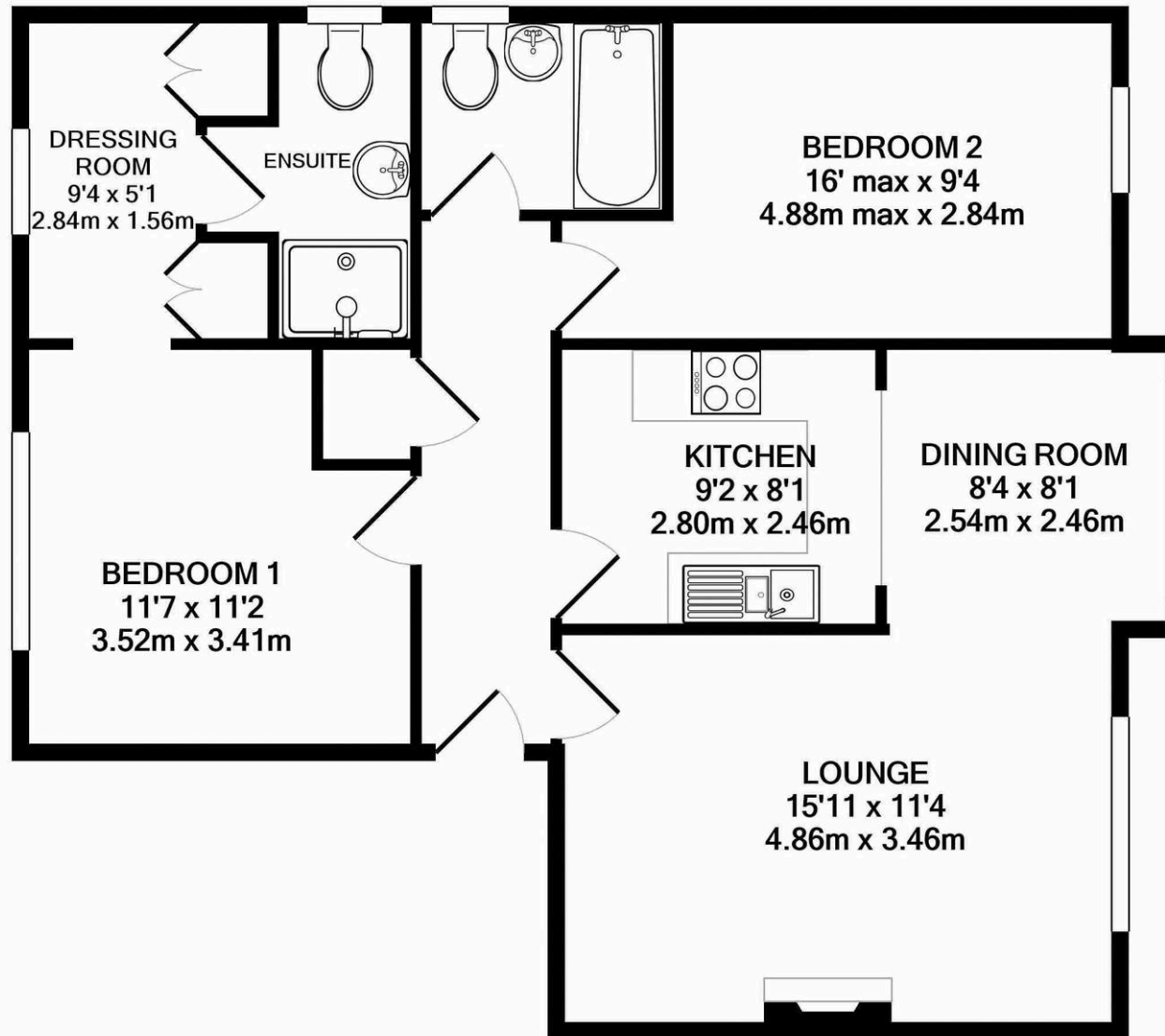

TOTAL APPROX. FLOOR AREA 787 SQ.FT. (73.1 SQ.M.)

Whilst every attempt has been made to ensure the accuracy of the floor plan contained here, measurements of doors, windows, rooms and any other items are approximate and no responsibility is taken for any error, omission, or mis-statement. This plan is for illustrative purposes only and should be used as such by any prospective purchaser. The services, systems and appliances shown have not been tested and no guarantee as to their operability or efficiency can be given

Made with Metropix ©2020



Stuart Rushton & Company

Stuart Rushton & Co, 35 King Street – WA16 6DW

01565 757000

enquiries@srushton.co.uk

www.srushton.co.uk



We are not authorised to make or give any representations or warranties in relation to the property either here or elsewhere. We assume no responsibility for any statement that may be made in these particulars, and they do not form part of any offer or contract and must not be relied upon as statements or representation of fact. Any areas, measurements or distances are approximate. The text, photographs and plans are for guidance only. Importantly, it should not be assumed that the property has all necessary planning, building regulations or other consents and we have not tested any services, equipment or facilities. Purchasers must satisfy themselves by inspection or otherwise.