



GINGER COW
ESTATE AGENTS

01234 860215

Knoll Gardens, Wixams

£350,000

3

2

Set within a quiet cul-de-sac in the sought-after village of Wixams, this attractive double-fronted three-bedroom detached home offers stylish, well-balanced living ideal for families. The ground floor features a spacious dual-aspect lounge and a bright kitchen/diner, perfect for both relaxing and entertaining. Upstairs, three well-proportioned bedrooms are served by a sleek, modern bathroom. Outside, the property benefits from a side driveway with carport providing parking for two vehicles, along with a landscaped rear garden finished with low-maintenance artificial lawn. A fantastic turnkey home in a desirable Bedfordshire location.



Floor Area: 1038 sq. ft.

Tenure: Freehold

Service Charge: £0 per annum

Ground Rent: £0 per annum

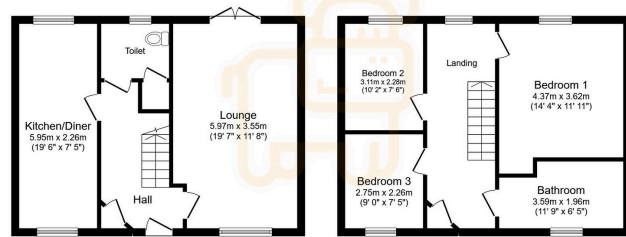

Ground Floor
Floor area 48.2 sq.m. (519 sq.ft.)

First Floor
Floor area 48.2 sq.m. (519 sq.ft.)

Total floor area: 96.4 sq.m. (1,038 sq.ft.)

This floor plan is for illustrative purposes only. It is not drawn to scale. Any measurements, floor areas (including any total floor area), openings and orientations are approximate. No details are guaranteed; they cannot be relied upon for any purpose and do not form any part of any agreement. No liability is taken for any error, omission or misstatement. A party must rely upon its own inspection(s). Powered by www.propertybox.co.uk

