



CHARLES KNIGHT  
ESTATE AGENTS



## 73 Longbridge Way , London, SE13 6PW Offers in excess of £360,000

Ideal First-Time Buy or Buy-to-Let Investment

Situated on the popular Longbridge Way in London, this well-presented two-bedroom mid-terrace home is an excellent opportunity for first-time buyers or buy-to-let investors alike. The property benefits from a private parking space and a rear garden, offering both convenience and outdoor space.

Just 0.3 miles from Ladywell Station, the location provides easy access for commuters while remaining close to a wide range of local amenities.

The accommodation comprises a bright through reception room, a modern kitchen/breakfast room with direct access to the rear garden, and upstairs offers two well-proportioned bedrooms along with a contemporary family bathroom.

Lewisham is renowned for its excellent transport connections, with direct train and DLR services offering swift links into central London. The area boasts an indoor shopping centre, a vibrant daily market, green open spaces, and a diverse selection of restaurants and cafés.

Families and investors alike will appreciate the strong local demand, supported by a wide choice of highly regarded primary and secondary schools, as well as independent options. Nearby Blackheath further enhances the lifestyle appeal with its boutique shops, fine dining, and lively bars.

### Viewing

Please contact our Lewisham Office on 02088 524441 if you wish to arrange a viewing appointment for this property or require further information.



## Floor Plan

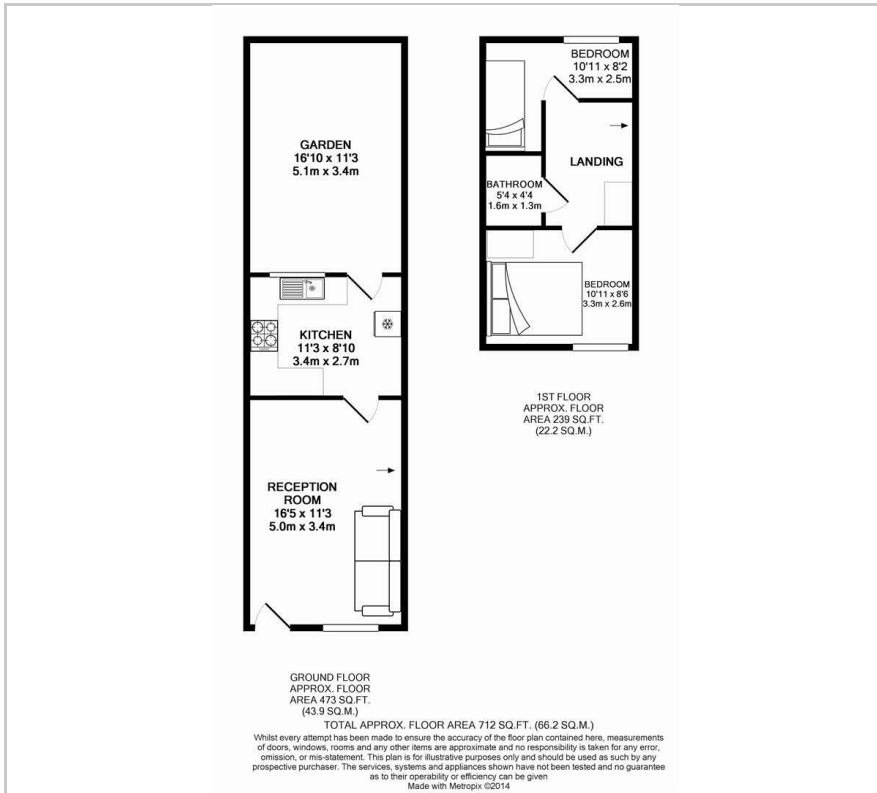

## Area Map



## Energy Efficiency Graph

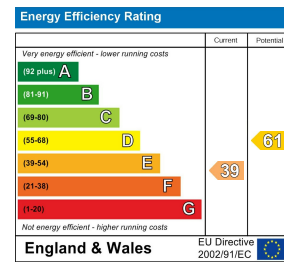

These particulars, whilst believed to be accurate are set out as a general outline only for guidance and do not constitute any part of an offer or contract. Intending purchasers should not rely on them as statements of representation of fact, but must satisfy themselves by inspection or otherwise as to their accuracy. No person in this firm's employment has the authority to make or give any representation or warranty in respect of the property.