

**Rex Gooding**



**19 Main Street, Bradmore, NG11 6PB**

**Guide Price: £750,000**

## 19 Main Street, Bradmore, NG11 6PB

Idyllic Country Residence with Spectacular Southerly Views.

Set within a breathtaking grounds of just over an acre and offering panoramic southerly views toward Bunny, this extended detached residence combines traditional charm with generous living spaces and the rare delight of its own established orchard—creating a truly exceptional country home for those seeking space, tranquility, and natural beauty.

The thoughtfully extended accommodation unfolds across two welcoming floors, beginning with a practical entrance hall that provides access to a convenient ground floor shower room and useful storage including a cupboard housing the oil-fired central heating boiler. The ground floor further benefits from a well-appointed double bedroom complete with fitted wardrobes—an ideal arrangement for multi-generational living or those seeking accessible accommodation.

At the heart of this inviting home lies the spacious living room, positioned to maximize the property's most captivating feature—the spectacular southerly views across open countryside. This impressive space flows seamlessly into a UPVC double-glazed conservatory, creating the perfect spot to enjoy the changing seasons while remaining in perfect comfort. Sliding doors connect to a separate dining area, ideal for both everyday family meals and more formal entertaining occasions.

The practical breakfast kitchen features a comprehensive range of wall and base units, complemented by a separate utility room that keeps laundry appliances discreetly tucked away from the main living areas. Additional convenience comes in the form of a rear porch with separate toilet facilities, providing valuable extra amenities for a busy household.

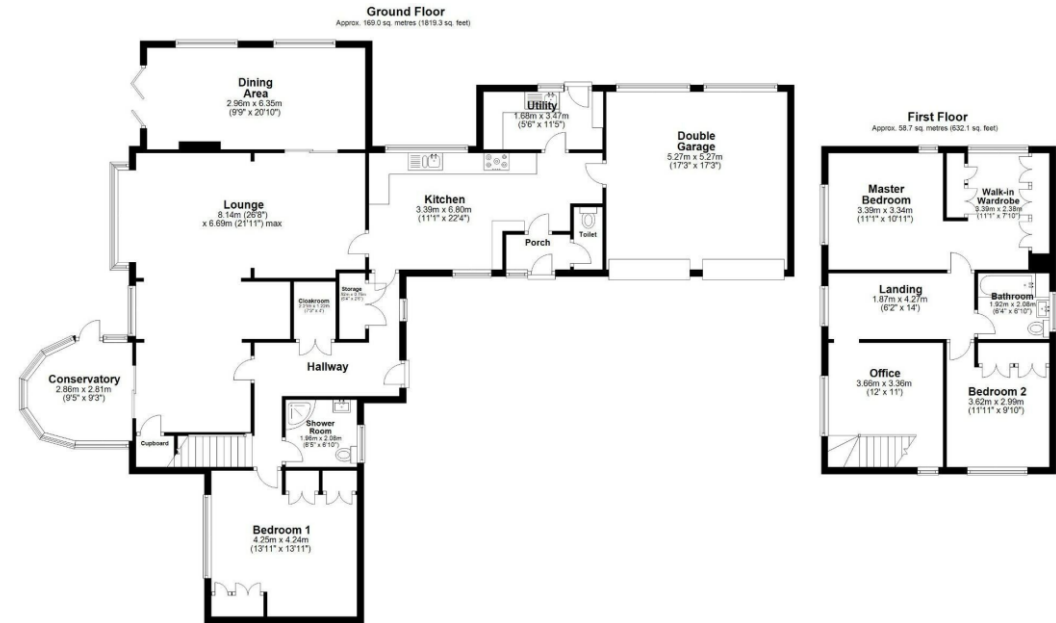

Total area: approx. 227.7 sq. metres (2451.4 sq. feet)













