

Bushey Grove Road,, Bushey WD23 2JJ

£830 PCM

Benjamin Stevens are pleased to offer various newly refurbished rooms to let

The RENT INCLUDES ALL BILLS including Council Tax for the first year.

Room 5 (Ground Floor) – Shared bathroom & kitchen & garden access

Room 6 (Ground Floor) – Shared bathroom & kitchen & garden access

The property is approximately a 10 minute walk to Bushey train station and is close to the M1 & A41.

To arrange a viewing, please call 020 3271 0111

Bushey Grove Road,, Bushey WD23 2JJ

Room 5



Room 6



Room 9

Room 12



Room 13



GROUND FLOOR
317 sq.ft. (29.5 sq.m.) approx.

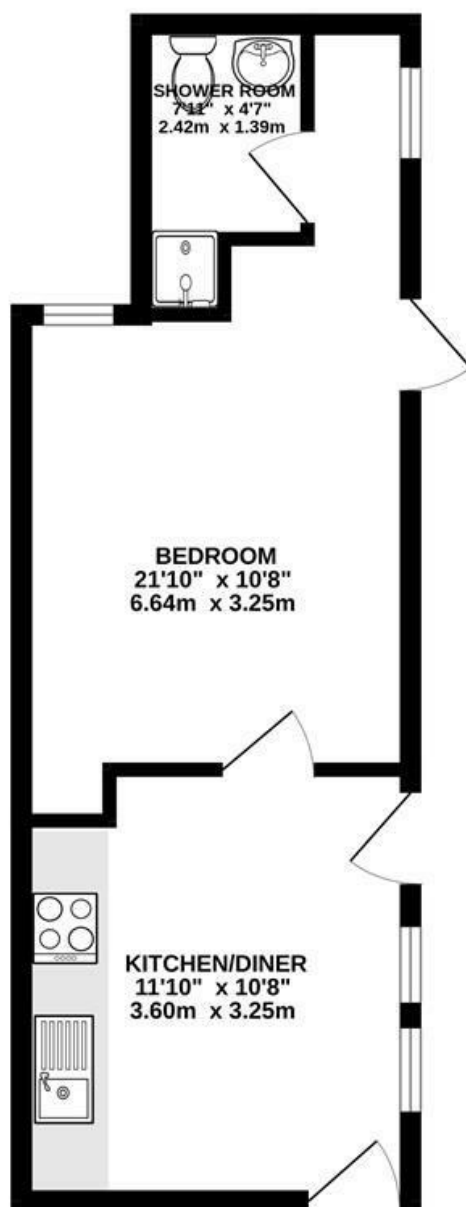

TOTAL FLOOR AREA : 317 sq.ft. (29.5 sq.m.) approx.

Whilst every attempt has been made to ensure the accuracy of the floorplan contained here, measurements of doors, windows, rooms and any other items are approximate and no responsibility is taken for any error, omission or mis-statement. This plan is for illustrative purposes only and should be used as such by any prospective purchaser. The services, systems and appliances shown have not been tested and no guarantee as to their operability or efficiency can be given.
Made with Metropix 5/2025

