



**BENJAMIN
STEVENS.**
estate agents



Lyon Road, Harrow HA1 2EX

£1,675 PCM

Benjamin Stevens are pleased to offer this two bedroom, two bathroom flat situated right in the heart of Harrow town centre.

The accommodation comprises of Two Bedrooms one with en-suite, a Family Bathroom, Open Plan living Room / Kitchen, a Balcony and a Parking Space

To arrange a viewing, please call 020 3271 0111

Lyon Road, Harrow HA1 2EX

Living Room

Bedroom One

Kitchen

Bathroom

Toilet

Exterior

En-suite

Balcony

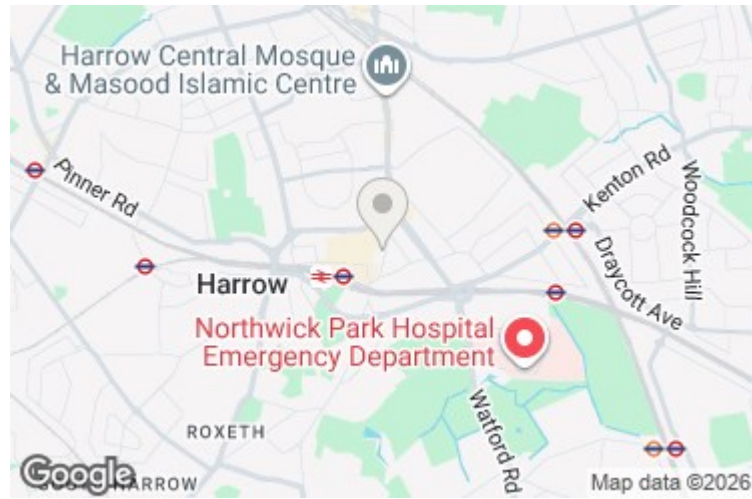

GROUND FLOOR
540 sq.ft. (50.2 sq.m.) approx.

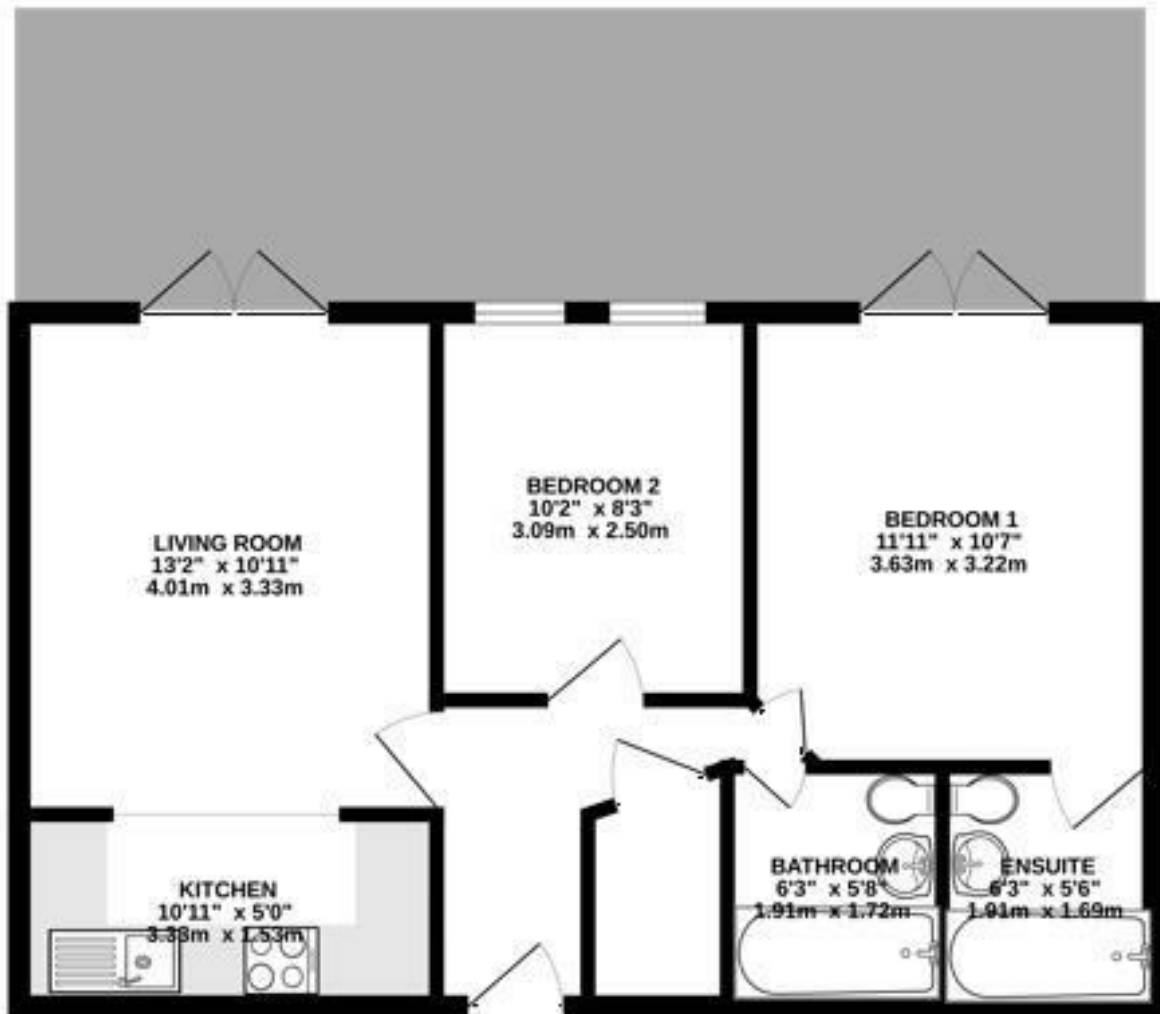

TOTAL FLOOR AREA: 540 sq.ft. (50.2 sq.m.) approx.

While every effort has been made to ensure the accuracy of the floorplan contained here, measurements of doors, windows, rooms and any other items are approximate and no responsibility is taken for any error, omission or mis-statement. This plan is for illustrative purposes only and should be used as such by any prospective purchaser. The services, systems and appliances shown have not been tested and no guarantee as to their operating or efficiency can be given. Made with Blueprints 7/2/18

Energy Efficiency Rating		Environmental Impact (CO ₂) Rating	
Current	Potential	Current	Potential
<p>Very energy efficient - lower running costs</p> <p>(92 plus) A</p> <p>(81-91) B</p> <p>(69-80) C</p> <p>(55-68) D</p> <p>(39-54) E</p> <p>(21-38) F</p> <p>(1-20) G</p> <p>Not energy efficient - higher running costs</p>		<p>Very environmentally friendly - lower CO₂ emissions</p> <p>(92 plus) A</p> <p>(81-91) B</p> <p>(69-80) C</p> <p>(55-68) D</p> <p>(39-54) E</p> <p>(21-38) F</p> <p>(1-20) G</p> <p>Not environmentally friendly - higher CO₂ emissions</p>	
<p>England & Wales</p> <p>EU Directive 2002/91/EC</p>		<p>England & Wales</p> <p>EU Directive 2002/91/EC</p>	



Edgware Office- 194 Station Road, Edgware, HA8 7AT. Tel: 020 8958 1118
 Bushey Heath Office- 59 High Road, Bushey, WD23 1EE. Tel: 020 8950 7777
www.benjaminstevens.co.uk