



**Howard Close, Bushey Heath, WD23**  
Bushey

Offers Over  
**£799,950**

**Bedrooms: 3**

**Bathrooms: 2**

**Receptions: 3**

An extended beautifully presented bright and spacious THREE BEDROOM, TWO BATHROOM, THREE RECEPTION ROOM FAMILY HOME situated in a sought after residential close in the heart of Bushey Heath, conveniently located and within walking distance to all local shopping and transport facilities. The property is being offered in excellent decorative order and benefits from: Replacement Double Glazed Windows, Gas Fired Heating To Radiators, Guest Cloakroom, Play Room, Study, Living Room/Dining Room, Fully Fitted Modern Kitchen/Breakfast Room, Three Bedrooms, Bathroom, Separate Shower Room, Secluded Rear Garden, Off Street Parking.







# Howard Close, Bushey Heath, Bushey, WD23

Approximate Area = 1343 sq ft / 124.7 sq m

For identification only - Not to scale

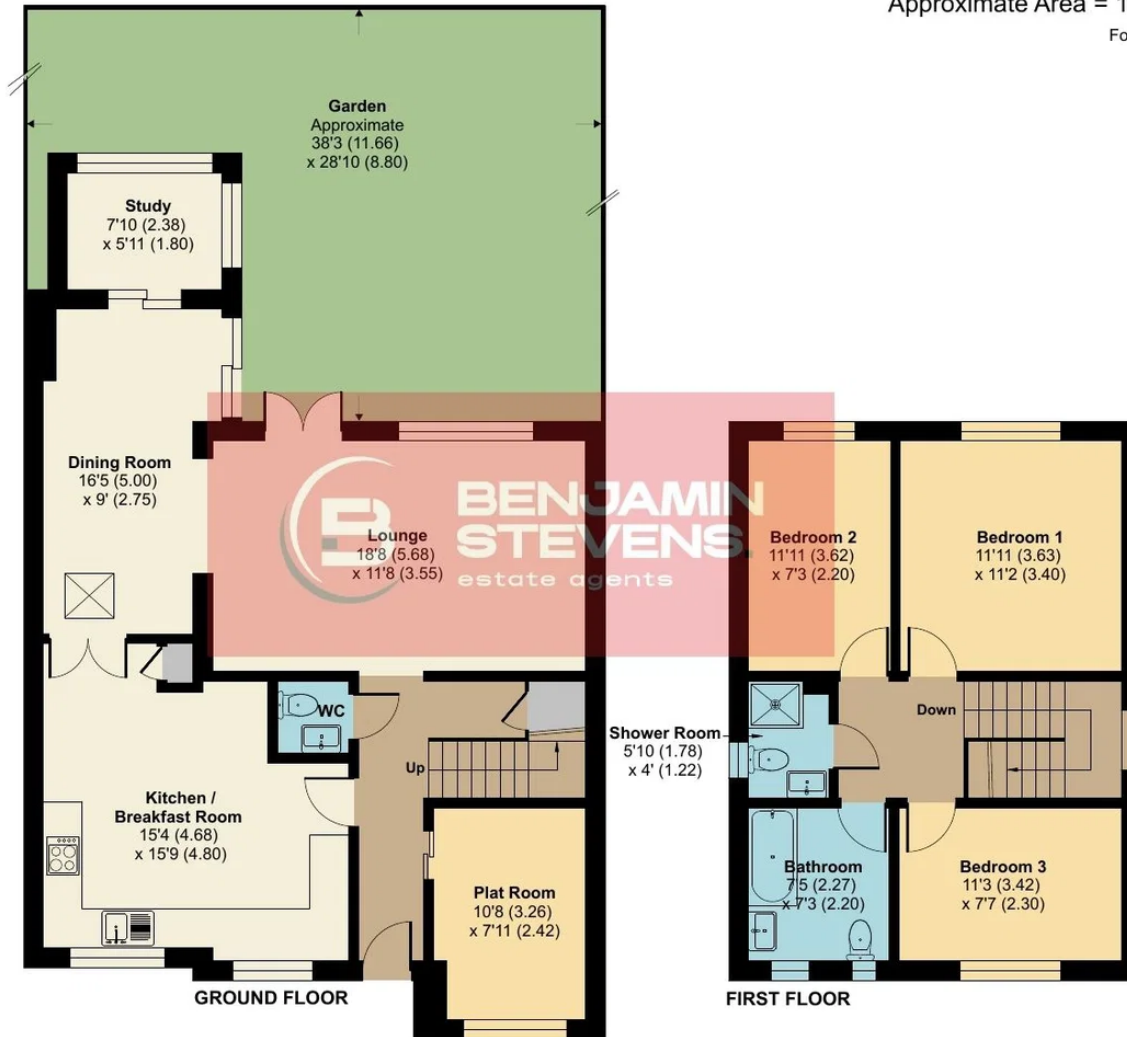

Floor plan produced in accordance with RICS Property Measurement 2nd Edition, Incorporating International Property Measurement Standards (IPMS2 Residential). © n̄cheom 2026. Produced for Benjamin Stevens. REF: 1465573