



Lower Tub, Bushey, WD23

Bushey



**BENJAMIN
STEVENS.**

estate agents

exp

£425,000

Bedrooms: 2

Bathrooms: 1

Receptions: 3

A bright and spacious TWO BEDROOM THREE RECEPTION ROOM DUPLEX APARTMENT WITH PRIVATE TERRACE forming part of this sought after purpose built block in the heart of Bushey, conveniently located and within walking distance to all local shopping and transport facilities. The property is in need of modernisation and benefits from: Replacement Double Glazed Windows, Gas Fired Heating To Radiators, Living Room, Family Room, Dining Room, Kitchen/Breakfast Room, Bathroom, Separate WC, Communal Grounds & Private Private Terrace, Double Garage, Communal Swimming Pool & Squash Court.

CHAIN FREE







Lower Tub, Bushey, WD23

Approximate Area = 1451 sq ft / 134.8 sq m

Garage = 254 sq ft / 23.5 sq m

Total = 1705 sq ft / 158.3 sq m

For identification only - Not to scale

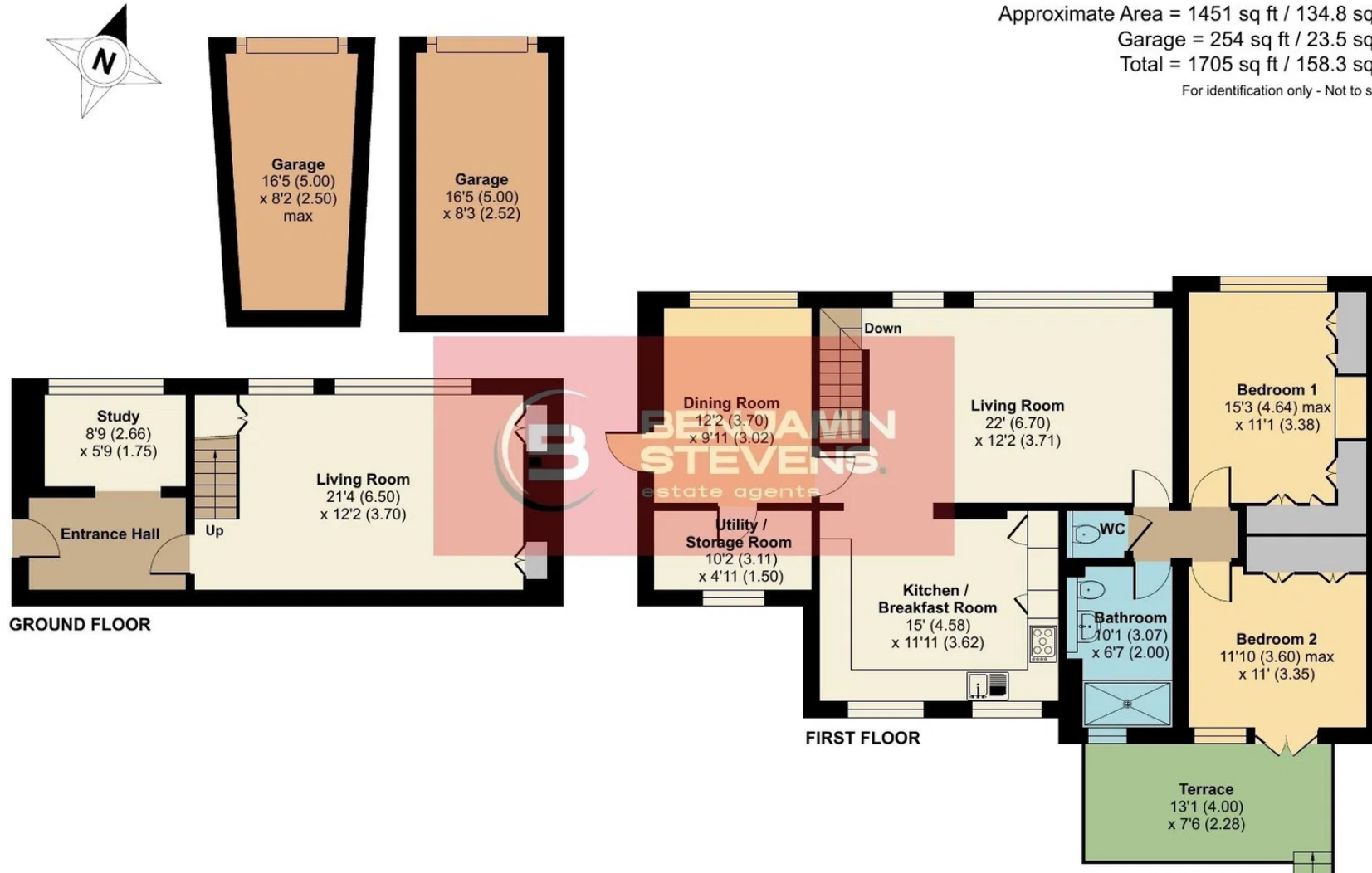

Floor plan produced in accordance with RICS Property Measurement 2nd Edition, Incorporating International Property Measurement Standards (IPMS2 Residential). © n̄che.com 2026. Produced for Benjamin Stevens. REF: 1456619

benjaminstevens.co.uk

Benjamin Stevens Estate Agents Limited Company Number 15143871 VAT number 464152108
Registered office: 194 Station Road, Edgware, England, HA8 7AT
Frederick George (Management Services) Ltd is an appointed representative of St Giles Insurance and Finance Services Limited which is authorised and regulated by the Financial Conduct Authority.

BUSHEY HEATH OFFICE

59 High Road, Bushey Heath, Herts, WD23 1EE

0208 950 7777