



Canons Court, Stonegrove, Edgware, HA8
Edgware



**BENJAMIN
STEVENS.**
estate agents **exp**

£300,000

Bedrooms: 2

Bathrooms: 1

Receptions: 1

A Two Double Bedroom First Floor Apartment, in the heart of Central Edgware within walking distance to local transport links/shops.

Accommodation comprises Two Double Bedrooms, Reception Room, Separate Kitchen and a Family Bathroom.

Features include a long lease of 146 years, off street parking (non-allocated) and communal gardens.

Ideal first time purchase, or buy to let investment.

Call Benjamin Stevens now to view!



FIRST FLOOR
527 sq.ft. (49.0 sq.m.) approx.

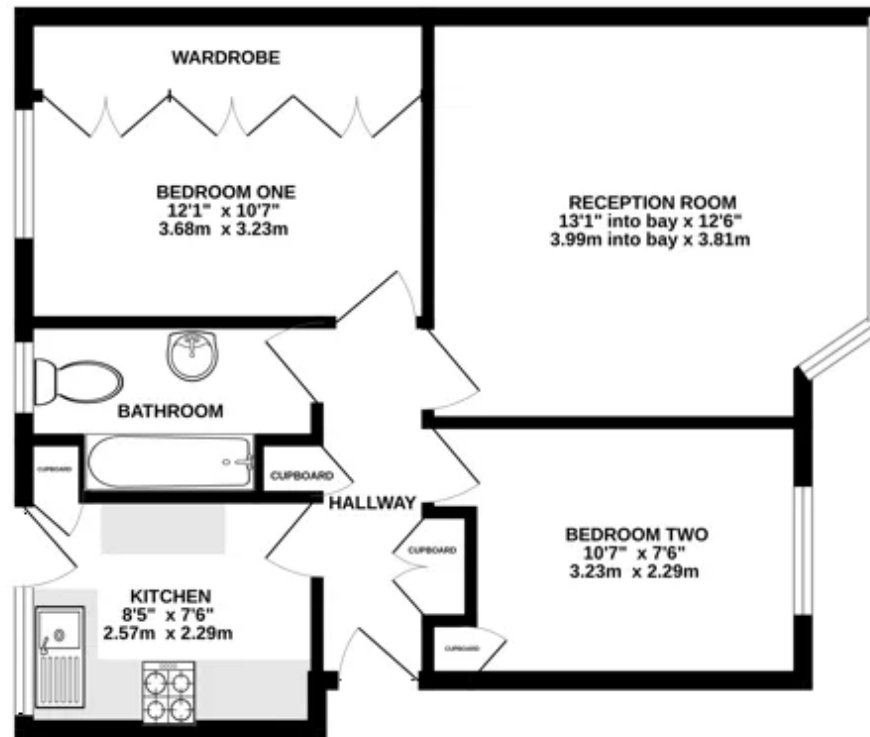

TOTAL FLOOR AREA: 527 sq ft. (49.0 sq m.) approx.
Whilst every attempt has been made to ensure the accuracy of the description contained here, measurements of doors, windows, rooms and any other items are approximate and no responsibility is taken for any error, omission or mis-statement. This plan is for illustrative purposes only and should be used as such by any prospective purchaser. The services, systems and appliances shown have not been tested and no guarantee is given as to their operability or efficiency until the date of completion of the works.
Made with AutoCAD 2014

benjaminstevens.co.uk

Benjamin Stevens Estate Agents Limited Company Number 15143871 VAT number 464152108
Registered office: 194 Station Road, Edgware, England, HA8 7AT
Frederick George (Management Services) Ltd is an appointed representative of St Giles Insurance and Finance Services Limited which is authorised and regulated by the Financial Conduct Authority.

EDGWARE OFFICE

194 Station Road, Edgware, Middlesex, HA8 7AT

020 8958 1118