



Wren Crescent, Bushey, WD23

Bushey

Offers Over
£675,000

Bedrooms: 3

Bathrooms: 1

Receptions: 2

An extended bright and spacious THREE BEDROOM, TWO RECEPTION ROOM SEMI DETACHED HOUSE situated on a sought after residential crescent in the heart of Bushey, conveniently located and within walking distance to all local shopping/transport facilities & places of worship. The property is in need of some modernisation and benefits from: Replacement Double Glazed Windows, Gas Fired Heating To Radiators, Guest Cloakroom, Lounge/Dining Room, Conservatory, Kitchen, Three Bedrooms, Bathroom, Rear Garden, Single Garage Approached Via Own Driveway With Off Street Parking.

CHAIN FREE









Wren Crescent, Bushey, WD23

Approximate Area = 1462 sq ft / 135.8 sq m

Garage = 144 sq ft / 13.3 sq m

Total = 1606 sq ft / 149.1 sq m

For identification only - Not to scale

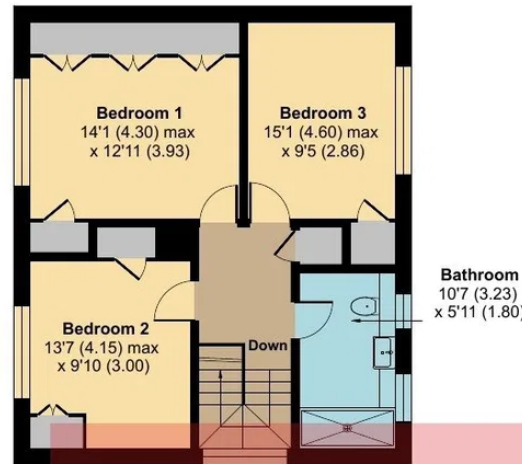

FIRST FLOOR

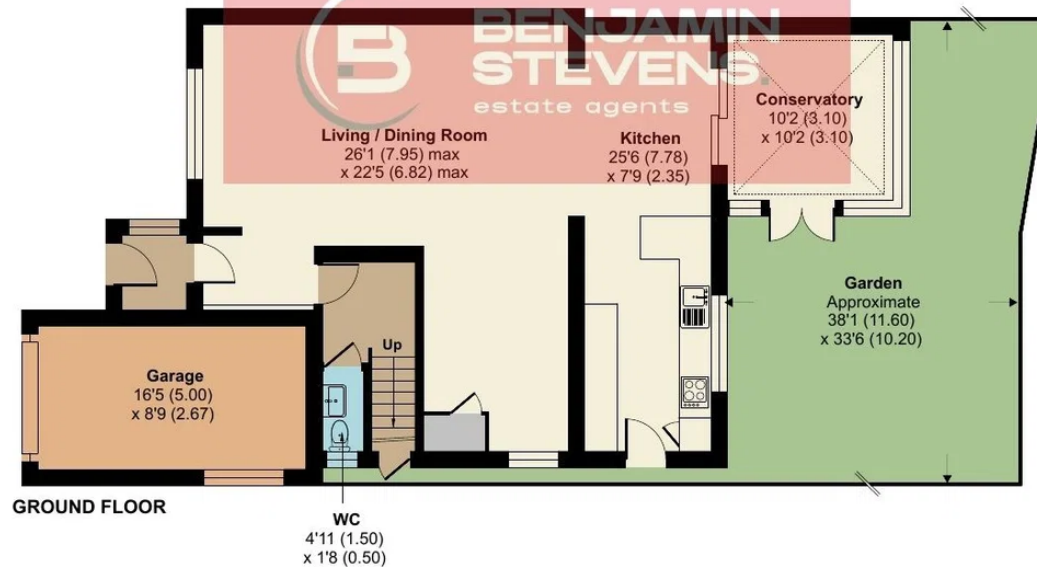

GROUND FLOOR



Floor plan produced in accordance with RICS Property Measurement 2nd Edition, Incorporating International Property Measurement Standards (IPMS2 Residential). © n1che.com 2026. Produced for Benjamin Stevens. REF: 1449774