

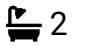

Zodiac Close, Edgware

Offers Over £350,000

 2  2  1



A Chain Free two double bedroom, two bathroom luxury apartment located 0.6 miles from Edgware tube station. The accommodation comprises a fully integrated kitchen which is open plan to the reception room, two double bedrooms, two bathrooms (one en-suite) one balcony and secure gated parking.

Key Features

- *Chain Free*
- Two Bathrooms (1 En-Suite)
- Secure Gated Parking
- Close to Edgware Tube Station
- Two Double Bedroom Flat
- Private Balcony
- Sole Agent
- Long 987 year lease

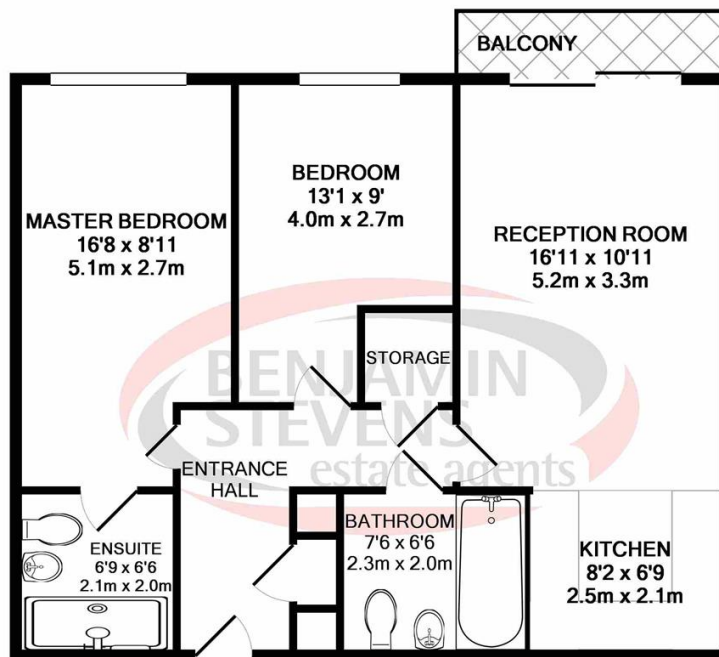

TOTAL APPROX. FLOOR AREA 674 SQ.FT. (62.6 SQ.M.)

Whilst every attempt has been made to ensure the accuracy of the floor plan contained here, measurements of doors, windows, rooms and any other items are approximate and no responsibility is taken for any error, omission, or mis-statement. This plan is for illustrative purposes only and should be used as such by any prospective purchaser. The services, systems and appliances shown have not been tested and no guarantee as to their operability or efficiency can be given
Made with Metropix ©2019