



Priory Field Drive, Edgware
Edgware

Offers Over
£325,000

Bedrooms: 2

Bathrooms: 1

Receptions: 1

A well-presented two-bedroom ground floor apartment, perfectly positioned within the desirable Priory Field Drive development. This home benefits from an allocated parking space, Lease in excess of 900 years, Service charges of £1536.83, Ground Rent of £451.73





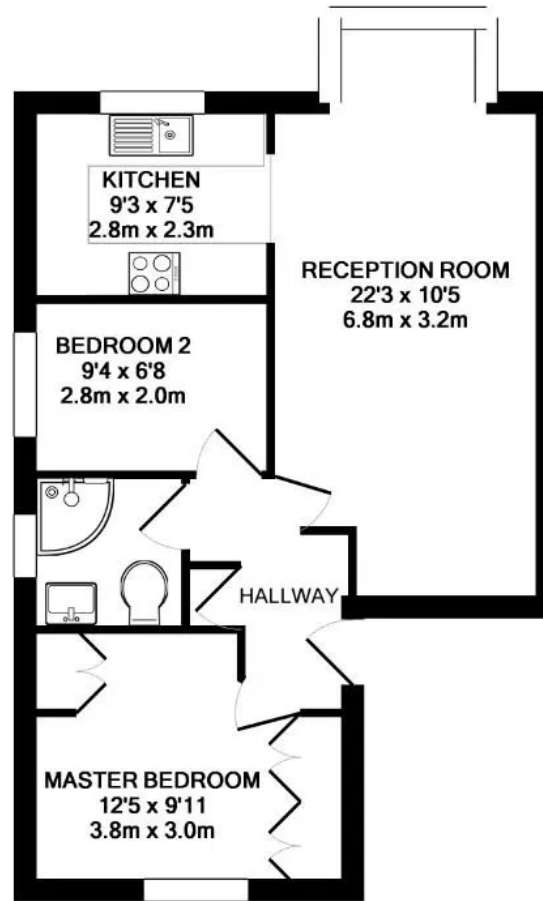

TOTAL APPROX. FLOOR AREA 527 SQ.FT. (49.0 SQ.M.)

Whilst every attempt has been made to ensure the accuracy of the floor plan contained here, measurements of doors, windows, rooms and any other items are approximate and no responsibility is taken for any error, omission, or mis-statement. This plan is for illustrative purposes only and should be used as such by any prospective purchaser. The services, systems and appliances shown have not been tested and no guarantee as to their operability or efficiency can be given.
Made with Metropix ©2018

Steve Wayne

194 Station Road, Edgware, HA8 7AT

0208 958 1118

steve@benjaminstevens.co.uk

<https://benjaminstevens.co.uk>