



25 Hammonds Lane, Billericay - CM11 2SZ

O.I.E.O £400,000 Freehold

This beautifully presented three-bedroom terraced house is ideally situated in a quiet mews location, offering a wonderful blend of comfort, convenience and style.

The outside space of this charming home is equally inviting. This delightful home truly offers the best of both indoor and outdoor living in a sought-after, family-friendly setting.

Council Tax band: C - EPC Energy Efficiency Rating: C



tyler estates

01277 626181

www.tylerestates.co.uk



Entrance Hall

Lounge

13' 7" x 10' 6" (4.13m x 3.20m)

Dining Area

8' 6" x 8' 11" (2.58m x 2.73m)

Kitchen

8' 6" x 8' 0" (2.58m x 2.44m)

Landing

Bedroom One

10' 4" x 10' 6" (3.15m x 3.20m)

Bedroom Two

12' 0" x 7' 5" (3.65m x 2.26m)

Bedroom Three

8' 8" x 9' 7" (2.64m x 2.92m)

Bathroom

8' 6" x 6' 6" (2.58m x 1.98m)



Ground Floor



First Floor

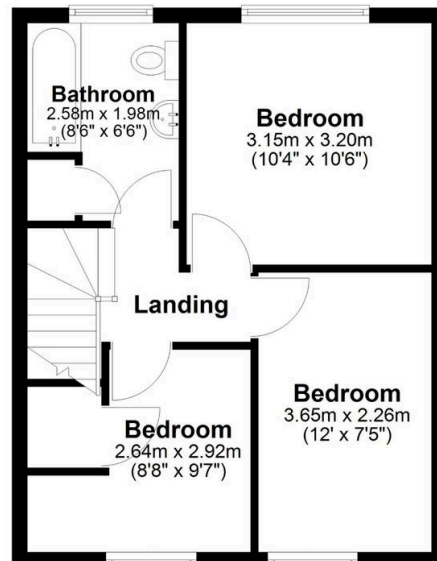
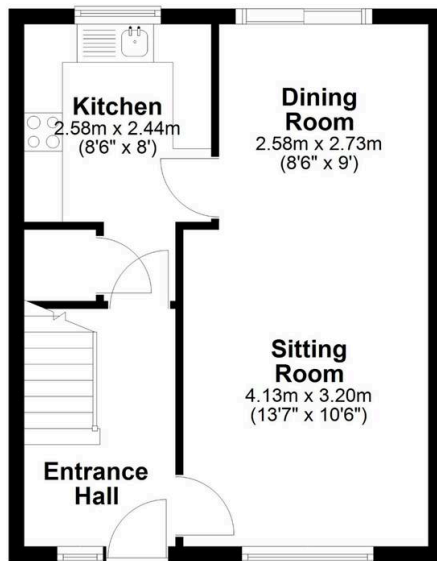

APPROX INTERNAL FLOOR AREA 72 SQ M (780 SQ FT)
This floorplan is for illustrative purposes only and is **NOT TO SCALE**
All measurements are approximate **NOT** to be used for valuation purposes
Copyright Tyler Estates 2026