



## Apt 2, Southwood Court Southend Road, Billericay - CM11 2RA

£185,000 Leasehold Council Tax band: D ~ EPC rating: B

This beautifully presented one bedroom ground floor apartment offers a wonderful opportunity to join a friendly community. Inviting bright living space, new carpets and professional decoration throughout, modern re-fitted kitchen with an integrated oven and hob, bedroom with fitted bi-fold mirrored wardrobes and bathroom adjacent fitted with walk-in shower. A large walk-in cupboard provides practical storage with Fischer modern heaters throughout with thermostatic control, and an upgraded water heating system for efficiency and peace of mind.



**tyler estates**

01277 626181

[www.tylerestates.co.uk](http://www.tylerestates.co.uk)



**Hallway**

**Lounge / Diner**

22' 9" x 10' 8" (6.94m x 3.26m)

**Kitchen**

8' 2" x 7' 9" (2.49m x 2.36m)

**Bedroom**

15' 9" x 9' 3" (4.80m x 2.82m)

**Bathroom**

6' 10" x 5' 8" (2.08m x 1.73m)

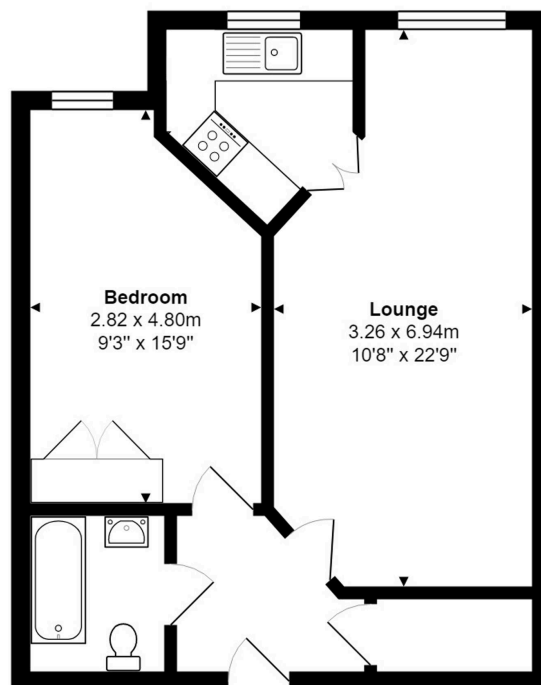

Total Area: 48.4 m<sup>2</sup> ... 521 ft<sup>2</sup>

Measurements are approximate for illustrative purposes only and may have been taken from the widest area

Floorplan Copyright Equinox Energy Performance Certificates  
[www.energyperformancecertificates.biz](http://www.energyperformancecertificates.biz)