



Enhanced with AI by STREET_5G



7 Bridgecote Lane, Noak Bridge - SS15 4BW

£165,000 Leasehold

Council Tax band: A~ EPC Energy Efficiency Rating: D

The property for over 55's, located in this attractive mock Tudor building, boasts a comfortable lounge/diner with its dual aspect windows and cosy gas fire, square kitchen with integrated hob and oven, convenient shower room alongside the bedroom adds to the modern appeal of this cosy apartment.



tyler estates

01277 626181

www.tylerestates.co.uk



Entrance Hall

Lounge/diner

19' 0" x 11' 6" (5.80m x 3.50m)

Kitchen

8' 10" x 7' 7" (2.70m x 2.30m)

Bedroom

19' 8" x 8' 2" (6.00m x 2.50m)

Bathroom

6' 11" x 5' 7" (2.10m x 1.70m)

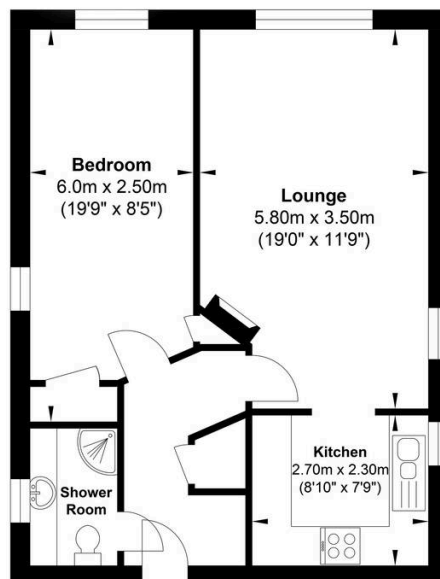

Gross Internal Floor Area : 51.0 m2 ... 548.95 ft2

Whilst every attempt has been made to ensure the accuracy of the floor plan contained here, measurements of doors, windows, rooms and any other items are approximate and no responsibility is taken for any error, omission, or mis-statement. This plan is for illustrative purposes only and should be used as such by any prospective purchaser. The services, systems and appliances shown have not been tested and no guarantee as to their operability or efficiency can be given.