



**BRADFORD
& HOWLEY**
HARPENDEN | MARSHALSWICK | ST ALBANS

Buckwood Road, Markyate, AL3 8JB
Asking Price £400,000

Situated within a popular village location, this attractive three-bedroom home offers well balanced accommodation, a practical layout and appealing outdoor space, all within easy reach of local amenities and schooling.

The ground floor has been thoughtfully arranged to suit modern living. A spacious living room provides a comfortable and inviting setting, ideal for both everyday relaxation and entertaining. This room benefits from good natural light, creating a welcoming atmosphere.

To the rear, the property features a kitchen and dining area overlooking the garden, forming a sociable and functional space at the heart of the home.

This layout works particularly well for family life, with a strong connection between indoor and outdoor areas, and offers ample room for dining as well as day-to-day use.

Upstairs, the property offers three well-proportioned bedrooms, providing flexible accommodation for families, guests or those working from home.

These are served by a stylish bathroom, finished in a contemporary manner and complementing the overall presentation of the home.

Externally, the property benefits from both front and rear gardens, offering space for relaxation, outdoor dining and gardening. The rear garden provides a pleasant extension of the living space during warmer months, while the front garden enhances the overall setting.

A further advantage is the driveway located to the rear, providing convenient off-street parking within this established residential area.

The location is particularly appealing, with the property within walking distance of local schools and the village high street, offering a range of shops, cafés and everyday amenities. This combination of convenience and community makes the home especially attractive for families.

Overall, this is a well located and practical home offering comfortable living space, outdoor areas and a desirable village setting.

Tenure: Freehold
Council Tax Band: D
EPC Rating: C









Ground Floor

Approx. 37.8 sq. metres (407.3 sq. feet)

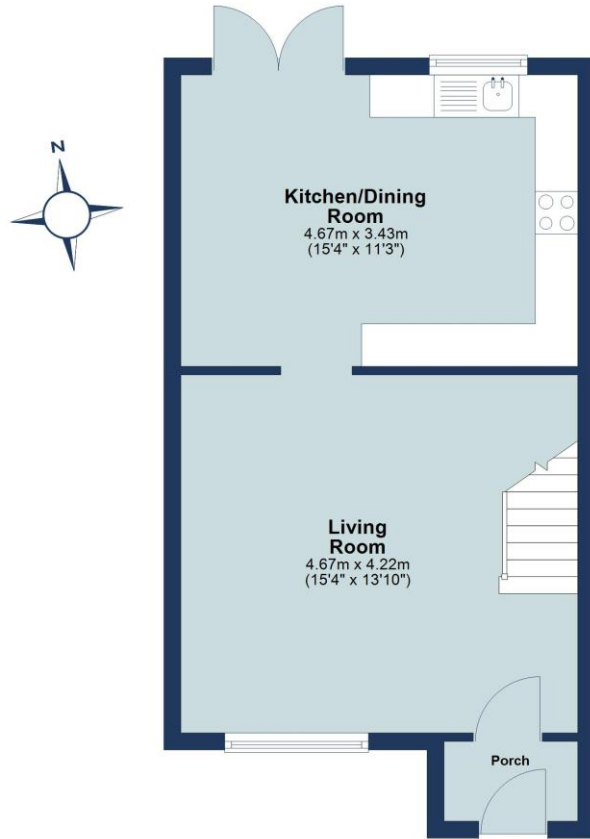

Kitchen/Dining Room
4.67m x 3.43m
(15'4" x 11'3")

Living Room
4.67m x 4.22m
(15'4" x 13'10")

Porch

First Floor

Approx. 36.2 sq. metres (389.6 sq. feet)

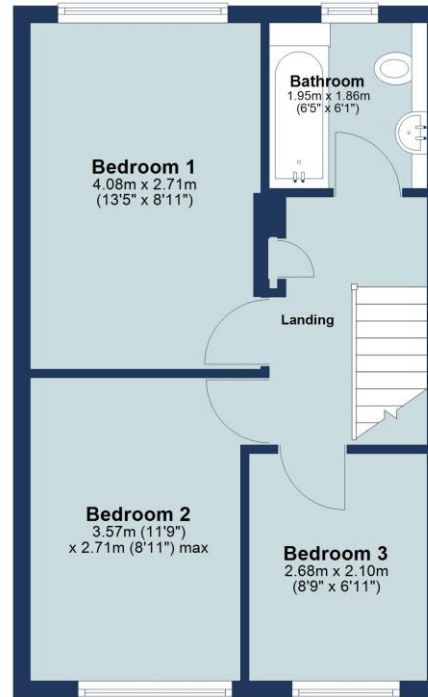

Bedroom 1
4.08m x 2.71m
(13'5" x 8'11")

Bedroom 2
3.57m (11'9")
x 2.71m (8'11") max

Bedroom 3
2.68m x 2.10m
(8'9" x 6'11")

Landing

Bathroom
1.95m x 1.86m
(6'5" x 6'1")

Total area: approx. 74.0 sq. metres (796.9 sq. feet)

Floor plan is for marketing purposes only and is to be used as a guide.
Plan produced using PlanUp.

IMPORTANT NOTICE: These particulars are for guidance only. Whilst every effort has been made to ensure the accuracy of the descriptions, plans, and measurements, these are not guaranteed, and they do not form part of any contract or tenancy. We have not tested any of the services, equipment, or fittings. No person in this firm's employment has the authority to make or give any representation or warranty in respect of the property. Interested parties should satisfy themselves as to the conditions of any such items considered material to their prospective purchase or tenancy and may wish to consult an independent advisor. It should not be assumed that any of the articles depicted in these particulars are included in the purchase or tenancy. You may download, store, and use the material for your personal use. You may not republish the material in any format without the consent of Bradford & Howley.

Looking to Sell or Let your
current home?



Scan me to request your FREE
Instant Online Valuation!

Fresh
FINANCIAL



Sign up for FREE mortgage monitoring today, giving you peace of mind you are on the right deal, every month.

We will compare your mortgage against thousands of deals and send you a monthly report.

Please note that mortgage monitoring does not constitute mortgage advice.

**BRADFORD
& HOWLEY**
HARPENDEN | MARSHALSWICK | ST ALBANS

f @bradfordandhowley
ig @bradfordandhowley
in @bradford-howley
yt @bradfordhowley4660

tel 01582 769966
envelope harpenden@bradfordandhowley.com
location 42 High Street, Harpenden, Herts, AL5 2SX