



**BRADFORD
& HOWLEY**
HARPENDEN | MARSHALSWICK | ST ALBANS

Hughenden Road, St. Albans, AL4 9QN
Asking Price £375,000

Available with no onward chain, this bright and spacious three double bedroom duplex maisonette offers well-proportioned accommodation throughout.

The property features an entrance hall, a generously sized modern fully fitted integrated kitchen, to include fridge freezer, dishwasher and washing machine and providing space for a dining table and chairs.

To the rear of the property is a generous living space with ample room for both relaxing and dining, featuring a door opening onto a balcony, an open fireplace with gas-fired living flame fire, as well as a practical storage cupboard.

The first floor provides three well-proportioned double bedrooms, each offering comfortable space for a variety of furniture layouts, making them ideal for families, guests, or even a home office setup.

The principal bedroom is particularly spacious with fully fitted wardrobes, while the remaining two bedrooms are also of a good size and benefit from plenty of natural light. The family bathroom is fitted with a suite comprising bath with electric shower over, wash hand basin, and WC, serving all three bedrooms conveniently.

There is also additional storage available on this level, helping to keep the living space organised and clutter-free. The upstairs space can be reconfigured to suit your needs.

Externally, the property benefits from a convenient storage cupboard located by the front door ideal for housing a tumble dryer or for additional storage to help keep living space

clutter free, along with a separate outbuilding perfect for storing bikes or equipment and a garage with the option to park either inside or directly in front.

There are well tended communal gardens surrounding the property.

Hughenden Road is ideally positioned just a short walk from The Quadrant shopping parade, which offers a variety of amenities including bakeries and Marks & Spencer. The property is also close to highly regarded schools such as Skyswood (approximately 320 metres) and Sandringham School (approximately 665 metres).

St Albans city centre and mainline station are within easy reach, providing a wider selection of shopping and leisure facilities, as well as excellent transport links. Frequent bus services run along The Ridgeway, offering convenient access into the town centre.

Tenure: Leasehold
Term of Lease: 189 Years From June 1978
Service Charge: £1,280pa for 2026
Ground Rent: £0
Council Tax Band: C
EPC Rating: C









Ground Floor

Approx. 41.0 sq. metres (441.7 sq. feet)
(excluding Terrace)

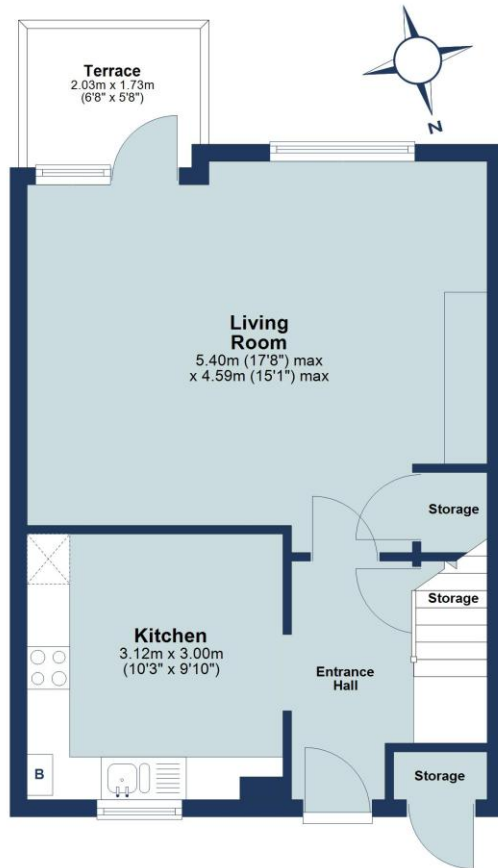

First Floor

Approx. 40.3 sq. metres (433.9 sq. feet)

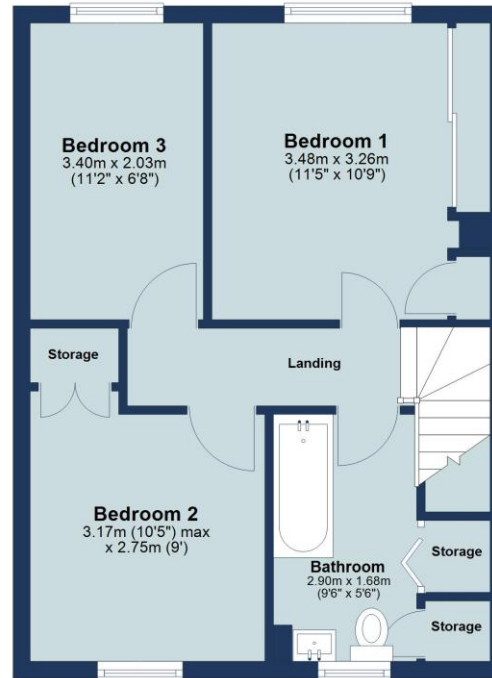

Total area: approx. 81.4 sq. metres (875.7 sq. feet)

Floor plan is for marketing purposes only and is to be used as a guide.
Plan produced using PlanUp.

IMPORTANT NOTICE: These particulars are for guidance only. Whilst every effort has been made to ensure the accuracy of the descriptions, plans, and measurements, these are not guaranteed, and they do not form part of any contract or tenancy. We have not tested any of the services, equipment, or fittings. No person in this firm's employment has the authority to make or give any representation or warranty in respect of the property. Interested parties should satisfy themselves as to the conditions of any such items considered material to their prospective purchase or tenancy and may wish to consult an independent advisor. It should not be assumed that any of the articles depicted in these particulars are included in the purchase or tenancy. You may download, store, and use the material for your personal use. You may not republish the material in any format without the consent of Bradford & Howley.

Looking to Sell or Let your
current home?



Scan me to request your FREE
Instant Online Valuation!

Fresh
FINANCIAL



Sign up for FREE mortgage monitoring today, giving you peace of mind you are on the right deal, every month.

We will compare your mortgage against thousands of deals and send you a monthly report.

Please note that mortgage monitoring does not constitute mortgage advice.

**BRADFORD
& HOWLEY**
HARPENDEN | MARSHALSWICK | ST ALBANS

f @bradfordandhowley
@ @bradfordandhowley
in @bradford-howley
▶ @bradfordhowley4660

☎ 01727 856999
✉ marshalswick@bradfordandhowley.com
📍 5 The Quadrant, Marshalswick, St Albans, Herts, AL4 9RA